



**Equipped with AEM® Dryflow™ Filter
No Oil Required!**

INSTALLATION INSTRUCTIONS

PART NUMBER:

21-724C

(Gun Metal Grey Finish)

21-724P

(Vacuum Metalized Chrome - VMC)

2013-2014	Hyundai	Veloster Turbo	1.6L	C.A.R.B. #D-670-21
2015-2016	Hyundai	Veloster Turbo	1.6L	

Some intake systems are not legal for sale or use on any pollution controlled motor vehicle in California or states adopting CA emission procedures. See AEMIntakes.com for CARB status on each part for a specific vehicle.

ITEM NO.	PART NUMBER	DESCRIPTION	QTY.
A	2-1498C/P	UPPER TUBE, 2013 HYUNDAI VELOSTER TURBO	1
B	5-275	HOSE, SILICONE 2.75X3" BLK	2
C	9444	HOSE CLAMP, 2.31-3.25"	4
D	2-1499C/P	LOWER TUBE, 2013 HYUNDAI VELOSTER TURBO	1
E	21-2157DK	AIR FILTER 2-3/4" FLG, 5-1/2"B, 4-3/4T DRYFLOW	1
F	9448	1/2" BNDHOSE CLAMP, 2.56"-3.50"	1
G	08160	WASHER; 1"D X 1/4 HOLE FENDER	2
H	444.460.04	NUT, M6 HEX SERRATED	2
I	1228599	MOUNT, RUBBER 1" X 6MM	2

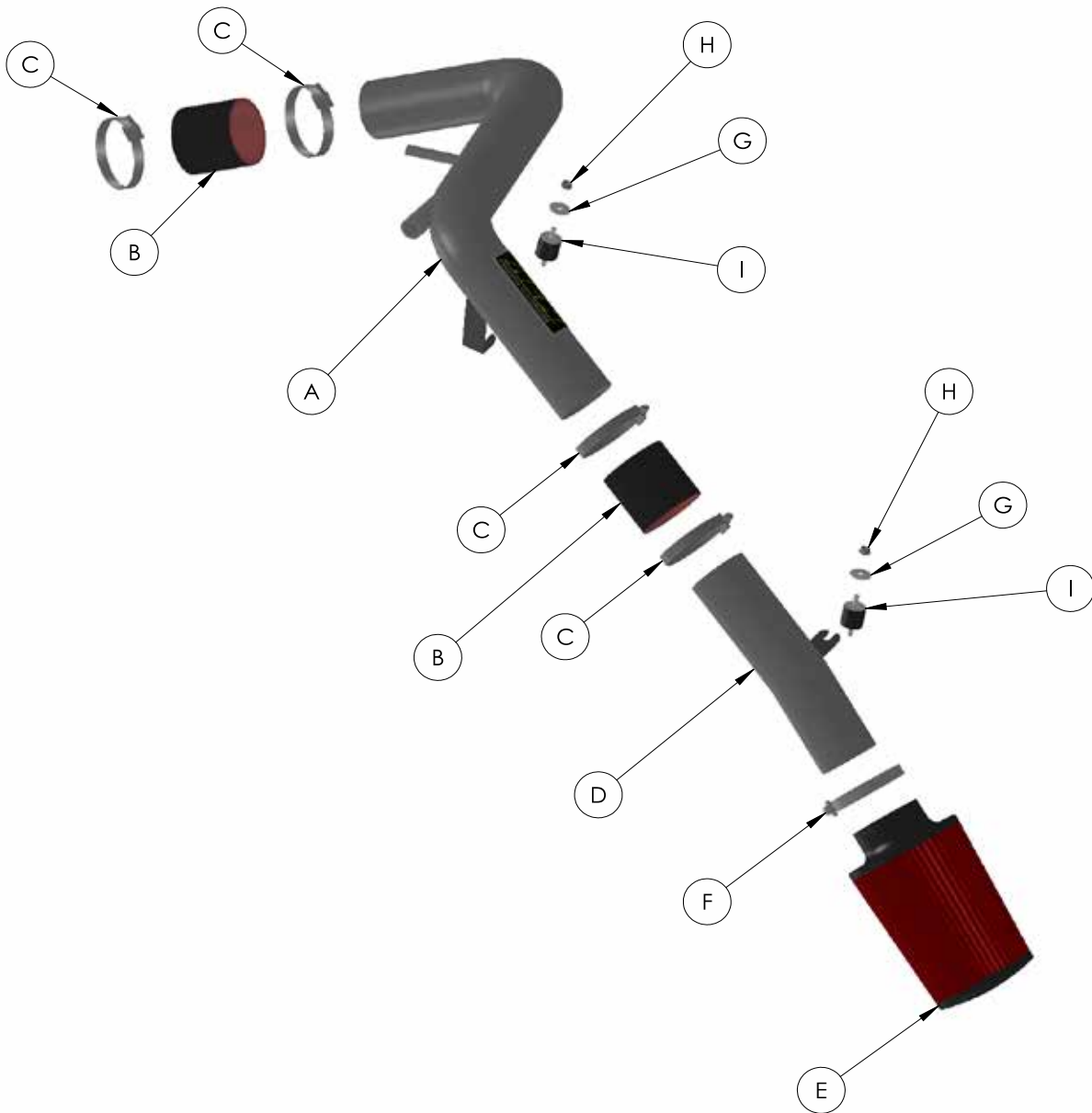

Read and understand these instructions BEFORE attempting to install this product. Failure to follow installation instructions and not using the provided hardware may damage the intake tube, throttle body and engine.

1. Preparing Vehicle

- a. Make sure vehicle is parked on a level surface.
- b. Set parking brake.
- c. If engine has run in the past two hours, let it cool down.
- d. Disconnect negative battery terminal.
- e. Raise the front of the vehicle with a jack. Refer to your owner's manual for proper jack and jack stand placement to properly support vehicle.
- f. Do not discard stock components after removal of the factory system.

2. Removal of Stock System



a. Stock intake system. Remove the engine cover by grasping firmly on lower end and carefully lifting up.



b. Loosen spring clamps to detach crank case breather hose and recirculating valve hose from intake tube.



c. Loosen the stock hose clamp on turbo inlet using a 10mm socket and ratchet.



d. Remove the two plastic clips shown above and pull up on the air inlet snorkel to remove.



e. Remove the three M6 bolts securing the stock airbox



f. Firmly grasp the airbox and slide it towards the engine to detach from lower chamber. Remove stock intake airbox and tube assembly.



g. With the vehicle raised, remove the three plastic clips in the driver side front wheel well as indicated above.



h. Remove the two plastic clips under vehicle, near driver's side front wheel to lower plastic wheel well liner.



i. Remove four silver M6 bolts securing lower plastic belly pan cover.



j. From driver's side wheel well, remove the M6 bolt used to secure the intake resonator chamber rear mount.



k. From underneath vehicle, remove the remaining two M6 bolts securing the lower intake resonator.



l. Carefully lower the intake resonator and disconnect the tree mount clip to detach the foglight harness. Set aside resonator chamber.

3. Installation of AEM® Intake System

- a. When installing the intake system, do not completely tighten the hose clamps or mounting hardware until instructed to do so.



- b. Install the two rubber mounts(I) provided into the previous mounting location of the stock airbox as indicated.



- c. Slide coupler(B) over turbo inlet with two hose clamps(C). Insert tube(A) into coupler and position bracket into rubber mount as shown, leaving clearance between tube and brake fluid reservoir and positive battery terminal.



- d. Slide provided coupler(B) over non-stamped end of lower pipe(D) along with two hose clamps(C). Slide stamped end of tube down below driver side headlight housing and position mounting bracket into second rubber mount. Slide coupler evenly between upper and lower tubes. Ensure proper clearance between tube and headlight housing.



- e. From the driver's side wheel well, install filter(E) onto lower pipe and secure with provided hose clamp(F).



f. Use the provided hex nuts(H) and washers(G) to loosely fasten upper and lower tubes to the rubber mounts previously installed.



g. Check for clearance around filter between fog light housing and also plastic liner. Adjust the position of the lower tube if necessary. Tighten hex nuts(H) and hose clamps(C) once filter is properly positioned. Reinstall lower belly pan cover and plastic well liner.



h. Reconnect crank case breather hose and recirculation valve hose to upper tube(A) and fasten using stock spring clamps as shown.



i. AEM cold air intake system installed.

4. Reassemble Vehicle

- a. Position the inlet pipes for the best fitment. Be sure that the pipes or any other components do not contact any part of the vehicle. Tighten the rubber mount, all bolts, and hose clamps.
- b. Check for proper hood clearance. Re-adjust pipes if necessary and re-tighten them.
- c. Inspect the engine bay for any loose tools and check that all fasteners that were removed are properly tightened.
- d. Reconnect the negative battery terminal and start the engine. Let the vehicle idle for 3 minutes. Perform a final inspection before driving the vehicle.

5. CARB Sticker Placement

- a. The C.A.R.B. exemption sticker, if applicable, must be visible under the hood so that an emissions inspector can find it when the vehicle is required to be tested for emissions. California requires testing every two years, other states may vary.

6. Service and Maintenance

- a. AEM Induction Systems requires cleaning the intake system's air filter element every 100,000 miles. When used in dusty or off-road environments, our filters will require cleaning more often. We recommend that you visually inspect your filter once every 25,000 miles to determine if the screen is still visible. When the screen is no longer visible some place on the filter element, it is time to clean it. To clean, purchase our Synthetic air filter cleaner, part number 1-1000 and follow the easy instructions.
- b. Use window cleaner to clean your AEM® intake tube. **(NOTE: DO NOT USE aluminum polish on powder coated AEM intake tubes).**

For technical inquiries
e-mail us at
sales@aemintakes.com
or
call us at
(800) 992-3000

AEM Air Intake System Warranty Policy

AEM® warrants that its intake systems will last the life of your vehicle. AEM will not honor this warranty due to mechanical damage (i.e. improper installation or fitment), damage from misuse, accidents or flying debris. AEM will not warrant its powder coating if the finish has been cleaned with a hydrocarbon-based solvent. The powder coating should only be cleaned with a mild soap and water solution. Proof of purchase of both the vehicle and AEM intake system is required for redemption of a warranty claim.

This warranty is limited to the repair or replacement of the AEM part. In no event shall this warranty exceed the original purchase price of the AEM part nor shall AEM be responsible for special, incidental or consequential damages or cost incurred due to the failure of this product. Warranty claims to AEM must be transportation prepaid and accompanied with dated proof of purchase. This warranty applies only to the original purchaser of product and is nontransferable. Improper use or installation, use for racing, accident, abuse unauthorized repairs or alterations voids this warranty. AEM disclaims any liability for consequential damages due to breach of any written or implied warranty of all products manufactured by AEM. Warranty returns will only be accepted by AEM when accompanied by a valid Return Merchandise Authorization (RMA) number. Credit for defective products will be issued pending inspection. Product must be received by AEM within 20 days of the date RMA is issued.

If you have a warranty issue, please call (800) 992-3000 and our customer service department will assist you. A proof of purchase is required for all AEM warranty claims.

Some intake systems are not legal for sale or use on any pollution controlled motor vehicle in California or states adopting CA emission procedures. See AEMIntakes.com for CARB status on each part for a specific vehicle.