



Equipped with AEM® Dryflow™ Filter
No Oil Required!

INSTALLATION INSTRUCTIONS

PART NUMBER:

21-733C (Gun Metal Gray Finish)

| | | | |
|-----------|------------|--------|---------|
| 2011-2013 | Volkswagen | Jetta | L5 2.5L |
| 2012-2014 | Volkswagen | Beetle | L5 2.5L |
| 2011-2014 | Volkswagen | Golf | L5 2.5L |
| 2012-2014 | Volkswagen | Passat | L5 2.5L |

Not legal for sale or use on any pollution controlled motor vehicle in California or states adopting California emission procedures. See AEMIntakes.com for CARB status on each part for a specific vehicle.

| ITEM NO. | PART NUMBER | DESCRIPTION | QTY. |
|----------|-------------|-----------------------------------------|------|
| 1 | 8-3034 | RUBBER EDGE TRIM 34" | 1 |
| 2 | 1-1016 | BOLT; HEX/FLANGE M6-1 X 30 | 1 |
| 3 | 08275 | WASHER; 1/4"ID X 5/8"OD - SAE | 1 |
| 4 | 32-3094 | BRACKET; HEAT SHIELD; VOLKSWAGEN 2.5L | 1 |
| 5 | 444.460.04 | NUT; M6 HEX SERRATED | 2 |
| 6 | 07849 | SPACER; .625"OD X .375"ID X .625"L,ZN | 1 |
| 7 | 5-302 | HOSE, SILICONE 3.00X2" BLACK | 1 |
| 8 | 9444 | HOSE CLAMP, 2.31-3.25" | 2 |
| 9 | 2-1450C | INTAKE TUBE; VOLKSWAGEN 2.5L; GM | 1 |
| 10 | 9452 | 1/2" BNDHOSE CLAMP,2.90"-3.75" | 1 |
| 11 | 21-203DOSK | ELEMENT PARTS KIT OFFSET 3"X5" DRY | 1 |
| 12 | 08160 | WASHER; 1"D X 1/4 HOLE FENDER | 1 |
| 13 | 1-112 | BOLT; BUTTON HEAD M6-1.0 X 10MM | 2 |
| 14 | 1-3018 | WASHER, M6 x 12MM OD ZINC | 2 |
| 15 | 1228596 | MOUNT, RUBBER M6 X 3/4" TALL M/F | 1 |
| 16 | 102488 | EDGE TRIM; 3/4" BULB, TOP LOC, 26"L | 1 |
| 17 | 20-8528 | HEAT SHIELD; VOLKSWAGEN 2.5L; TB/PC | 1 |
| 18 | 8-209 | CAP; VINYL 3.280"OD X 3.125"ID X 1.00"L | 1 |
| 19 | 8-169 | CAP; 1.250" ID X 1" L | 1 |

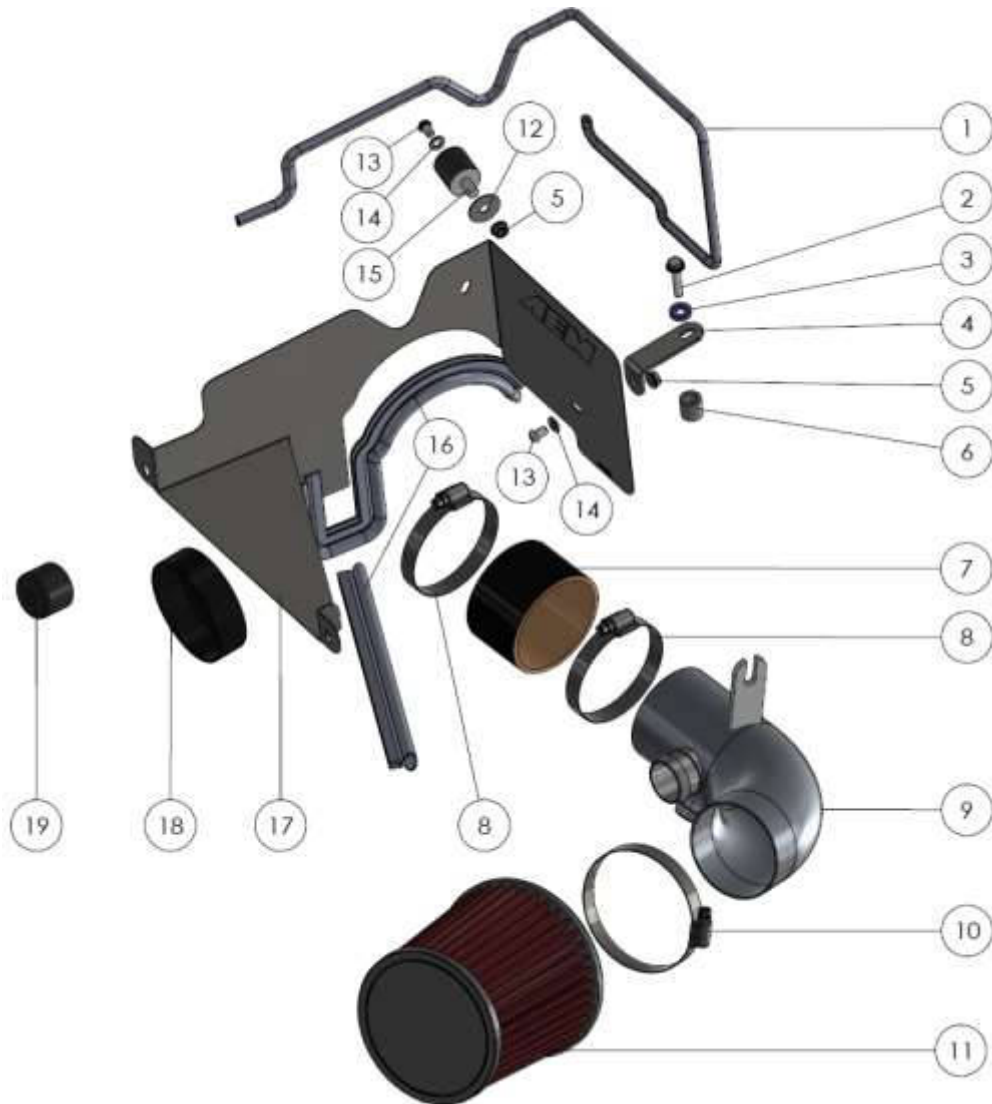

Read and understand these instructions **BEFORE** attempting to install this product. Failure to follow installation instructions and not using the provided hardware may damage the intake tube, throttle body and engine. If you need any assistance please call 1-800-858-3333 to speak with a representative in our Customer Service Center before returning the product.

1. Preparing Vehicle

- a. Make sure vehicle is parked on level surface.
- b. Set the parking brake.
- c. If engine has run in the past two hours, let it cool down.
- d. Disconnect negative battery terminal.
- e. Do not discard stock components after removal of the factory system.
- f. Open the air intake kit package and make sure all parts are included.

Tools Needed:

T-20 Torx

(Locking) Pliers

10mm socket

Socket driver

2. Removal of stock system



a) With a T-20 Torx, remove the two bolts securing the stock air scoop to the front support. These bolts will be reused.



b) Release the pressure clamp at the engine cover outlet as shown and disconnect the stock intake hose from the engine cover.



c) Remove the engine cover from the vehicle.
Note: Pull up on the back corners of the cover first then the front two.



d) Detach both of the air injection connectors by squeezing the knurled area and pulling away from the stock intake tube. **Note: Some models have only one vent.**



e) Release the pressure on the clamp at the throttle body and remove the stock intake tube. **Note: Do not discard any of your stock intake.**

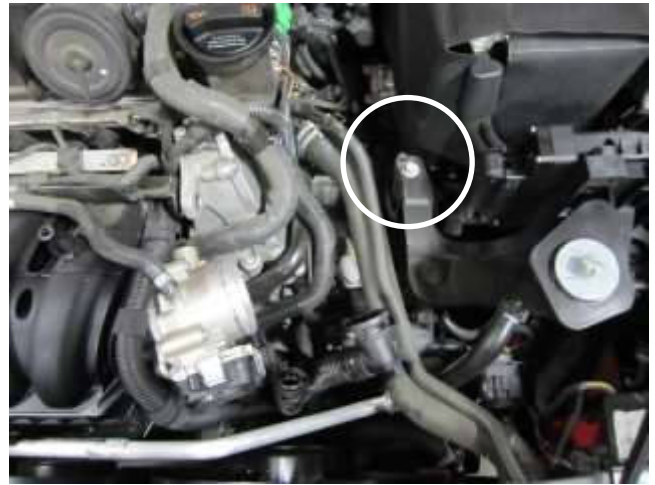

f) Remove the bolt shown. This bolt will not be re-used.

3. Installation of AEM® intake system.

- a. When installing the intake system, do not completely tighten the hose clamps or mounting hardware until instructed to do so.



a) Install the upper edge trim (8-3034) onto the top of the heat shield. Then install the lower edge trim (102488) onto the bottom of the heat shield as shown. **Note: Cut edge trim to fit.**



b) Install the bracket (32-3094) onto the backside of the heat shield and secure with provided hardware (1-112 & 1-3018 & 444.460.04). Then install the mount onto the side of the heat shield using (1-112 & 1-3018 & 1228596).



c) Install the hose and hose clamps onto the throttle body. Tighten the hose clamp closest to the throttle body at this time.



d) Install the assembled heat shield into the engine compartment and re-install the bolts removed in 2a to secure the heat shield to the front support.



e) Using the supplied hardware, install the bolt, washer and spacer (1-1016 & 08275 & 07849) to attach the bracket to the post where the bolt was removed in 2f.



f) Before installing the tube into the hose at the throttle body, make sure to connect the lower (smaller) air injection connector onto the AEM tube. **Note: Using warm soapy water on the O-ring (located in the connector) will help ease the connector onto the tube fitting. For models that do not have the larger connector, use the supplied cap to cap off the vent on the intake tube.**



g) Once the lower air injection connectors is properly attached slide the AEM tube into the hose at the throttle body and align the bracket with the mount on the heat shield.



h) Install and tighten the washer and nut onto the mount (08160 & 444.460.04). Then make sure the AEM tube is fully seated in the hose on the throttle body and tighten the hose clamp.



i) Connect the upper (larger) air injection connector onto the AEM tube. **Note: Using warm soap and water on the O-ring (located in the connector) will help ease the connector onto the tube fit-**

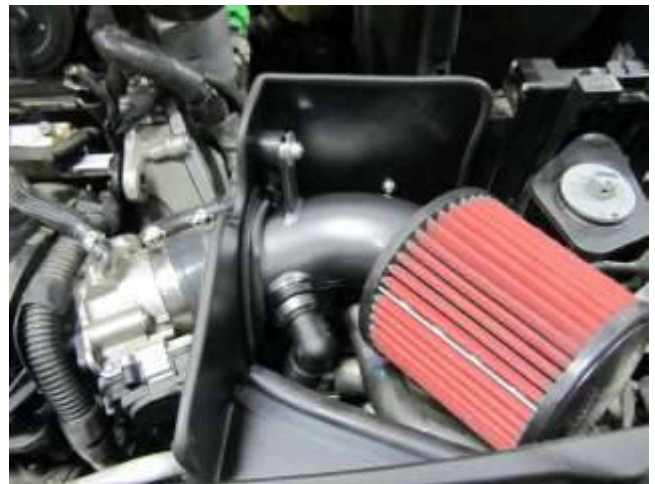

j) Install and tighten the air filter and hose clamp (9452) onto the AEM intake tube. **Note: Rotate the filter for best clearance, so it does not make contact with anything in the engine compartment.**



k) Install the cap (8-209) onto the engine cover and secure with the pressure clamp that was released in 2b.



l) Re-install the engine cover onto the engine and push down to secure it.



Factory air box system installed



AEM® intake system installed

4. Reassemble Vehicle

- a. Position the inlet pipes for the best fitment. Be sure that the pipes or any other components do not contact any part of the vehicle.
- b. Check for proper hood clearance. Re-adjust pipes if necessary and re-tighten them.
- c. Inspect the engine bay for any loose tools and check that all fasteners that were moved or removed are properly tightened.
- d. Reconnect negative battery terminal and start engine. Let the vehicle idle for 3 minutes. Perform a final inspection before driving the vehicle.

5. Service and Maintenance

- a. AEM Induction Systems requires cleaning the intake system's air filter element every 100,000 miles. When used in dusty or off-road environments, our filters will require cleaning more often. We recommend that you visually inspect your filter once every 25,000 miles to determine if the screen is still visible. When the screen is no longer visible some place on the filter element, it is time to clean it. To clean, purchase our Synthetic air filter cleaner, part number 99-0624 and follow the easy instructions.
- b. Use window cleaner to clean your powder coated AEM[®] intake tube.

NOTE: DO NOT USE aluminum polish on powder coated AEM[®] intake tubes.

For technical inquiries
e-mail us at
sales@aemintakes.com
or
call us at
800.992.3000

AEM Air Intake System Warranty Policy

AEM[®] warrants that its intake systems will last for the life of your vehicle. AEM[®] will not honor this warranty due to mechanical damage (i.e. improper installation or fitment), damage from misuse, accidents or flying debris. AEM[®] will not warrant its powder coating if the finish has been cleaned with a hydrocarbon-based solvent. The powder coating should only be cleaned with a mild soap and water solution. Proof of purchase of both the vehicle and AEM[®] intake system is required for redemption of a warranty claim.

This warranty is limited to the repair or replacement of the AEM[®] part. In no event shall this warranty exceed the original purchase price of the AEM[®] part nor shall AEM[®] be responsible for special, incidental or consequential damages or cost incurred due to the failure of this product. Warranty claims to AEM[®] must be transportation prepaid and accompanied with dated proof of purchase. This warranty applies only to the original purchaser of product and is nontransferable. Improper use or installation, use for racing, accident, abuse, unauthorized repairs or alterations voids this warranty. AEM[®] disclaims any liability for consequential damages due to breach of any written or implied warranty on all products manufactured by AEM[®]. Warranty returns will only be accepted by AEM[®] when accompanied by a valid Return Merchandise Authorization (RMA) number. Credit for defective products will be issued pending inspection. Product must be received by AEM[®] within 30 days of the date RMA is issued.

If you have a warranty issue, please call (800) 992-3000 and our customer service department will assist you. A proof of purchase is required for all AEM[®] warranty claims.

Not legal for sale or use on any pollution controlled motor vehicle in California or states adopting California emission procedures. See AEMIntakes.com for CARB status on each part for a specific vehicle.