



Equipped with AEM® Dryflow™ Filter
No Oil Required!

INSTALLATION INSTRUCTIONS

PART NUMBER

21-764C (Gun Metal Gray Finish)

<u>YEAR</u>	<u>MAKE</u>	<u>MODEL</u>	<u>ENGINE SIZE</u>
2014-2017	VW	JETTA	1.8 TSI
2014-2017	VW	JETTA GLI	2.0 TSI
2014-2017	VW	PASSAT	1.8 TSI

Not legal for sale or use on any pollution controlled motor vehicle in California or states adopting California emission procedures. See AEMIntakes.com for CARB status on each part for a specific vehicle.

TEM NO.	PART NUMBER	DESCRIPTION	QTY.
1	2-1543C	TUBE; 3.25" X 41"L, AL, VW JETTA	1
2	20-8559	HEAT SHIELD; 2010-2014 VW SPORTWAGEN TDI	1
3	21-2113D-HK	AIR FILTER	1
4	102470	EDGE TRIM; 3/4 BULB, TOP LOC, 57"L	1
5	084050	STEP HOSE	1
6	088012	1-1/8"OD QUICK CONNECT ADAPTER	1
7	08620K	1/2" BANDHOSE CLAMP,3.15"-4.00"	2
8	08554K	1/2" BANDHOSE CLAMP,2.15-3.00"	1
9	784645	GROMMET, PCV 3/4" ID 1-3/8" OD	2
10	1228596	MOUNT, RUBBER M6 X 3/4" TALL M/F	1
11	1-2110	BOLT; HEX/FLANGE M6-1.0 X 12	1
12	08160	WASHER; 1"D X 1/4 HOLE FENDER	1
13	8-215	PLUG; BLIND QUICK	1

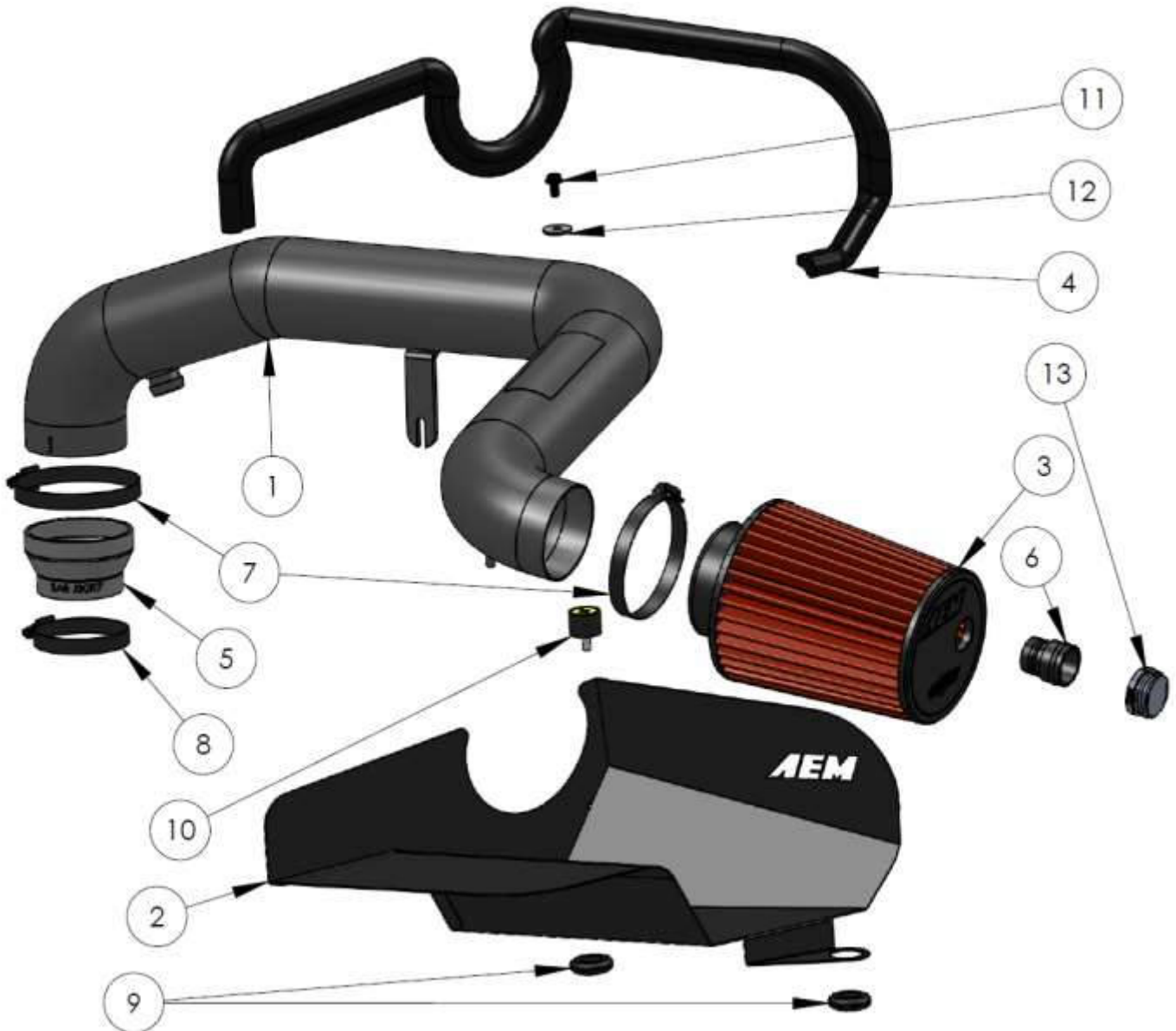

Read and understand these instructions **BEFORE** attempting to install this product. Failure to follow installation instructions and not using the provided hardware may damage the intake tube, throttle body and engine.

1. Preparing Vehicle

- a. Make sure vehicle is parked on level surface.
- b. Set the parking brake.
- c. If engine has run in the past two hours, let it cool down.
- d. Disconnect negative battery terminal.
- e. Do not discard stock components after removal of the factory system.
- f. Open the air intake kit package and make sure all parts are included.

Tools Needed:

8mm Socket

10mm Socket

T30 Bit

Socket Driver

Large Needle-Nose Pliers or
spring clamp removal tool

2. Removal of stock system



a. Prepare the airbox to be removed by fully loosening the bolt next to the battery, pulling off the hose on the left and disengaging the retained hose on the front and the airbox inlet duct.



b. Disengage the spring clamp retaining the coupler on the turbo inlet.



c. Remove the bolt behind the engine securing the factory intake hose to the engine. Lift out the hose and the airbox assembly after pulling the PCV hose near the turbo inlet off.



d. Remove the remaining duct components by removing the Torx screws indicated in the photo above.

3. Installation of AEM® intake system.

- a. When installing the intake system, do not completely tighten the hose clamps or mounting hardware until instructed to do so.



a. Assemble the heat shield according to the diagram on pg2 and install with rubber mount. Lube grommets with glass cleaner if needed to squeeze grommets onto posts.



b. Install the turbo-end coupler and both corresponding hose clamps onto the turbo.



c. Rotate the end of the PCV hose & push it straight in to the corresponding port on the bottom of your new intake tube until fully engaged, then install the tube into the turbo-end coupler. Do not tighten clamps yet.



d. Attach the small vacuum hose and install filter. Mount your new intake tube to the rubber mount with the supplied fastener and washer. Do not tighten yet.



e. Reinstall the tube mounting bolt taking care to position your new intake tube with clearance all around. Tighten both tube mounting bolts.



e. Route the retained hose from the airbox to the end of the filter and rotate the fitting in the end of the hose to align it with the end of the filter. Install the adapter into the end of the filter and rotate the filter for best alignment before inserting the hose into the fitting until it clicks to indicate engagement on both sides. Torque all three hose clamps to 30 in-lbs. **If your vehicle does not have air injection system, install the supplied 8-215 cap to the 088012 adaptor.**



f. Factory air induction system.



g. Finished installation of AEM Intake System.

4. Reassemble Vehicle

- a. Position all components for the best fitment. Be sure that the components do not contact any unintended part of the vehicle.
- b. Check for adequate clearance with hood and other. Re-adjust components if necessary and re-tighten them.
- c. Inspect the engine bay for any loose tools and check that all fasteners that were moved or removed are properly tightened.
- d. Reconnect negative battery terminal and start engine. Let the vehicle idle for 3 minutes. Perform a final inspection before driving the vehicle.

5. Service and Maintenance

- a. AEM Induction Systems requires cleaning the intake system's air filter element every 100,000 miles. When used in dusty or off-road environments, our filters will require cleaning more often. We recommend that you visually inspect your filter once every 25,000 miles to determine if the screen is still visible. When the screen is no longer visible some place on the filter element, it is time to clean it. To clean, purchase our Synthetic air filter cleaner, part number 1-1000 and follow the easy instructions.
- b. Use window cleaner to clean your powder coated AEM® intake tube.
NOTE: DO NOT USE aluminum polish on powder coated AEM® intake tubes.

For technical inquiries
 e-mail us at
sales@aemintakes.com
 or
 call us at
 800.992.3000

AEM Air Intake System Warranty Policy

AEM® warrants that its intake systems will last for the life of your vehicle. AEM® will not honor this warranty due to mechanical damage (i.e. improper installation or fitment), damage from misuse, accidents or flying debris. AEM® will not warrant its powder coating if the finish has been cleaned with a hydrocarbon-based solvent. The powder coating should only be cleaned with a mild soap and water solution. Proof of purchase of both the vehicle and AEM® intake system is required for redemption of a warranty claim.

This warranty is limited to the repair or replacement of the AEM® part. In no event shall this warranty exceed the original purchase price of the AEM® part nor shall AEM® be responsible for special, incidental or consequential damages or cost incurred due to the failure of this product. Warranty claims to AEM® must be transportation prepaid and accompanied with dated proof of purchase. This warranty applies only to the original purchaser of product and is nontransferable. Improper use or installation, use for racing, accident, abuse, unauthorized repairs or alterations voids this warranty. AEM® disclaims any liability for consequential damages due to breach of any written or implied warranty on all products manufactured by AEM®. Warranty returns will only be accepted by AEM® when accompanied by a valid Return Merchandise Authorization (RMA) number. Credit for defective products will be issued pending inspection. Product must be received by AEM® within 30 days of the date RMA is issued.

If you have a warranty issue, please call (800) 992-3000 and our customer service department will assist you. A proof of purchase is required for all AEM® warranty claims.

Not legal for sale or use on any pollution controlled motor vehicle in California or states adopting California emission procedures. See AEMIntakes.com for CARB status on each part for a specific vehicle.