



Equipped with AEM® Dryflow™ Filter  
No Oil Required!

## INSTALLATION INSTRUCTIONS

### PART NUMBER: 21-8026

---

2007-2008	CHEVROLET	Silverado 2500HD	V8-6.0L	C.A.R.B. E.O. # D-670-2
2007-2008	CHEVROLET	Silverado 3500HD	V8-6.0L	C.A.R.B. E.O. # D-670-2
2007-2008	GMC	Sierra 2500HD	V8-6.0L	C.A.R.B. E.O. # D-670-2
2007-2008	GMC	Sierra 3500HD	V8-6.0L	C.A.R.B. E.O. # D-670-2

**\* NOTE: Legal in California only for racing vehicles which may never be used upon a highway**

## PARTS LIST

Description	Qty.	Part Number
A	1	2-80261
B	1	20-8026
C	1	1228562
D	1	8-4011
E	1	8-4012
F	1	102504
G	2	559960
H	2	444.460.08
I	1	21-2100DK
J	1	9-7000N
K	1	94104
L	3	9456
M	1	9464
N	1	5-1010
O	1	5-3549-02
P	1	5-350
Q	2	4093-5
R	2	1-127

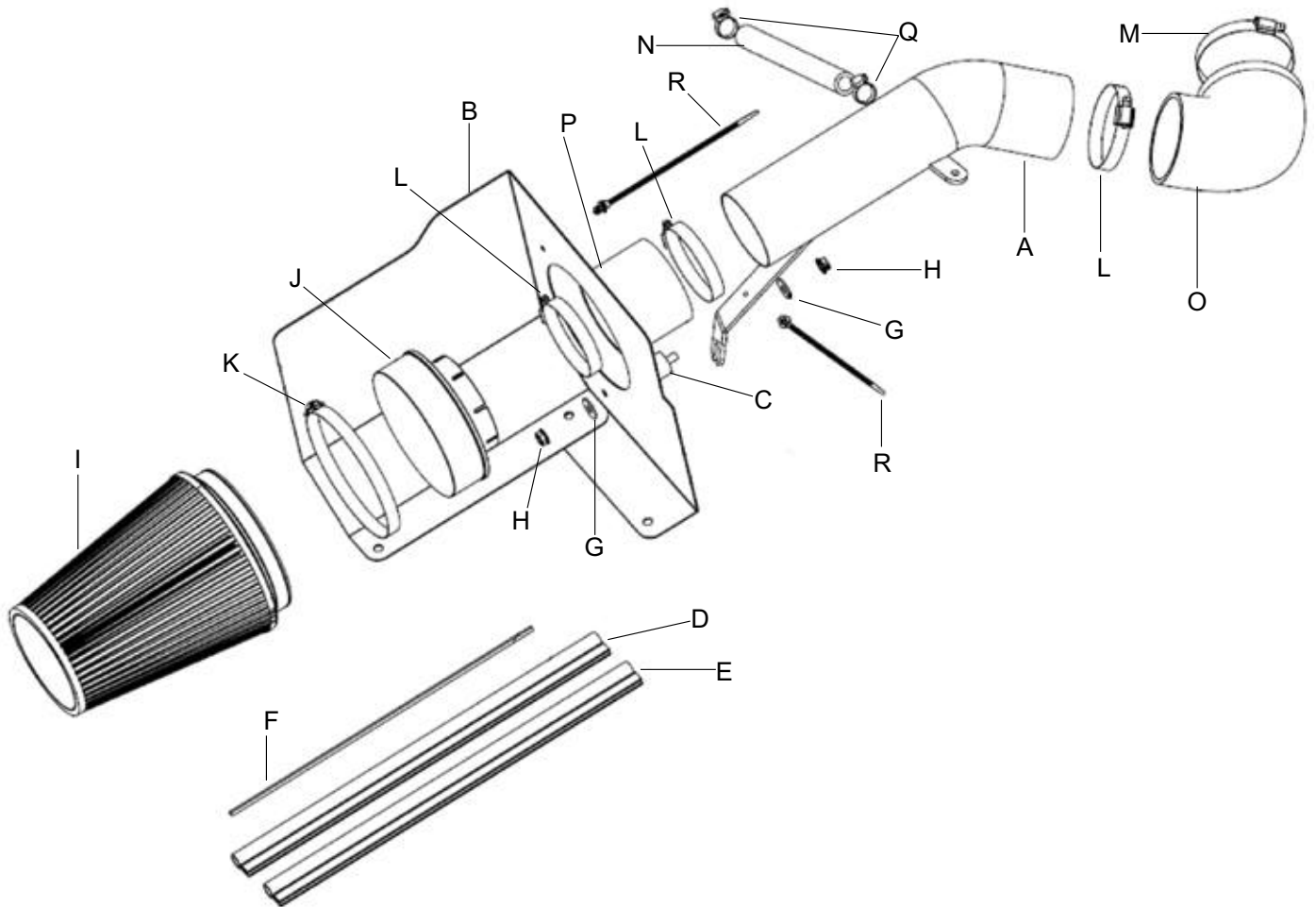

Read and understand these instructions **BEFORE** attempting to install this product. Failure to follow installation instructions and not using the provided hardware may damage the intake tube, throttle body and engine.

## 1. Preparing Vehicle

- a. Make sure vehicle is parked on level surface.
- b. Set parking brake.
- c. If engine has run in the past two hours, let it cool down.
- d. Disconnect negative battery terminal.
- e. Do not discard stock components after removal of the factory system.

## 2. Removal of stock system



a. Stock air system installed system. Pull engine cover off.



b. Pull out the breather hose out of the resonating chamber in the stock air box system.



c. Loosen the hose clamp located at the throttle body.



d. Pull the plastic radiator hose tree mount out of the stock intake tube holder.



e. Disconnect the mass air flow sensor wire, and loosen the hose clamp securing the MAF housing to the stock inlet tube.



f. Pull the stock inlet tube out of the vehicle. Loosen the hose clamp securing the MAF housing to the air filter, remove MAF housing, keep for later reuse.



g. Pull the stock air filter housing straight up out of the vehicle.



h. Remove the four bolts securing the stock air box mounting plate.



i. Remove the breather hose from the valve cover.

### 3. Installation of AEM® intake system.

a. When installing the intake system, do not completely tighten the hose clamps or mounting hardware until instructed to do so.



b. On the heat shield, install rubber mount using the supplied washer and nut. Install "8-3018" rubber edge trim around intake pipe opening. Install 8-4011 and 8-4012 edge trim to top edge of the heat shield.

c. Install the heat shield using the three stock bolts used to secure the air filter box mounting plate.

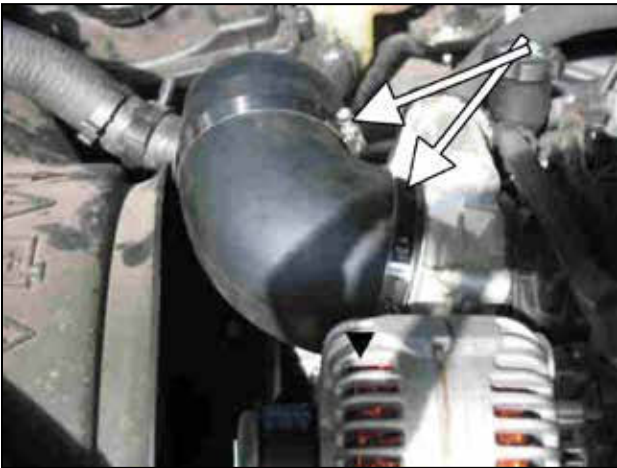

d. Install the elbow onto the throttle body, and loosely put the supplied hose clamps on the ends.



e. Insert intake pipe into elbow located at the throttle body. Secure the bracket to the rubber mount on the heatshield.



f. Install the reinforced silicone coupler on the MAF housing. Do not put the hose clamps on before attempting to do this.



g. Then attach the assembly made in step 3g. to the end of the intake pipe. Reconnect the MAF sensor wire.



h. Create the air filter assembly by inserting the air filter adapter into the air filter as shown. Once in place secure the hose clamp.



i. Install air filter assembly into the stock MAF rubber coupler.

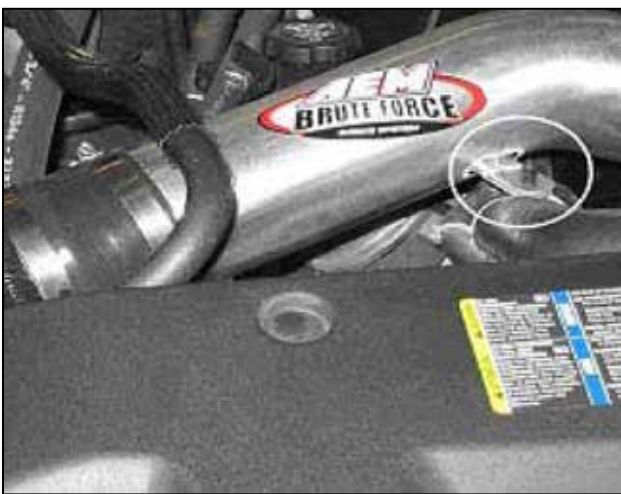

j. Use the stock plastic radiator clamp to secure the radiator hose away from the intake pipe. By inserting it into the bracket located on the pipe.

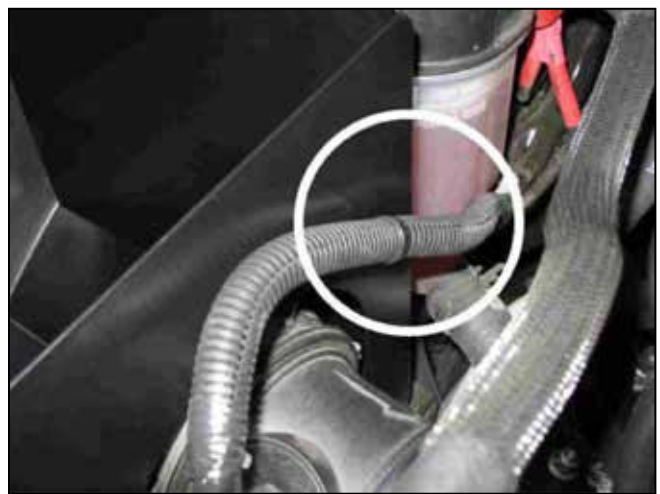

k. Use the supplied tree mount to secure the MAF sensor wire to heatsheild.

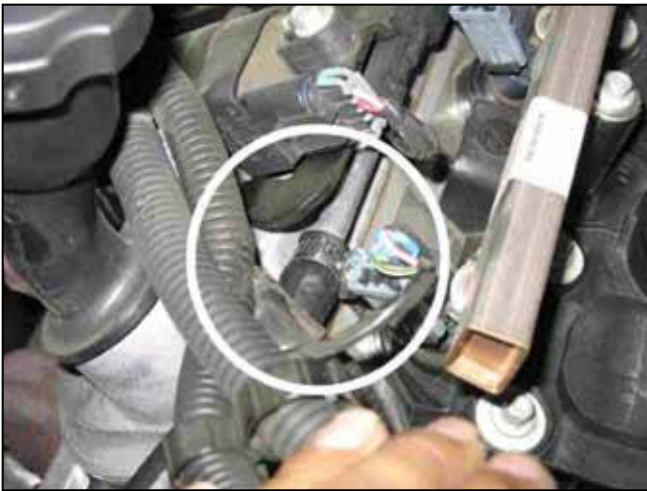

l. Secure the supplied breather hose with the supplied hose clamp.



m. Secure the breather hose to the nipple on the intake pipe.



n. Insert tree mount into intake pipe bracket, secure radiator overflow hose to tree mount.



o. Reinstall the engine cover.



Factory air box system installed



AEM® intake system installed

#### 4. Reassemble Vehicle

- a. Position the inlet pipes for the best fitment. Be sure that the pipes or any other components do not contact any part of the vehicle. Tighten the rubber mount, all bolts, and hose clamps.
- b. Check for proper hood clearance. Re-adjust pipes if necessary and re-tighten them.
- c. Inspect the engine bay for any loose tools and check that all fasteners that were moved or removed are properly tightened.
- d. Reconnect negative battery terminals and start engine. Let the vehicle idle for 3 minutes. Perform a final inspection before driving the vehicle.

#### 5. CARB Sticker Placement

- a. The C.A.R.B. exemption sticker, (attached), must be visible under the hood so that an emissions inspector can see it when the vehicle is required to be tested for emissions. California requires testing every two years, other states may vary.
- b. Most General Motors trucks (including Chevrolet) have the Vehicle Emissions Certification Information (VECI) label affixed to the air filter box. In order to be compliant with California emissions laws, the label **MUST** remain in the engine compartment. If the Vehicle Emission Control Information label is removed during modification, a new replacement label must be obtained and installed in a readily visible position in the engine compartment. The label shall not be affixed to any equipment which is easily detached from the vehicle. We recommend that the label is affixed to the underside of the hood adjacent to the hood latch. The label is Vehicle Identification Number dependent and can be ordered from the vehicle dealership. In order to receive the proper decal please bring your VIN with you. Failure to have the VECI under the hood may result in failure of a pre-registration smog test.

#### 6. Service and Maintenance

- a. It is recommended that you service your AEM® Dryflow™ filter every 20,000 miles for optimum performance. Use AEM Dryflow cleaning kit part # 21-110.
- b. Use aluminum polish to clean your polished AEM® intake tube.
- c. Use window cleaner to clean your powder coated AEM® intake tube. **(NOTE: DO NOT USE aluminum polish on powder coated AEM intake tubes).**

For technical inquiries  
e-mail us at  
[sales@aemintakes.com](mailto:sales@aemintakes.com)  
or  
call us at  
800.992.3000

#### AEM Air Intake System Warranty Policy

AEM® warrants that its intake systems will last for the life of your vehicle. AEM will not honor this warranty due to mechanical damage (i.e. improper installation or fitment), damage from misuse, accidents or flying debris. AEM will not warrant its powder coating if the finish has been cleaned with a hydrocarbon-based solvent. The powder coating should only be cleaned with a mild soap and water solution. Proof of purchase of both the vehicle and AEM intake system is required for redemption of a warranty claim.

This warranty is limited to the repair or replacement of the AEM part. In no event shall this warranty exceed the original purchase price of the AEM part nor shall AEM be responsible for special, incidental or consequential damages or cost incurred due to the failure of this product. Warranty claims to AEM must be transportation prepaid and accompanied with dated proof of purchase. This warranty applies only to the original purchaser of product and is nontransferable. Improper use or installation, use for racing, accident, abuse, unauthorized repairs or alterations voids this warranty. AEM disclaims any liability for consequential damages due to breach of any written or implied warranty on all products manufactured by AEM. Warranty returns will only be accepted by AEM when accompanied by a valid Return Merchandise Authorization (RMA) number. Credit for defective products will be issued pending inspection. Product must be received by AEM within 30 days of the date RMA is issued.

If you have a warranty issue, please call (800) 992-3000 and our customer service department will assist you. A proof of purchase is required for all AEM warranty claims.