



Equipped with AEM® Dryflow™ Filter
No Oil Required!

INSTALLATION INSTRUCTIONS

PART NUMBER: 21-9032DS

Year	Make	Model	Engine Info	CARB E.O. #
2012	Chevrolet	Silverado 2500HD/3500 HD	V8-6.6L DSL	D-670-13
2012	GMC	Sierra 2500HD/3500HD	V8-6.6L DSL	D-670-13
2011	Chevrolet	Silverado 2500 HD/3500HD	V8-6.6L DSL	D-670-13
2011	GMC	Sierra 2500HD/3500HD	V8-6.6L DSL	D-670-13

INTAKE SYSTEMS FOR VEHICLES
LISTED ARE 50 STATE LEGAL. SEE
AEMINTAKES.COM FOR CARB STATUS ON
EACH PART FOR A SPECIFIC VEHICLE.

PARTS LIST

	Description	Qty.	Part Number
A	Intake Tube	1	9-0405
B	Intake Elbow	1	9-0412
C	Lid, Airbox	1	9-0411
D	Airbox, Intake	1	9-0406
E	Hose, Silicone 4.25 X 2.5"	1	5-1066
F	Hose, Silicone 4.50 X 3.0"	1	5-450
G	Air Filter Asy. 5 X 8" DSL Oval	1	21-2258DK
H	Insert, Diesel A/F Asy. 5"	1	5-2279
I	Edge Trim, 20"	1	102494A
J	Bndhose Clamp, 1/2" ,4.00"	4	9472
K	Mount, Rubber 5/8" X 6MM	1	1228598
L	Bolt; Socket M4-.7 X 8MM	2	1-2105
M	Bracket, L, Mounting; 1.0 X 1.0	1	32-3087
N	Bolt; Hex/Flange M6-1 X 30	4	1-1016
O	Bolt; Hex M6-1 X 12MM	1	07727
P	Bolt; Hex M6-1 X 25MM	3	07704
Q	Nut; M6 Hex Serrated	1	444.460.04
R	Washer, M6 Split Lock Zinc	1	1-3025
S	Plug	1	09711
T	Grommet; Bumper, 7/8" O.D. X 3/8" I.D.	1	784647
U	Washer; 1"D X 1/4 Hole Fender	5	08160
V	Clamp; Hose, 9/16"	1	KITHS80

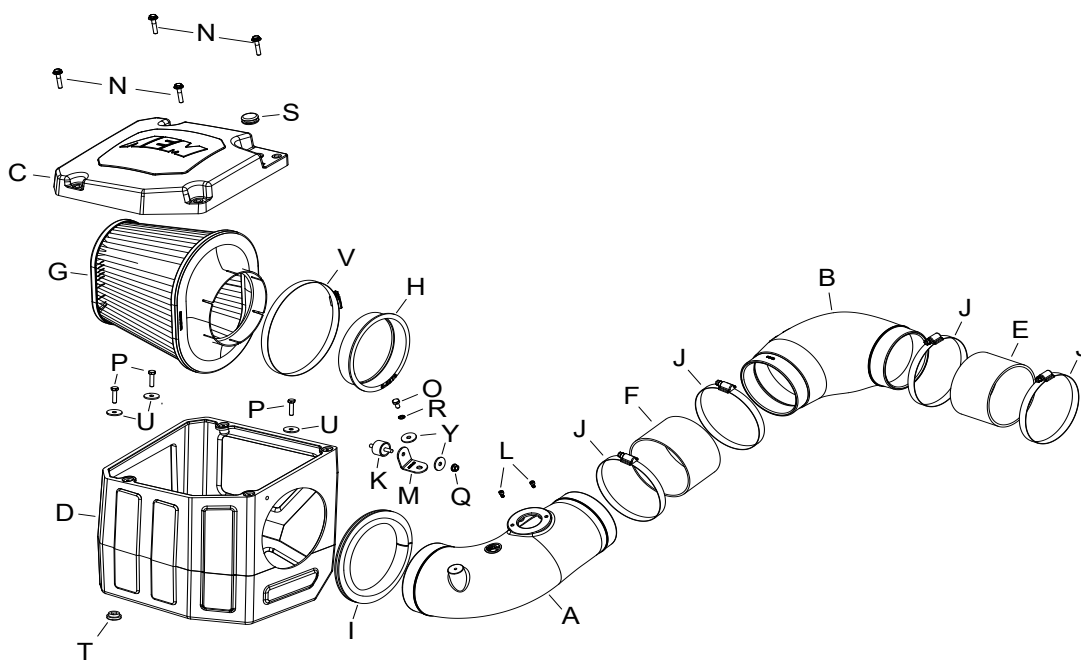

Read and understand these instructions BEFORE attempting to install this product. Failure to follow installation instructions and not using the provided hardware may damage the intake tube, throttle body and engine.

1. Preparing Vehicle

- a. Make sure vehicle is parked on level surface.
- b. Set parking brake.
- c. If engine has run in the past two hours, let it cool down.
- d. Disconnect negative battery terminal.
- e. Do not discard stock components after removal of the factory system.

2. Removal of stock system



a. Pull back the grey locking tab on the female MAF sensor connector to unlock it.



b. Depress the snap tab on the connector as shown and pull it to disconnect the harness from the MAF sensor.



c. Loosen the 2 hose clamps retaining the stock intake tube.



d. Remove the stock intake tube from the air box and engine air inlet.



e. Pull up on the stock filter air box starting on the side closer to the engine to “pop” it free from its mounting grommets. Remove the air box assembly from the engine bay.

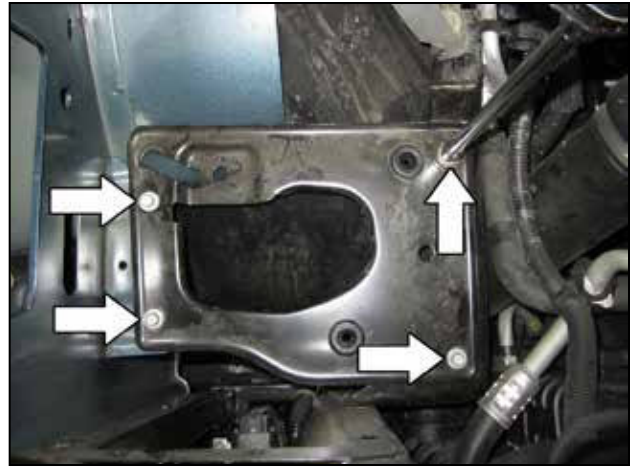

f. Using a 10mm socket, remove the 4 bolts retaining the stock air box mounting plate; remove the mounting plate.



g. Using a T20 Torx bit, remove the 2 screws retaining the MAF sensor to the upper air box lid. Remove the sensor for use with your new AEM® cold air intake. Make sure the O-ring is intact on the sensor.

3. Installation of AEM® Intake System

a. When installing the intake system, do not completely tighten the hose clamps or mounting hardware until instructed to do so.



b. Install the MAF sensor onto the MAF pad on the lower intake tube. Secure with the two 4mm Allen bolts provided. Tighten the bolts.



c. Install the silicone hose onto the outlet end of the intake elbow, on the “A” side of the AEM® logo. Install the larger silicone hose onto the inlet side of the intake elbow, the end closest to the “M” in the AEM® logo. Secure both couplers with hose clamps as shown.



d. Loosely install another hose clamp over the outlet hose and install the intake elbow assembly onto the engine intake port as shown. Do not fully tighten the hose clamp yet.



e. Install the bulb seal around the inside edge of the outlet hole of the air box as shown. Trim any excess bulb seal as needed.



f. Install the foot grommet on the outside of the air box in the larger left front mounting hole as shown.



g. Place the air box into the engine bay where the stock air box was located as shown. Make sure the new left front mounting grommet is aligned with the threaded hole in the engine bay.



h. While pulling the air box toward the stock coolant reservoir to align the air box, install two of the M6 long bolts with two flat washers at the 2 mounting holes as shown. Make sure the air box inlet window is aligned with the stock air inlet window in the sheet metal fender liner. Tighten the two bolts.



i. Install the third M6 bolt with a flat washer in the remaining mounting hole near the inlet window and tighten. Note that the large air inlet window is aligned with the smaller stock air inlet window in the vehicle fender.



j. Install the filter insert into the outlet of the Dryflow™ air filter. Install the large hose clamp provided over the air filter outlet as shown.

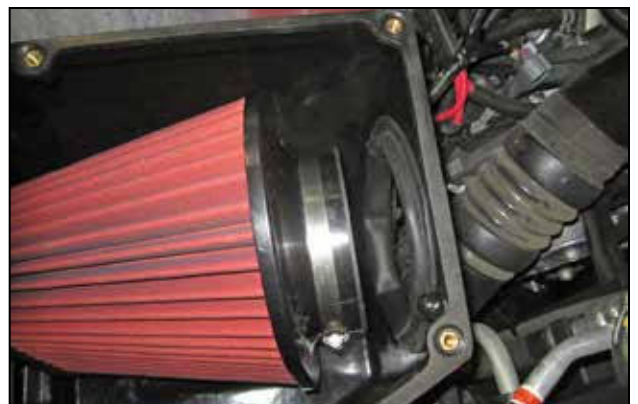

k. Insert the Dryflow™ air filter assembly into the air box as shown.



l. Loosely install the lower intake tube through the bulb sealed outlet hole in the air box and into the Dryflow air filter base adapter as shown.

NOTE: The intake tube should pass under the stock MAF harness and small coolant return hose.



n. Fully seat the Dryflow air filter onto the lower intake tube inlet and align it inside the air box as shown. Tighten the large hose clamp at the filter base.



p. Install the rubber mount into the M6 brass insert on the side of the air box as shown. Tighten by hand.



m. Connect the MAF harness to the MAF sensor and push the locking tab in to lock the connector.



o. Install the fourth hose clamp on the open silicone hose already mounted on the intake elbow. Insert the outlet end of the lower intake tube into the silicone hose. Loosely secure the hose clamp so the intake tube can rotate inside the hose.



q. Loosely install the "L" bracket, one flat washer, and one M6 serrated nut onto the rubber mount.



r. Install one flat washer, one split washer, and one M6 hex bolt through the "L" bracket slot and into the mounting boss in the lower intake tube. Tighten the bolt and the hex nut with a 10mm socket.



s. Rotate the lower intake tube and filter assembly until the edge of the filter cap lines up with the top edge of the air box opening near the fender as shown.



t. Tighten the hose clamp at the silicone hose connecting the lower intake tube to the intake elbow.



u. Fully seat the silicone hose at the engine intake port and tighten the hose clamp. The intake tube and filter installation is now complete. You are now ready to seal the air box.



v. Install the plug into the 0.75" hole in the corner of the air box lid as shown.



w. Install the air box lid onto the air box as shown using the M6 hex/flange bolts provided. Start all 4 bolts by hand first and then tighten them with a 10mm socket to seal the air box.



AEM® intake system installed.

4. Reassemble Vehicle

- a. Position the inlet pipes for the best fitment. Be sure that the pipes or any other components do not contact any part of the vehicle. Tighten any rubber mounts (if applicable), all bolts, and hose clamps.
- b. Check for proper hood clearance. Re-adjust pipes if necessary and re-tighten them.
- c. Inspect the engine bay for any loose tools and check that all fasteners that were moved or removed are properly tightened.
- d. Reconnect the negative battery terminal and start the engine. Let the vehicle idle for 3 minutes. Perform a final inspection before driving the vehicle.

5. VECI (Vehicle Emission Controls Information)

Most General Motors trucks (including Chevrolet) have the Vehicle Emissions Certification Information (VECI) label affixed to the air filter box. In order to be compliant with California emissions laws, the label **MUST** remain in the engine compartment. If the Vehicle Emission Control Information label is removed during modification, a new replacement label must be obtained and installed in a readily visible position in the engine compartment. The label shall not be affixed to any equipment which is easily detached from the vehicle. We recommend that the label is affixed to the underside of the hood adjacent to the hood latch. The label is Vehicle Identification Number dependent and can be ordered from the vehicle dealership. In order to receive the proper decal, please bring your VIN with you. Failure to have the VECI under the hood may result in failure of a pre-registration smog test.

6. CARB Sticker Placement

- a. The C.A.R.B. exemption sticker, (attached), must be visible under the hood so that an emissions inspector can see it when the vehicle is required to be tested for emissions. California requires testing every two years, other states may vary.

7. Service and Maintenance

- a. AEM Induction Systems requires cleaning the intake system's air filter element every 100,000 miles. When used in dusty or off-road environments, our filters will require cleaning more often. We recommend that you visually inspect your filter once every 25,000 miles to determine if the screen is still visible. When the screen is no longer visible some place on the filter element, it is time to clean it. To clean, purchase our AEM® Synthetic Air Filter Cleaner, part number 1-1000 and follow the easy instructions.
- b. Use a damp cloth or window cleaner to clean your powder coated AEM® intake tube.

NOTE: DO NOT USE aluminum polish on powder coated AEM® intake tubes.

For technical inquiries
e-mail us at
sales@aemintakes.com
or
call us at
800.992.3000

AEM Air Intake System Warranty Policy

AEM® warrants that its intake systems will last for the life of your vehicle. AEM will not honor this warranty due to mechanical damage (i.e. improper installation or fitment), damage from misuse, accidents or flying debris. AEM will not warrant its powder coating if the finish has been cleaned with a hydrocarbon-based solvent. The powder coating should only be cleaned with a mild soap and water solution. Proof of purchase of both the vehicle and AEM intake system is required for redemption of a warranty claim.

This warranty is limited to the repair or replacement of the AEM part. In no event shall this warranty exceed the original purchase price of the AEM part nor shall AEM be responsible for special, incidental or consequential damages or cost incurred due to the failure of this product. Warranty claims to AEM must be transportation prepaid and accompanied with dated proof of purchase. This warranty applies only to the original purchaser of product and is nontransferable. Improper use or installation, use for racing, accident, abuse, unauthorized repairs or alterations voids this warranty. AEM disclaims any liability for consequential damages due to breach of any written or implied warranty on all products manufactured by AEM. Warranty returns will only be accepted by AEM when accompanied by a valid Return Merchandise Authorization (RMA) number. Credit for defective products will be issued pending inspection. Product must be received by AEM within 30 days of the date RMA is issued.

If you have a warranty issue, please call (800) 992-3000 and our customer service department will assist you. A proof of purchase is required for all AEM warranty claims.

INTAKE SYSTEMS FOR VEHICLES
LISTED ARE 50 STATE LEGAL. SEE
AEMINTAKES.COM FOR CARB STATUS ON
EACH PART FOR A SPECIFIC VEHICLE.