



**IMPORTANT WARRANTY & INSTALLATION
INSTRUCTIONS ATTACHED**

*Please Forward All Attached Information to Consumer
Warranty Not Valid Unless Returned to Volant Performance*



**For Full-Color Installation Instructions, Please Visit:
VOLANTPERFORMANCE.COM and Search by Part Number**

Please be sure to review the enclosed instructions prior to beginning the installation process. If you have any questions about the enclosed parts, instructions or encounter a problem during installation:

CALL VOLANT PERFORMANCE TECHNICAL ASSISTANCE AT 909.481.3888



Please take time to read and understand these installation instructions.

Volant recommends that the installation of this system be performed by a qualified service center or professional installer who has the necessary equipment, tools and experienced personnel. However, if you decide to perform this install the use of an additional person may be required.

CAUTION: Never work on a hot engine bay. Allow time for the vehicle to cool.

Recommended Tools:

- Flathead Screwdriver
- Assorted Socket-Set
- Ratchet
- Ratchet Extension

Please confirm that all parts are present before beginning the installation.

Bill of Materials							
1	Plastic air box	4	¼ x 5/8 rubber washers	1	Pro5 or PowerCore® Filter	1	5/8 11.5 breather hose
1	Plastic air duct	4	¼ -20 x .50' Truss head screw	4	#64 Clamps	1	4.00 hump hose
1	MAF Adapter 6x4 ribbed	3	6mm – 16 bolt	1	4.0 x 3 Straight sleeve	1	Clamp double-line for 5/8 line
1	Aluminum air box lid	3	¼ lock washers	1	MAF sensor gasket		
1	Inspection window for aluminum lid	3	¼ x 5/8 washers	2	4mm x 10 Pan head screw		
1	Lid gasket	1	5/8 NPT fitting straight	1	5/8 x 15 breather hose		



Installation Instructions:

1. Before you begin the install you must disconnect the negative battery cable. Failure to disconnect the battery may cause a check engine light or damage to your engine. **(Fig A)**
2. Press the gray tap inward to remove the factory breather hose. Do this for the drivers and passengers side **(Fig B)**
3. Using a 5/16 socket or nut driver loosen the clamp holding the factory resonator box to the throttle body and the clamp holding the air duct to the throttle body. **(Fig C)**
4. Remove the air duct from the air box by pulling straight off. **(Fig D)**
5. Push out the red locking tab from the MAF harness than remove the sensor. **(Fig E)**
6. You can now remove the factory resonator box. **(Fig F)**
7. Remove the factory drivers and passenger side breather hose from the engine. **(Fig G)**
8. Remove the tree rivet holding the MAF harness to the air box. **(Fig H)**
9. Remove the factory air box by pulling up and out. **(Fig I)**
10. Remove the four 10mm bolts holding the air box mounting plate in place then remove the plate. **(Fig J)**
11. Remove the four tabs holding the shroud onto the passenger side using a flathead screw driver or pry tool **(Fig K)**
12. Remove the 2 – 10mm bolts holding the fender rod in place. **(Fig L)**
13. Place the Volant box into the factory location. **(Fig M)**
14. Mount the Volant box in place using two of the factory 10mm bolts. **(Fig N)**
15. Install the 61508 PowerCore® or the 5119 Pro5 oiled filter onto the filter flange. If you are having trouble installing the filter try reaching through the flange to help push the filter into place. **(Fig O)**
16. Tighten the filter into place only using a 5/16 socket or nut driver. Do not use a flathead screwdriver. **(Fig P)**
17. Attach the hump hose to the filter adapter using 5/16 socket or nut driver. **(Fig Q)**
18. Attach the 4" straight sleeve and #64 clamp using a 5/16 socket or nut driver. **(Fig R)**

CONTINUED ON NEXT PAGE





19. You may now install the lid to the Volant air box using the supplied truss head screws. **(Fig S)**
20. Press the Volant duct into the hump hose and reducer and tighten the remaining #64 clamps with a 5/16 socket or nut driver. **(Fig T)**
21. Press the longer 5/8 breather hose onto the Volant air duct and crankcase vent port. **(Fig U)**
22. Press the shorter 5/8 hose onto the Volant duct and crankcase vent line. **(Fig V)**
23. Remove the torx bits holding the MAF into place using the supplied bit. **(Fig W)**
24. Remove the factory o-ring from the sensor. **USE CAUTION! DO NOT TOUCH MAF SENSOR ELEMENTS. KEEP FREE OF DEBRIS. (Fig X)**
25. Install the supplied Volant MAF gasket. **(Fig Y)**
26. Install the MAF sensor into the Volant duct using the provided 4mm screws. Clip in the harness to the sensor. **(Fig Z)**
27. Reinstall the fender support rod using the factory 10mm bolts. **(Fig AA)**
28. Reinstall the shroud support pins. **(Fig BB)**
29. Install the supplied hose support bracket onto the 5/8 lines. This will help prevent contact between the Volant duct and the rubber lines. **(Fig CC)**
30. Reattach the negative battery cable and check all clamps and hoses before driving the vehicle. Retighten all clamps and hoses at 150, 300, and 1,000 miles. **(Fig DD)**

INSTALLATION PHOTOS ON NEXT PAGE 

Installation Pictures



Fig. A



Fig. B



Fig. C

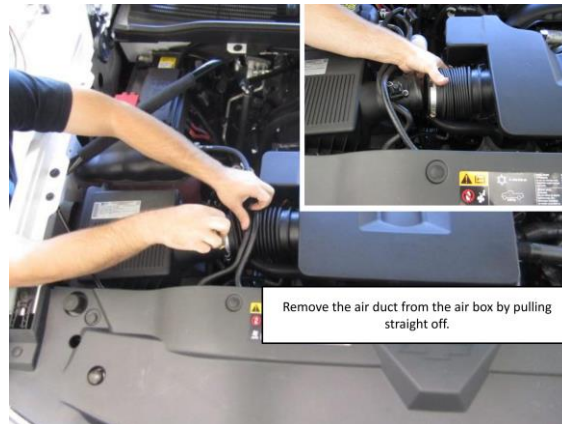


Fig. D



Fig. E



Fig. F

CONTINUED ON NEXT PAGE



Installation Pictures



Fig. G



Fig. H



Fig. I



Fig. J



Fig. K

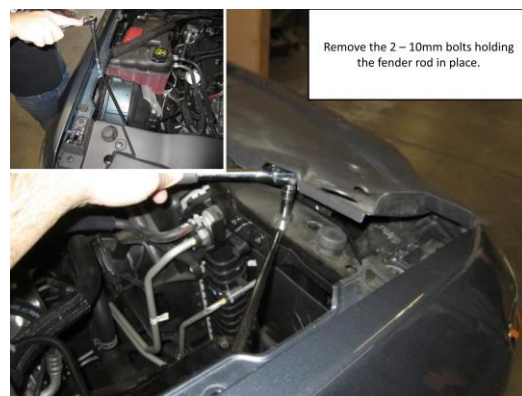


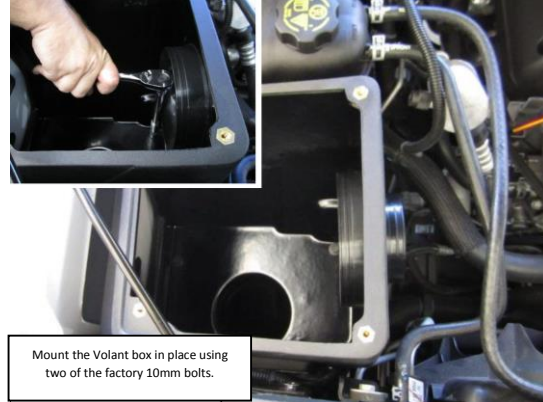
Fig. L

CONTINUED ON NEXT PAGE 

Installation Pictures

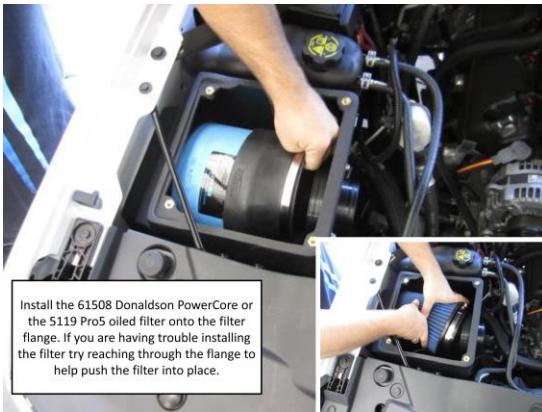


Fig. M



Mount the Volant box in place using two of the factory 10mm bolts.

Fig. N



Install the 61508 Donaldson PowerCore or the 5119 Pro5 oiled filter onto the filter flange. If you are having trouble installing the filter try reaching through the flange to help push the filter into place.

Fig. O

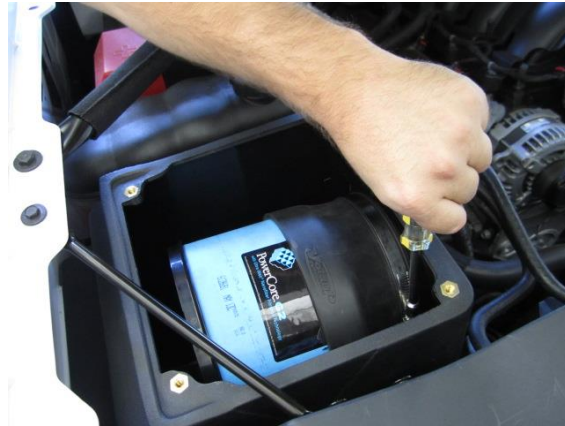


Fig. P



Fig. Q

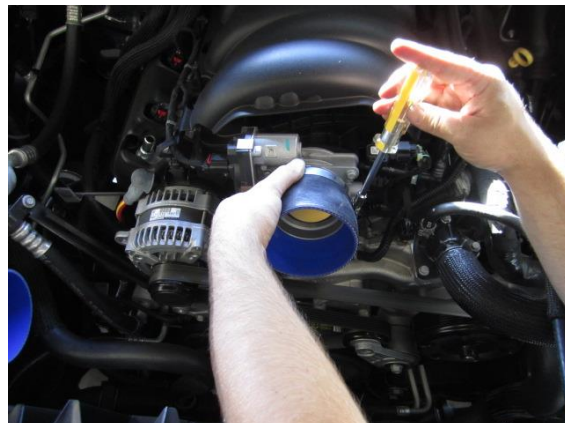


Fig. R

CONTINUED ON NEXT PAGE 

Installation Pictures

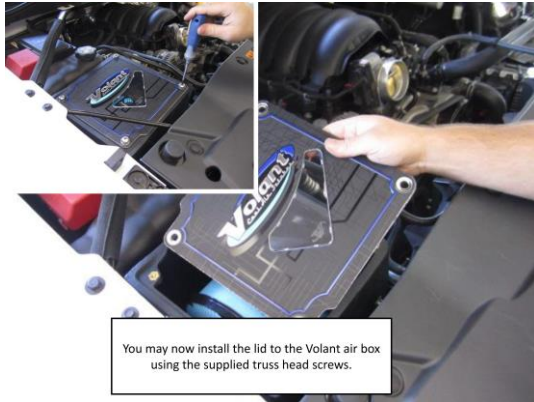


Fig. S

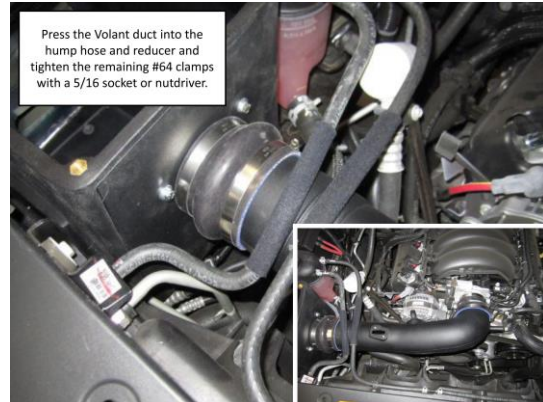


Fig. T

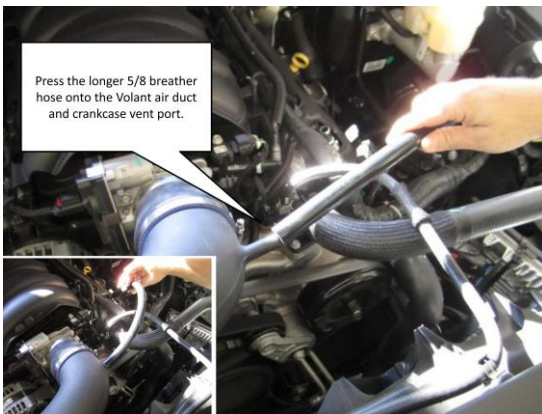


Fig. U



Fig. V

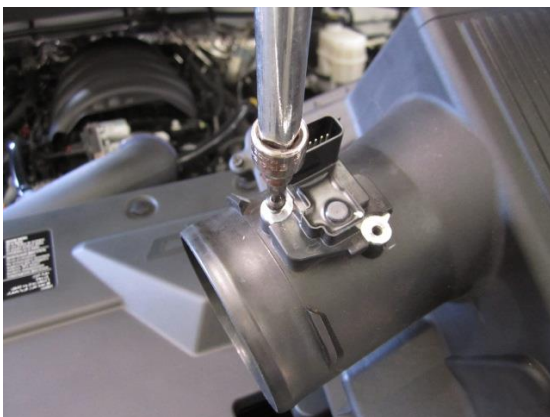


Fig. W



Fig. X

CONTINUED ON NEXT PAGE 

Installation Pictures



Fig. Y



Fig. Z



Fig. AA



Fig. BB



Fig. CC



Fig. DD