

advanced FLOW engineering

Instruction Manual P/N: 54-82212 & 51-82212

Make: **BMW** Model: **328i (F30)** Year: **2012-2016** Engine: **L4-2.0L (Turbo) N20**



- Please read the entire instruction manual before proceeding.
- Ensure all components listed are present.
- If you are missing any of the components, call customer support at 951-493-7100.
- Ensure you have all necessary tools before proceeding.
- Do not attempt to work on your vehicle when the engine is hot.
- Disconnect the negative battery terminal before proceeding.
- Retain factory parts for future use.

Label	Qty.	Description	Part Number
A1	1	Air Filter (Pro 5R)	24-91056
A2	1	Air Filter (Pro DRY S)	21-91056
B	1	Tube	05-82212B1
C	1	Housing	05-82212B2
D	1	Clamp, 096	03-50003
E	2	Screw, Chs Hd: M4	03-50030
F	1	Torx Bit	03-50066
G	2	Tie, Nylon Cable	05-60167

Installation will require the following tools:
Phillips screw driver & 8mm nut driver.

Warranty Information available at <https://afepower.com/contact#warranty>

Note: Legal in California for use on race vehicles only. The use of this device on vehicles used on public streets or highways is strictly prohibited in California and others states that have adopted California emission regulations.

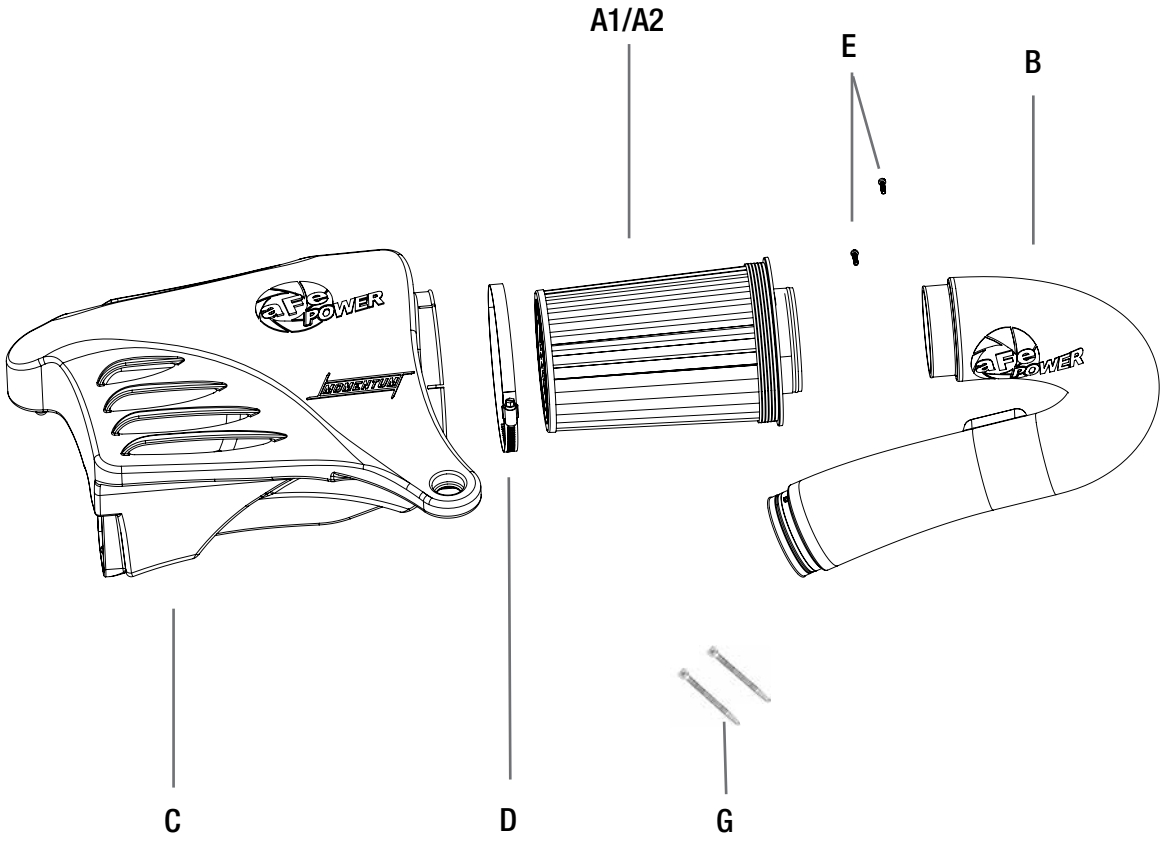



Figure A

Refer to Figure A for step 1-3

Step 1: Disconnect MAF sensor harness (1).

Step 2: Loosen the clamp between the OE airbox and tube (2) and disconnect hood cable.

Step 3: Pull the complete OE housing out of the vehicle (3).

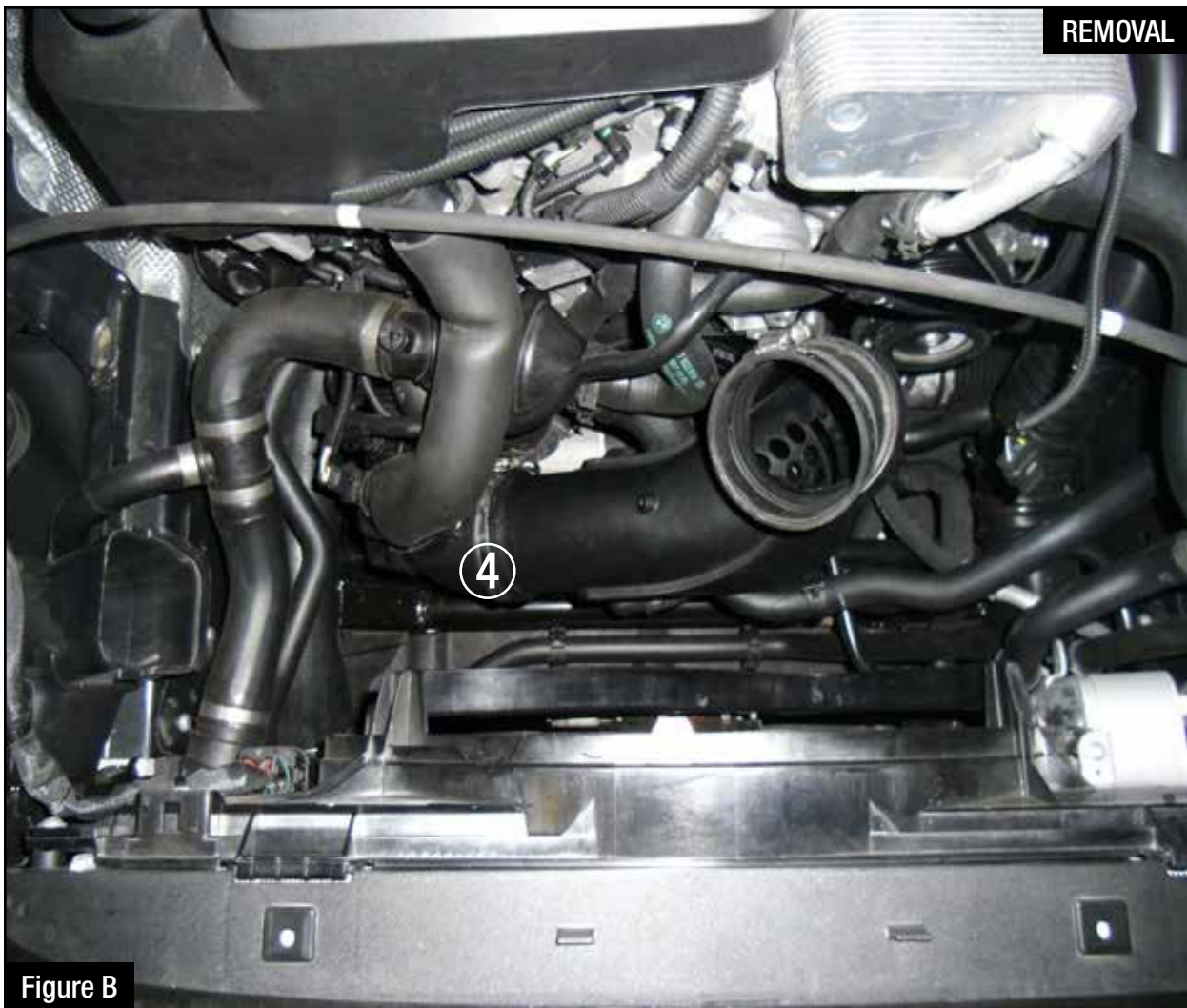

Figure B

Refer to Figure B for steps 4-5

Step 4: Loosen the clamp on the OE tube (4).

Step 5: Pull the OE tube out of the vehicle.



Figure C

Refer to Figure C for steps 6-7

Step 6: Remove MAF sensor from the OE housing with the furnished T20 torx bit.

Step 7: Install MAF sensor into your aFe intake tube using the furnished M4 screws ⑤.

Figure E

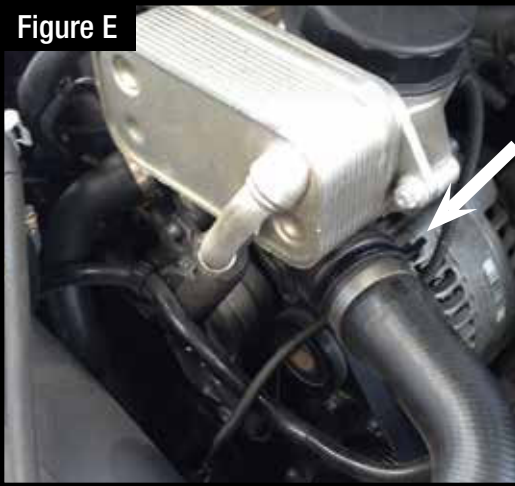

INSTALL

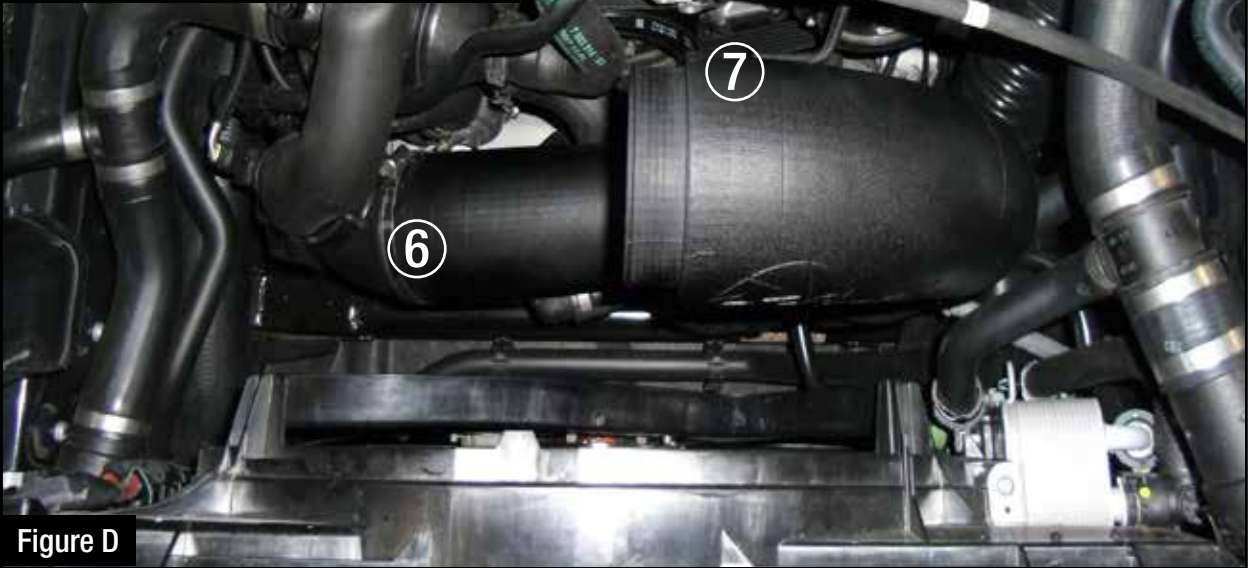

Figure D

Refer to Figure D for steps 8-10

Step 8: Install aFe tube into the vehicle using the OE clamp removed in step 4 (6).

Step 9: Re-direct wiring harness to the new MAF sensor location and secure the harness away from the serpentine belt using the supplied cable ties as shown in figure E.

Step 10: Re-connect wiring harness to the MAF sensor (7).

**Figure F****Refer to Figure F for steps 11-12**

Step 11: Install aFe filter onto the aFe airbox using the furnished clamp (8).

Step 12: Take OE grommet off OE airbox and install it on aFe airbox (9).



Figure G

Refer to Figure G for steps 13-16

Step 13: Install the aFe airbox assembly into vehicle.

Step 14: Connect the air filter to the intake tube using the furnished clamp (10).

Step 15: Secure the hood cable on housing (11).

Step 16: Verify all clamps are secure and re-check periodically. Your Installation is now complete.

Page left blank intentionally

Page left blank intentionally

advanced FLOW engineering, inc.