

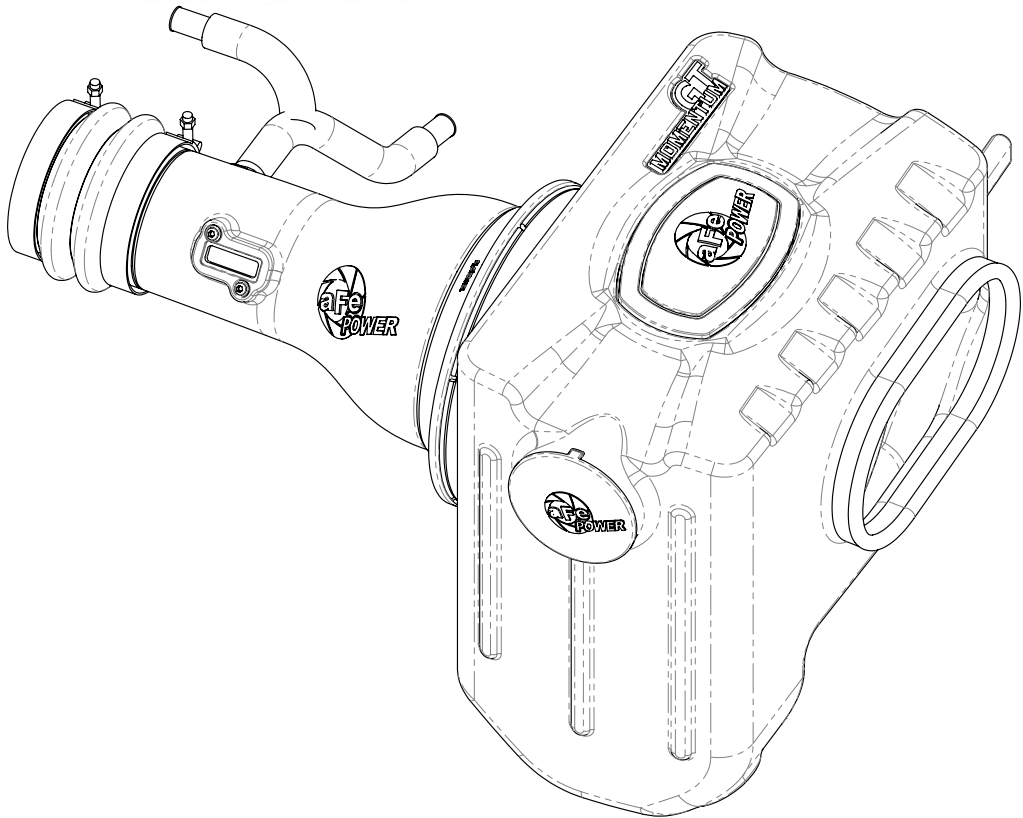

GT
MOMENTUM™



advanced FLOW engineering

Cold Air Intake System

Instruction Manual P/N: 50-70034D / 50-70034R

Make: Nissan

Model: Titan XD

Year: 2017-2022

Engine: V8-5.6L



- Please read the entire instruction manual before proceeding.
- Ensure all components listed are present.
- If you are missing any of the components, call customer support at 951-493-7185.
- Ensure you have all necessary tools before proceeding.
- Do not attempt to work on your vehicle when the engine is hot.

Retain factory parts for future use.

Label	Qty.	Description	Part Number
A1	1	Air Filter (Pro 5R)	24-91059
A2	1	Air Filter (Pro DRY S)	21-91059
B	1	Tube	05-5070034B1
C	1	Housing	05-5070034B2
D	1	Coupling, Silicone Bellows	05-01389
E	1	Plug, Airbox	05-01361
F	1	Hose, Adaptor CCV (Silicone)	05-01346
G	1	Fitting, 5/8"	03-50541
H	2	Screw, Torx: M4	03-50491
I	1	Clamp, T-bolt (8-5/16" - 8-5/8")	03-50267
J	2	Clamp, T-bolt (3-13/16" - 4-1/8")	03-50265
K	1	Seal, Trim: 7/16" Bulb (23" inches)	05-00072

Installation will require the following tools:
Flat head screwdriver, 8mm & 10mm nut drivers and pliers.

Emissions Disclaimer: This product is not currently CARB exempt and is not available for purchase in California or for use on any vehicle registered with the California Department of Motor Vehicles.

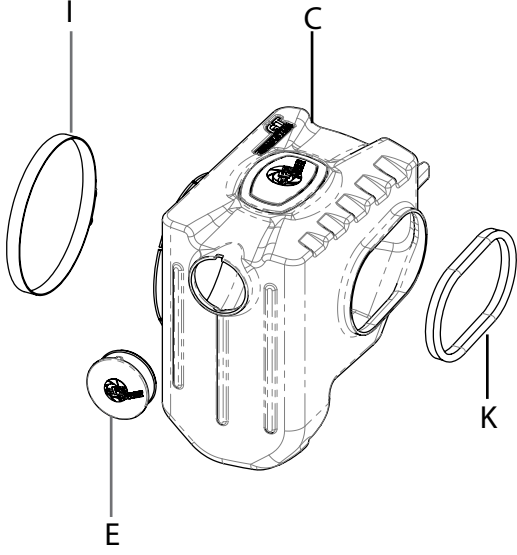
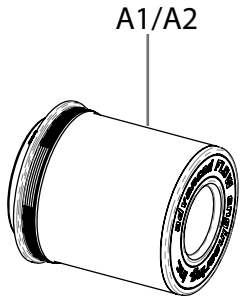
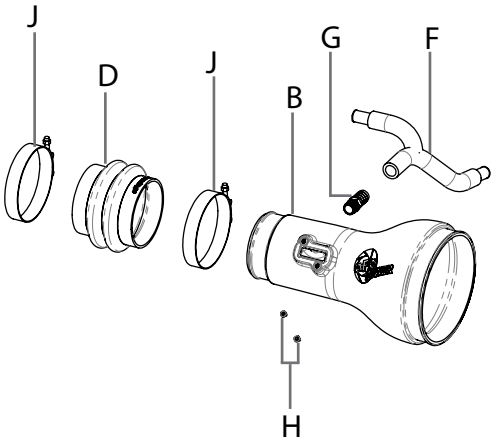



Figure A

Refer to Figure A for Step 1

Step 1: Remove the cover by pulling up and toward the front bumper cover ①.



Figure B

Refer to Figure B for Steps 2-4

Step 2: Use a 10mm nut driver to remove the screw at the back of the factory airbox (2).

Step 3: With the 8mm nut driver, loosen the band clamp at the throttle body (3).

Step 4: Disconnect the MAF harness from the MAF sensor on the factory intake tube (4) and carefully detach the MAF harness from the factory airbox.

**Figure C****Refer to Figure C for Steps 5-8**

Step 5: Compress the metal spring clamps on both crank case vent hoses (5) and slide down each hose.

Step 6: Disconnect both CCV hoses from the resonance chamber and position out of the way.

Step 7: Unclip and remove both plastic clips (6) connecting the rubber evap hose to the resonance chamber.

Step 8: Remove the entire factory intake system from the engine bay.

NOTE: Check the factory airbox for any additional hoses that must be detached, to remove the factory intake system.



FigureD

Refer to Figure D for Step 9

Step 9: Remove the factory scoop from the vehicle by detaching the factory clips ⑦.



Refer to Figure E for Steps 10-13

Step 10: Insert the aFe POWER air filter into the housing and slip the larger clamp over the filter-to-housing interface (8). Tighten the clamp.

Step 11: Remove the three (3x) rubber grommets (9) and one (1x) steel sleeve from the factory airbox and transfer them to the aFe POWER housing, as shown in Figure 1.

Step 12: Install the supplied trim seal (10), as shown in Figure 1.

Step 13: Install the aFe POWER housing into the vehicle and tighten the factory bolt, removed in Step 2.



Figure F

Refer to Figure F for Step 14

Step 14: If desired, install the supplied aFe POWER plug (11).

NOTE: Without the plug installed, the aFe POWER intake will capture the maximum air available. More airflow offers more power. Some of this air is picked up from inside the engine compartment and could be warmer air. Warmer air will affect the performance of the vehicle.



FigureG

Refer to Figure G for Steps 15-16

Step 15: Remove the MAF sensor from the factory intake and transfer to the aFe POWER intake tube, using the two (2x) supplied screws (12).

Step 16: Install the supplied brass fitting into the aFe POWER intake tube (13).

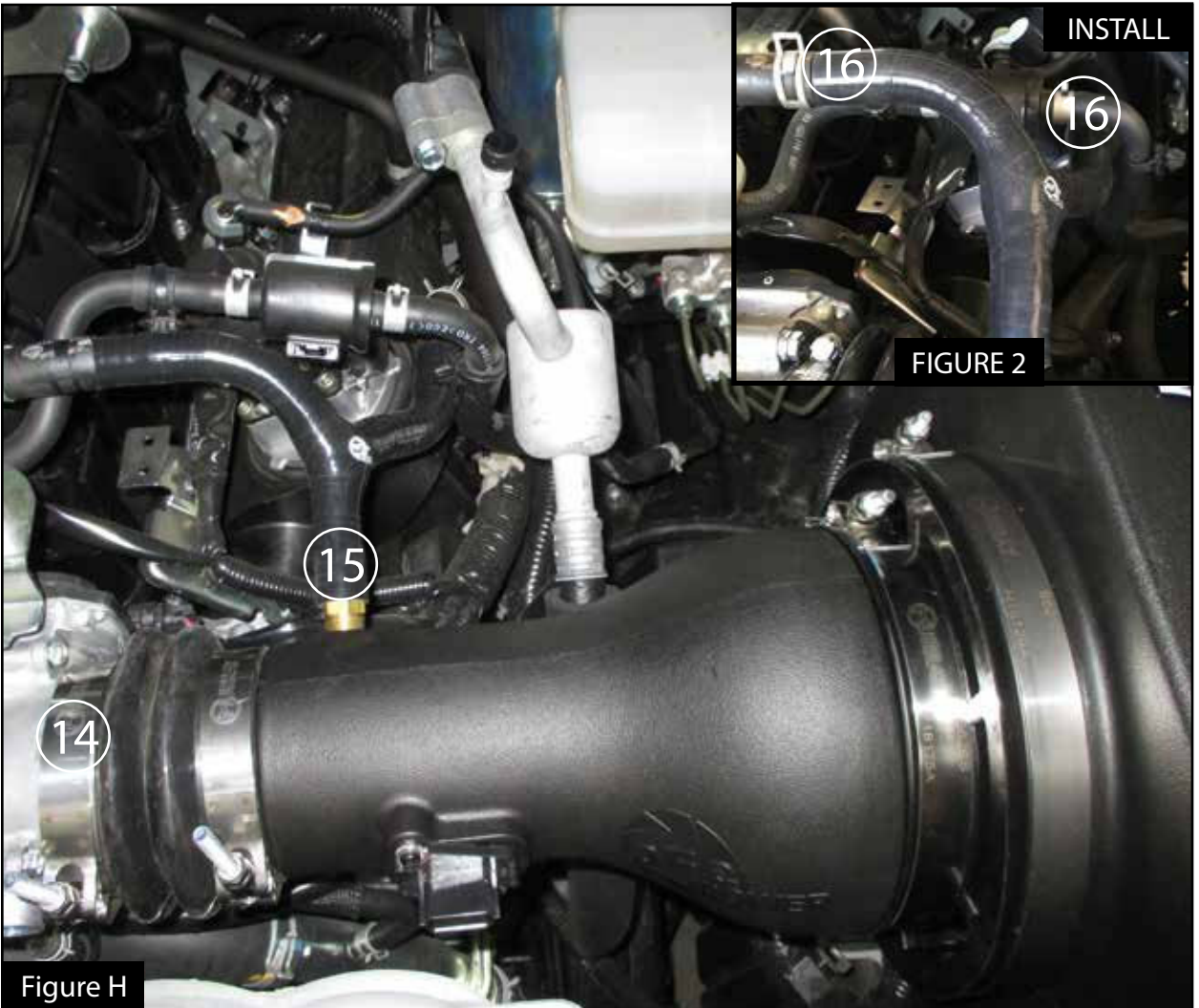

Refer to Figure H for Steps 17-20

- Step 17: Install the supplied coupling into the vehicle. Tighten the clamp at the throttle body (14) but do not tighten the other clamp.
- Step 18: Install the aFe POWER intake tube into the vehicle. Orient the tube to have the logo face the front bumper cover and brass fitting face the firewall.
- Step 19: Install the provided silicone hose adaptor. Place the end with no fitting over the brass insert from Step 16 (15), as shown in Figure 2.
- Step 20: Install the remaining two (2x) ends of the adaptor to the factory CCV hoses (16) and reposition the factory spring clamps.

**Figure I**

Refer to Figure I for Steps 21-24

Step 21: Adjust the tube to sit comfortably between the air filter, coupling, and crankcase hoses. Tighten all the clamps.

Step 22: Connect the MAF harness to the MAF sensor (17).

Step 23: Re-install the engine cover (18).

Step 24: Verify all connections are secured. Your installation is now complete. Thank you for choosing aFe POWER!

NOTE: Check all bolts, clamps, and connectors after 100-200 miles.

Page left blank intentionally



PAGE LEFT BLANK INTENTIONALLY

PAGE LEFT BLANK INTENTIONALLY



advanced FLOW engineering, inc.
252 Granite Street Corona, CA 92879
<https://afepower.com/contact>