

GT
MOMENTUM™

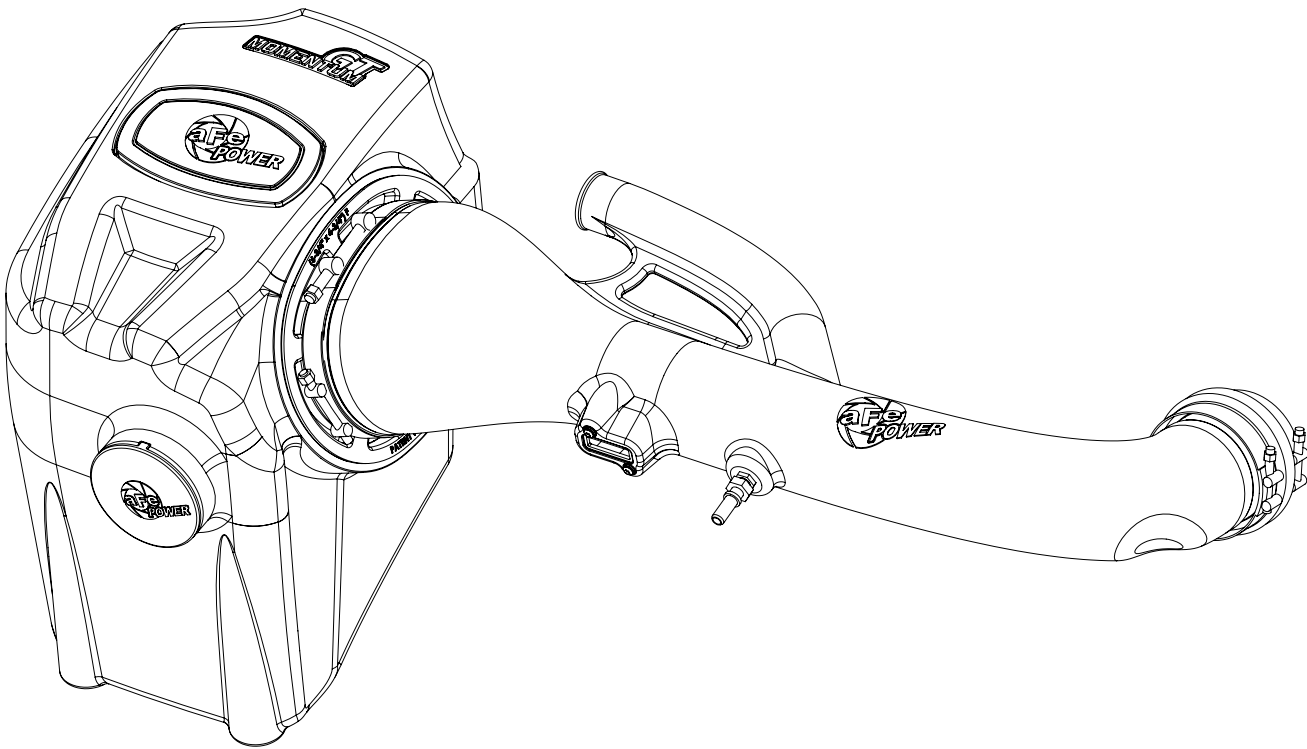

advanced FLOW engineering

Instruction Manual P/N: 51-74109 / 54-74109 / 75-74109

Make: **Chevrolet** Model: **Colorado** Year: **2017-2020** Engine: **V6-3.6L**

Make: **GMC** Model: **Canyon** Year: **2017-2020** Engine: **V6-3.6L**

NOTE: Includes Denali models.



- Please read the entire instruction manual before proceeding.
- Ensure all components listed are present.
- If you are missing any of the components, call technical support at 951-493-7100 or e-mail tech@afepower.com.
- Ensure you have all necessary tools before proceeding.
- Do not attempt to work on your vehicle when the engine is hot.
- Disconnect both the negative battery terminal before proceeding.

Retain factory parts for future use.

Label	Qty.	Description	Part Number
A1	1	Pro 5R (Blue Media)	24-91092
A2	1	Pro DRY S (Grey Media)	21-91092
A3	1	Pro-GUARD 7 (Gold Media)	72-91092
B	1	Tube	05-74109B1
C	1	Housing	05-74106B2
D	1	Plug, Urethane	05-01361
E	1	Seal Trim (7/16") (18 inches)	05-00072
F	1	Clamp, T-bolt (3-1/4" -3-9/16")	03-50292
G	1	Coupling, Silicone Hump Reducer	05-01400
H	2	Screw, Torx: M4 x .7 x 8mm	03-50491
I	1	Vent Fitting	05-01338
J	1	Clamp, T-bolt (3-1/16" -3-3/8")	03-50320

Installation will require the following tools:

10mm & 8mm nut drivers, flat head screwdriver, pliers, T20 driver, 10mm & 11mm deep sockets & drivers, 17mm wrench or adjustable wrench.

Note: Not legal for use in California. The use of this device in any on-road or off-road vehicles registered with the California Dept of Motor Vehicles (DMV) is strictly prohibited.

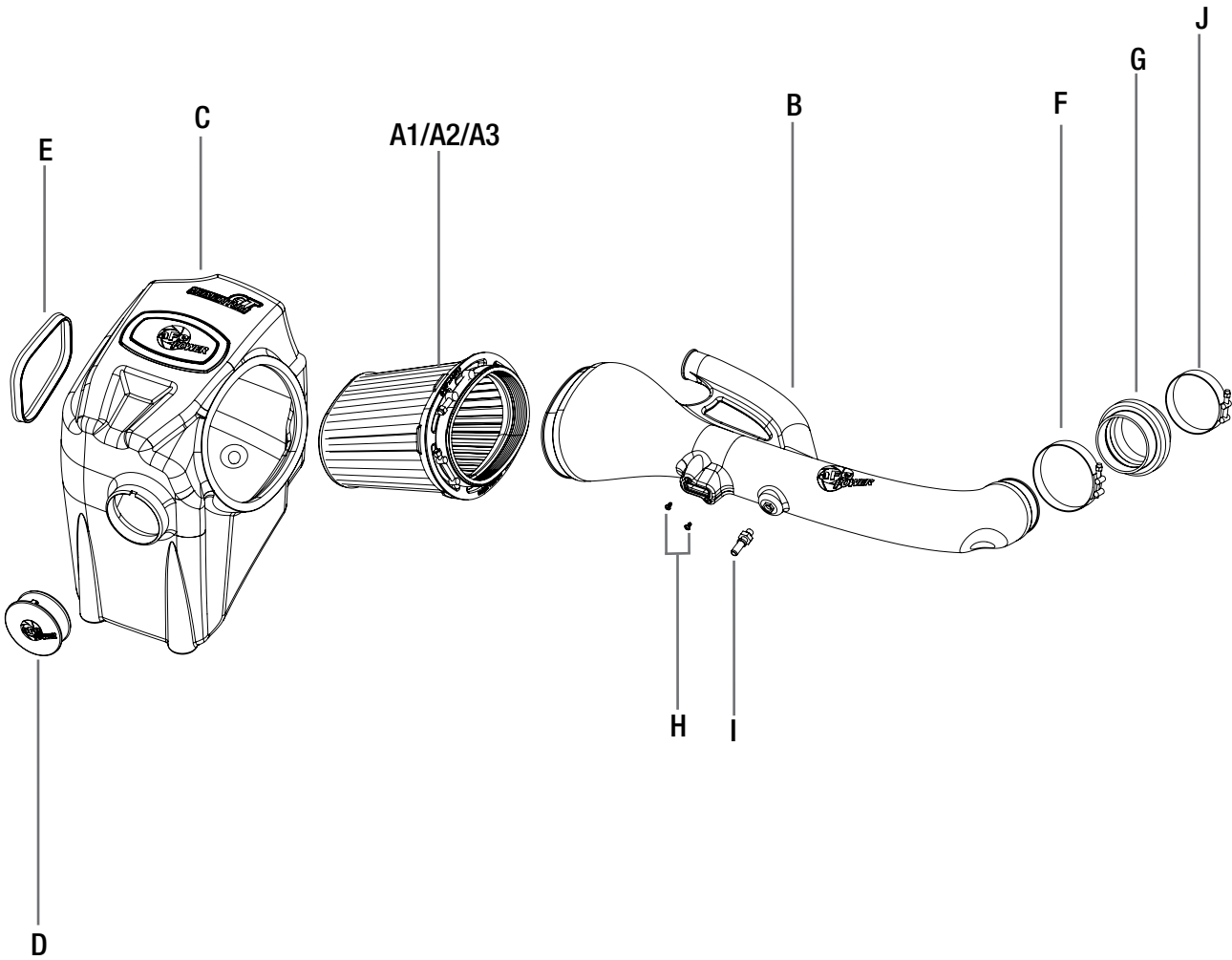



Figure A
Refer to Figure A for Step 1

Step 1: Use an 8mm nut driver to loosen the stock clamps ① at the throttle body, airbox and breather hose. Disconnect the smaller breather hose ② from the engine cover. Use a 10mm nut driver to remove the three screws ③ holding down the engine cover/intake tube. Remove the oil cap ④ and remove the engine cover/intake tube. Reinstall the oil cap.



Figure B

Refer to Figure B for Step 2

Step 2: Disconnect the mass air flow sensor (5). Disengage the wire loom clip (6) from the airbox.



Refer to Figure C for Step 3

Step 3: Use a 10mm nut driver to remove the two nuts (7) holding the airbox and set aside. Remove the airbox with the attached air inlet by pulling up to release the airbox from its mounting grommet.

**Figure D****Refer to Figure D for Step 4**

Step 4: Using a pair of pliers, rotate the coolant reservoir hose clamps (8) so the ears point up as shown.



Figure E

Refer to Figure E for Steps 5-6

Step 5: Using a Torx 20 driver, remove the mass air flow sensor (9) from the stock airbox and install it on the aFe intake tube with the two supplied screws. Do not overtighten.

Step 6: Install the supplied aluminum vent fitting (10) into the aFe intake tube using a 17mm wrench or adjustable wrench.



Figure F

Refer to Figure F for Step 7

Step 7: Install the supplied trim seal on the opening of the aFe airbox.

**Figure G****Refer to Figure G for Step 8**

Step 8: Remove the two grommets with metal spacers (11) from the lower half of the stock airbox and install them onto the aFe airbox.



Figure H

Refer to Figure H for Step 9

Step 9: Install the aFe airbox into the vehicle by pushing down the airbox pin into the rubber grommet and through two front studs. Secure the airbox with the two nuts removed in Step 3 with a 10mm nut driver.



Figure I

Refer to Figure I for Step 10

Step 10: Slide the aFe filter and clamp into the aFe housing and push it in until it locks into place. Do not tighten the clamp at this time.



Figure J

Refer to Figure J for Step 11

Step 11: Install the supplied T-bolt clamps onto the silicone hump coupler. Install the coupler with clamps onto the throttle body. Tighten the clamp at the throttle body only at this time.

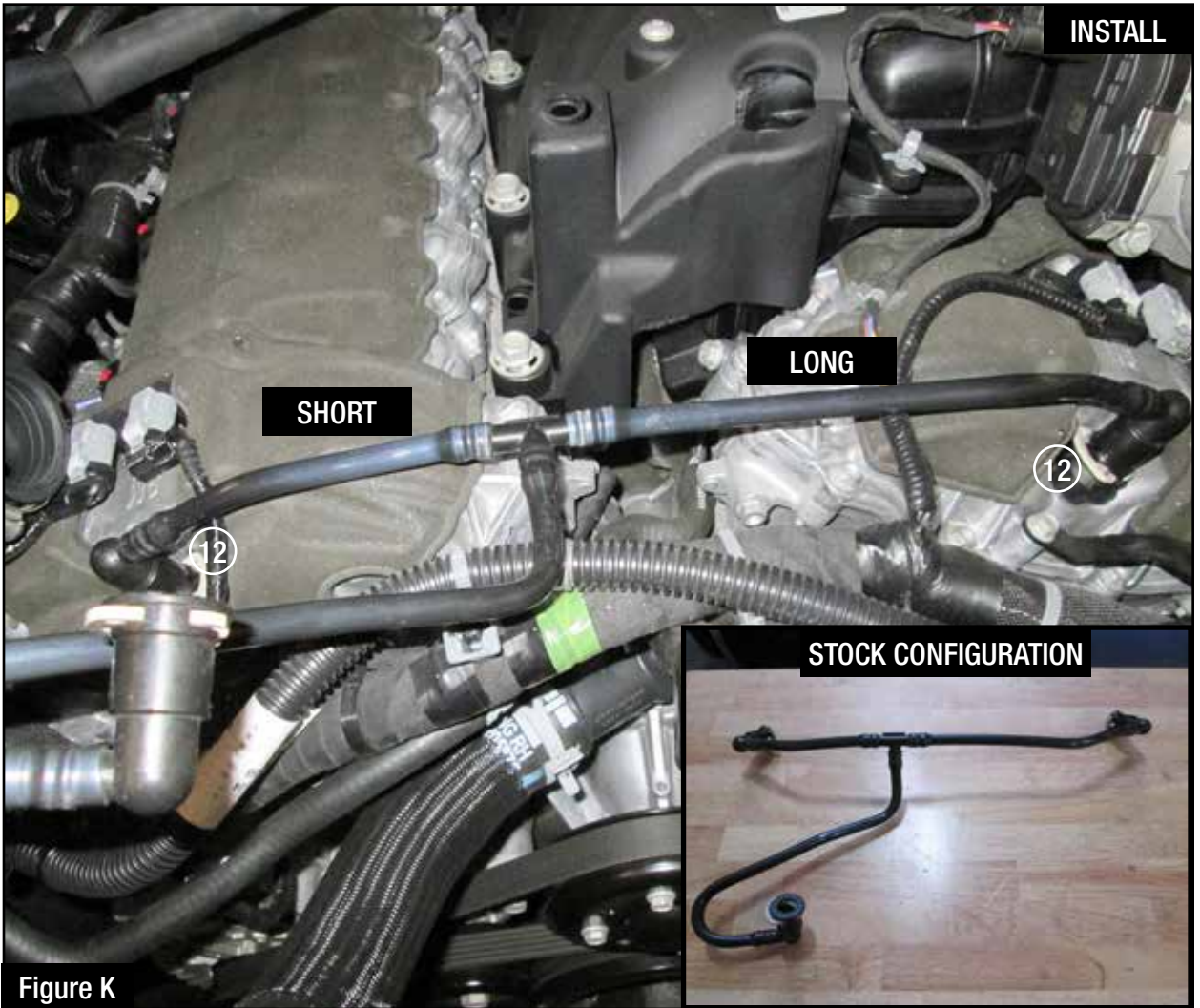
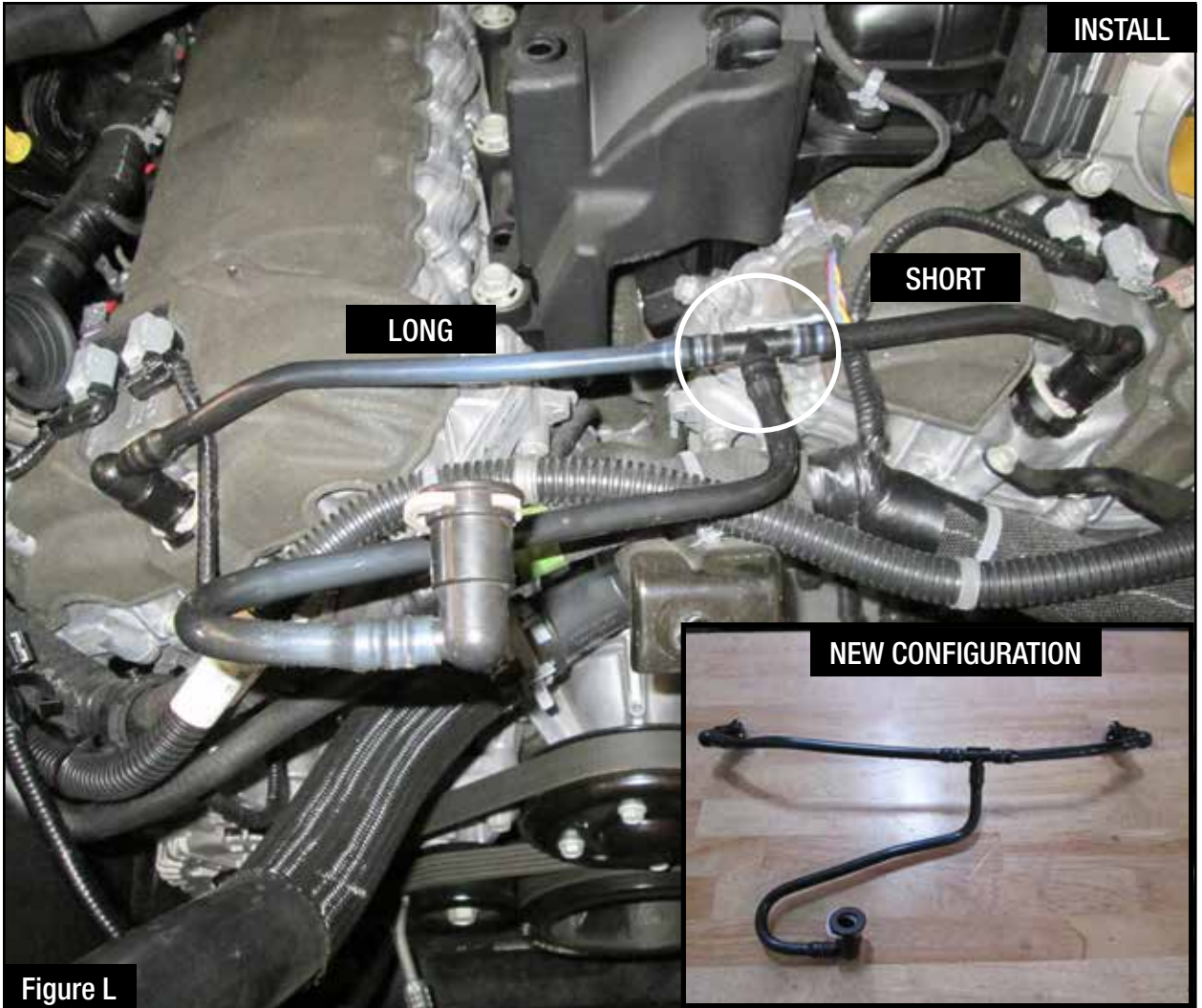

Figure K

Refer to Figure K for Step 12

Step 12: Disconnect the stock vent hose by pressing on the clips at both mounting locations and pulling up. ⑫



Refer to Figure L for Step 13

Step 13: Invert the direction of the vent hose by rotating the T connector and reversing the direction of the end fittings as shown. Replace the vent hose in its new configuration.



Figure M

Refer to Figure M for Step 14

Step 14: Install the aFe intake tube into the vehicle. Slide into the air filter first, then slide it into the coupler. Tighten all clamps.

INSTALL



Figure N

Refer to Figure N for Step 15

Step 15: Reconnect the larger vent hose to the intake tube and tighten the clamp.



Figure 0

Refer to Figure 0 for Step 16

Step 16: Reconnect the smaller breather hose by pressing the fitting onto the aluminum port on the aFe intake tube. Reconnect the MAF sensor.



Figure 0

Refer to Figure 0 for Step 17

Step 17: Use the provided plug (14) to close the additional air inlet if you want to completely seal the airbox. Best performance gain is obtained by having more flow (no plug). Check all the components are tight and secure. Your installation is now complete. Thank you for choosing aFe Power!

NOTE: Check all bolts, clamps, and connectors after 200 miles.



Page left blank intentionally

Page left blank intentionally



Pro DRY S Air Filter



P/N: 21-91092

Pro 5R Air Filter



P/N: 24-91092

Pro-GUARD 7 Air Filter



P/N: 72-91092

Pre-Filter



P/N: 28-10283

Pro DRY S Restore Kit



P/N: 90-59999

Blue Squeeze Restore Kit



P/N: 90-50501

Gold Squeeze Restore Kit



P/N: 90-50500

Side Exit Exhaust System



P/N: 49-44061-B (w/ Blk Tip)
49-44061-P (w/ Pol Tip)

Exhaust System



P/N: 49-44058-B (w/ Blk Tip)
49-44058-P (w/ Pol Tip)

Rear Differential Cover



P/N: 46-70302-WL (w/ Oil)
46-70302 (Black)

Sway-A-Way Front Coilovers



P/N: 501-5600-03

Sway-A-Way Rear Shocks

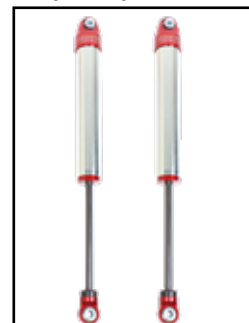

P/N: 502-0052-02

To purchase any of the items above, view airflow charts, dyno graphs, photos, and video; please go to aFepower.com.

Warranty

General Terms:

- aFe warrants their products to be free from manufacturer's defects due to workmanship and material.
- This warranty applies only to the original purchaser of the product and is non-transferrable.
- Proof of purchase of the aFe product is required for all warranty claims.
- Warranty is valid provided aFe instructions for installation and/or cleaning were properly followed.
- Proper maintenance with regular inspections of product is required to insure warranty coverage.
- Damage due to improper installation, abuse, unauthorized repair or alteration is not warranted.
- Incidental or consequential damages or cost, including installation and removal of part, incurred due to failure of aFe product is not covered under this warranty.
- All warranty is limited to the repair and/or replacement of the aFe part. To request Return Goods Authorization ("RGA"), email RGA@afepower.com or call (951)493-7100. Upon receipt of the RGA, you must return the product to the address provided in the RGA, freight prepaid and accompanied with a dated proof of purchase and the RGA. Upon receipt of the defective product and upon verification of proof of purchase, aFe will either repair or replace the defective product within a reasonable time, not to exceed thirty days.

Product Category	P/N Prefix	Warranty duration
Direct OE Replacement Filters	10, 11, 30, 31, 71, 73	Life of the vehicle
Racing Filters	18	1 year
Universal	21, 24, 72	2 years
Air Intake Systems	50, 51, 54, 55, 75	2 years
Exhaust Systems	49	2 years
Intercoolers & Intercooler Tubes	46-2	2 years
Intake Manifolds	46-1	2 years
Differential Cover	46-7	Life of the vehicle
Exhaust Manifolds	46	2 years
Throttle Body Spacers	46-3	2 years
Fluid Filters	44	90 days
Pre-Filters	28	2 years
Heavy Duty OE Replacement	70	2 years
PowerSports OE Replacement	81, 87	2 years
PowerSports Intake Systems	85	2 years

No other warranty expressed or implied applies nor is any person or advanced FLOW engineering authorized to assume any other warranty. Some States do not allow the exclusion or limitation of incidental or consequential damages or do not allow limitations on how long an implied warranty lasts, so the above limitations or exclusions may not apply to you. This warranty gives you specific legal rights, and you may also have other rights which vary from State to State.

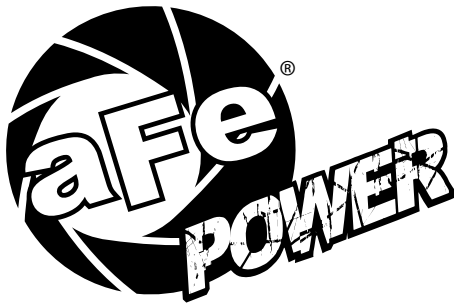

advanced FLOW engineering, inc.

252 Granite Street Corona, CA 92879

TEL: 951.493.7155 • TECH: 951.493.7100