

MOMENTUM **HD**

advanced FLOW engineering Momentum HD Stage-2 Cold Air Intake System

Instruction Manual P/N: 51-73003 / 50-73003

Make: Ford

Model: F-250/F-350/F-450/F-550

Year: 2003-2007

Engine: V8-6.0L (td)



- Please read the entire instruction manual before proceeding.
 - Ensure all components listed are present.
- If you are missing any of the components, call customer support at 951-493-7185.
 - Ensure you have all necessary tools before proceeding.
- Do not attempt to work on your vehicle when the engine is hot.
 - Retain factory parts for future use.

Label	Qty.	Description	Part Number
A1	1	Air Filter (Pro DRY S)	21-91061
A2	1	Air Filter (Pro 10R)	20-91061
B	1	Housing	05-73003B2
C	1	Tube 1	05-73003B1
D	1	Tube 2	05-00847
E	1	Coupling, Silicone Elbow: 4"ID x 33Deg	05-01597
F	1	Coupling, Straight: 4"ID x 2-1/2"L (Hi Temp)	05-00715
G	1	Clamp, T-bolt (8-5/16")	03-50267
H	4	Clamp, 064 (2-1/2"- 4-1/2 ")	03-50006
I	1	Plug, Airbox	05-01202
J	1	Plug, Temp Sensor	05-01228
K	1	Grommet, Rubber: 2872-26012	03-50139
L	1	T20 Torx bit	03-50066

Installation will require the following tools:

8mm nut driver, 10mm box-end wrench, 10mm socket and wrench, 11mm deep socket or hollow shaft nut driver, T20 Torx drivers, Needle-nose pliers, and Flat-head screwdriver.

Warranty Information available at <https://afepower.com/contact#warranty>

Emissions Disclaimer: This product is not currently CARB exempt and is not available for purchase in California or for use on any vehicle registered with the California Department of Motor Vehicles.

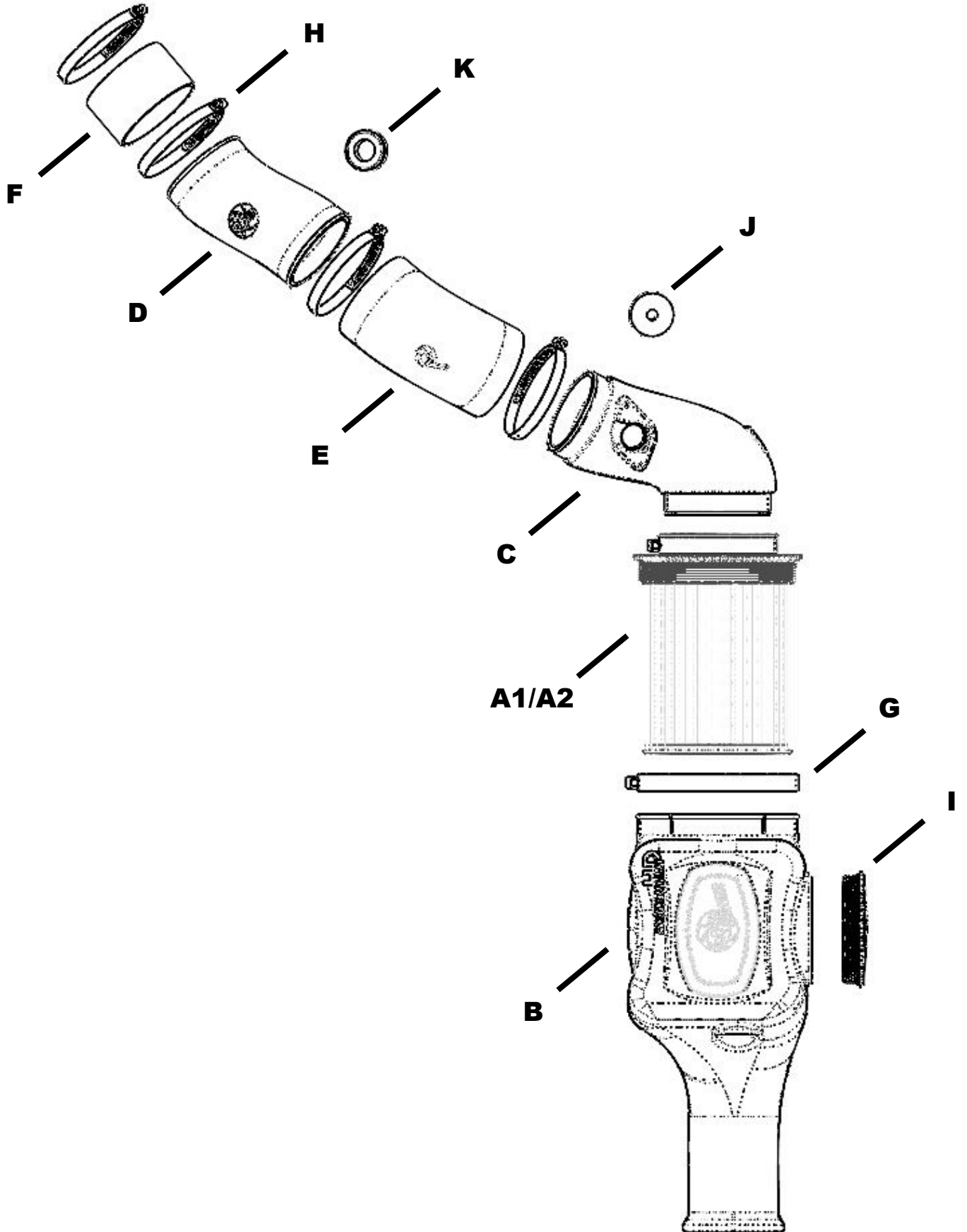

**Figure A****Refer to Figure A for Steps 1-2**

Warning! Do not proceed until the vehicle has cooled down all the way.

Step 1: Using pliers to squeeze the spring clamp, disconnect the coolant reservoir overflow line and tuck it out of the way so that no fluid can leak out ①.

Step 2: Using pliers to squeeze the spring clamp, disconnect the bypass tube on the front of the intake housing ②.



Figure B

Refer to Figure B for Steps 3-5

Step 3: Disconnect the MAF sensor connector from the MAF sensor ③.

Step 4: Remove the filter minder from the side of the intake tube ④. you do not need to disconnect the wire harness from the sensor.

Step 5: Loosen the clamp from intake tube ⑤

**Figure C****Refer to Figure C for Steps 6-7**

Step 6: Remove the intake housing by pull straight up out of its mounting grommets and then tilting it up as shown. The housing can be removed as one piece or in multiple pieces if desired.

Step 7: Using an 8mm nut driver or flat-blade screw driver, loosen the clamp that connects the intake tube to the turbo charger ⑥

Figure D

Refer to Figure D for Steps 8-11

Step 8: Using a 10mm socket, remove the two nuts on the intake tube bracket (7).

Step 9: Pull up on the intake tube to expose the pinch clamp on the Crank Case Vent (CCV) line. Using pliers or a flat-blade screwdriver, pry the pinch clamp apart just far enough to remove the CCV line from the intake tube (8).

Step 10: Remove the intake tube from the vehicle.

Step 11: With the tube out of the vehicle, remove the mounting bracket from the intake tube. The bracket will need to be reinstalled to the engine in a later step.

**Figure E****Refer to Figure E for Steps 12-13**

Step 12: Using the provided T20 Torx bit and a driver, remove the MAF sensor from the OE intake (9).

Step 13: Remove the grommet for the Filter Minder from the back of the OE intake housing (10).

**Figure F****Refer to Figure F for Steps 14-15**

Step 14: Using the provided T20 Torx, reinstall the MAF sensor into the new aFe intake tube as shown using the OE screws ⑪.

Step 15: Reinstall the OE grommet for the Filter Minder into the new aFe intake tube ⑫.

NOTE: If your vehicle is equipped with a temp sensor instead of a MAF sensor, then you will need to install the Temp Sensor Adaptor (05-01228). Insert the temp sensor into the temp sensor adaptor.



Figure G

Refer to Figure G for Step 16

Step 16: Install the new large grommet into the the new aFe intake tube.

**Figure H****Refer to Figure H for Steps 17-19**

Step 17: Place two of the smaller clamps over the straight coupling provided.

Step 18: Install the straight coupling and clamps onto the turbo as shown (13).

Step 19: Install the shorter aFe intake tube into the coupling and then press the CCV line into the grommet on the bottom of the intake tube (14).

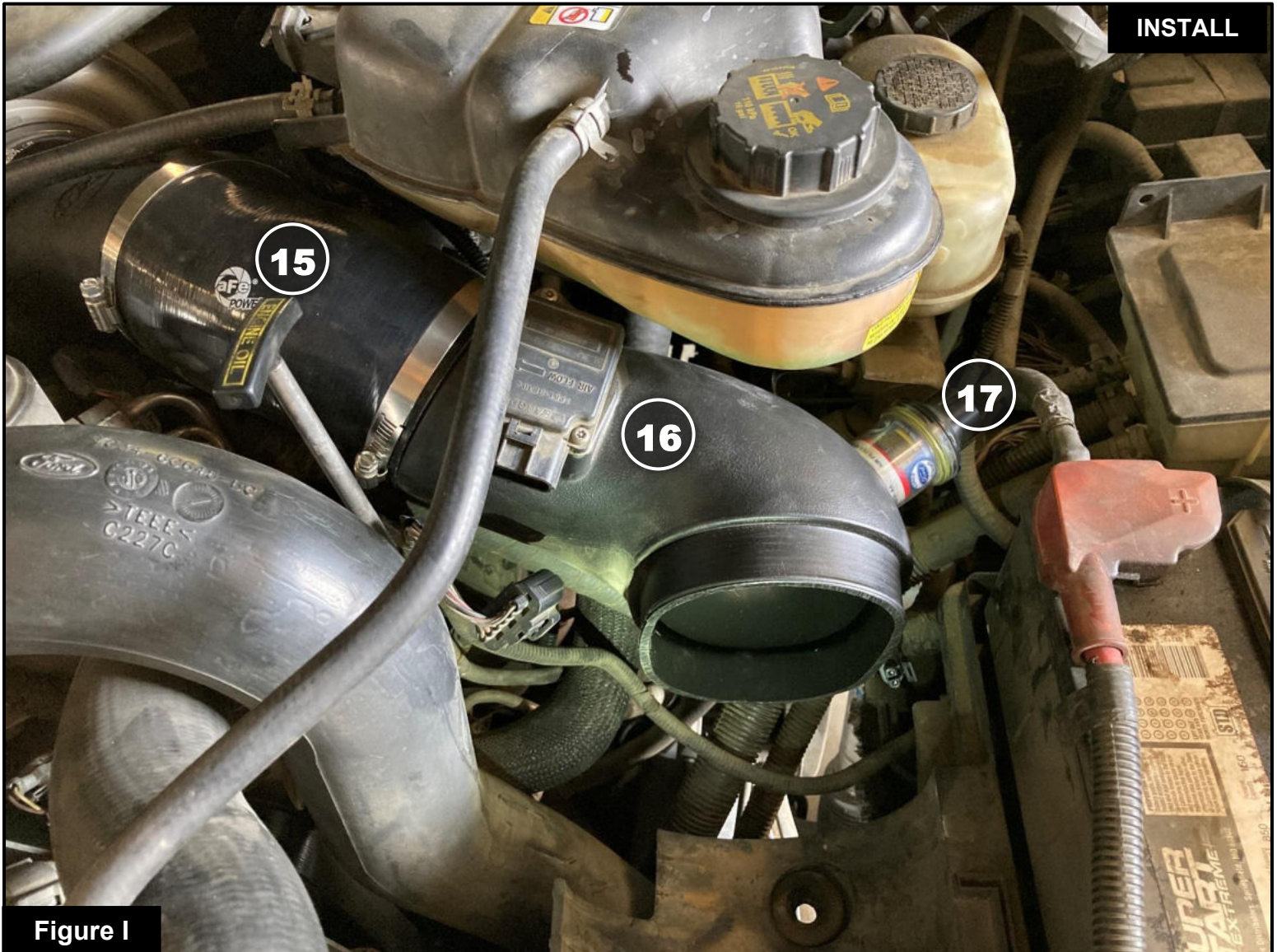
**Figure I****Refer to Figure I for Steps 20-23**

Step 20: Place two of the smaller clamps over the ends of the longer elbow coupling, and install the longer coupling onto the already installed aFe intake tube as shown (15).

Step 21: Install the second aFe intake tube into the longer coupling that was just installed as shown. Leave all clamps loose at this time (16).

Step 22: Install the filter minder into the grommet on the back side of the intake tube. If needed, hold the grommet from the inside of the intake tube so that it does not push through the hole on the tube (17).

Step 23: Reconnect the coolant overflow line and make sure the spring clamp is secure.

**Figure J****Refer to Figure J for Steps 24-25**

Step 24: Place the large T-Bolt clamp loosely over the flange of the aFe intake housing.

Step 25: Install the new aFe air filter into the aFe housing and position the clamp as shown.

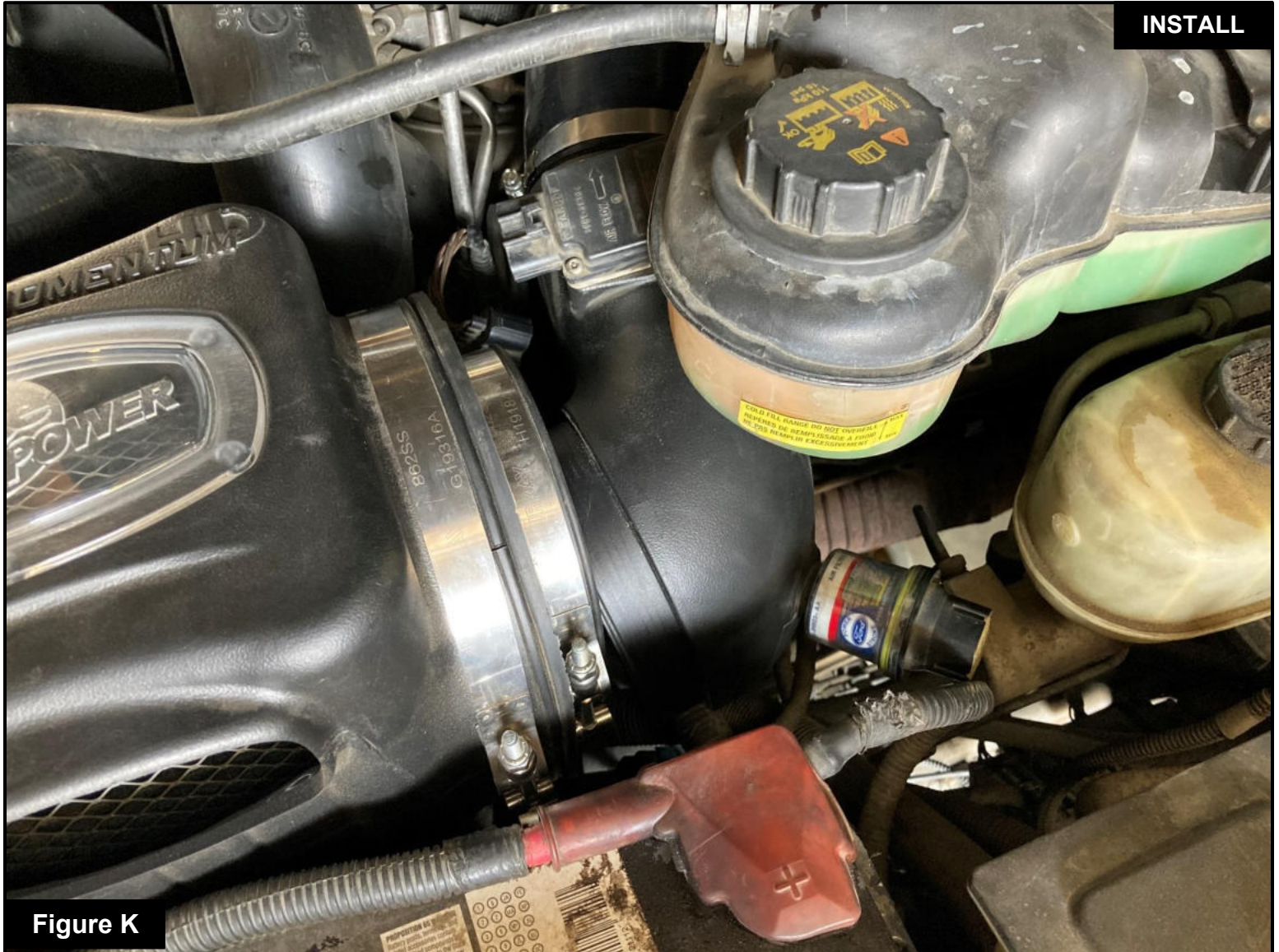
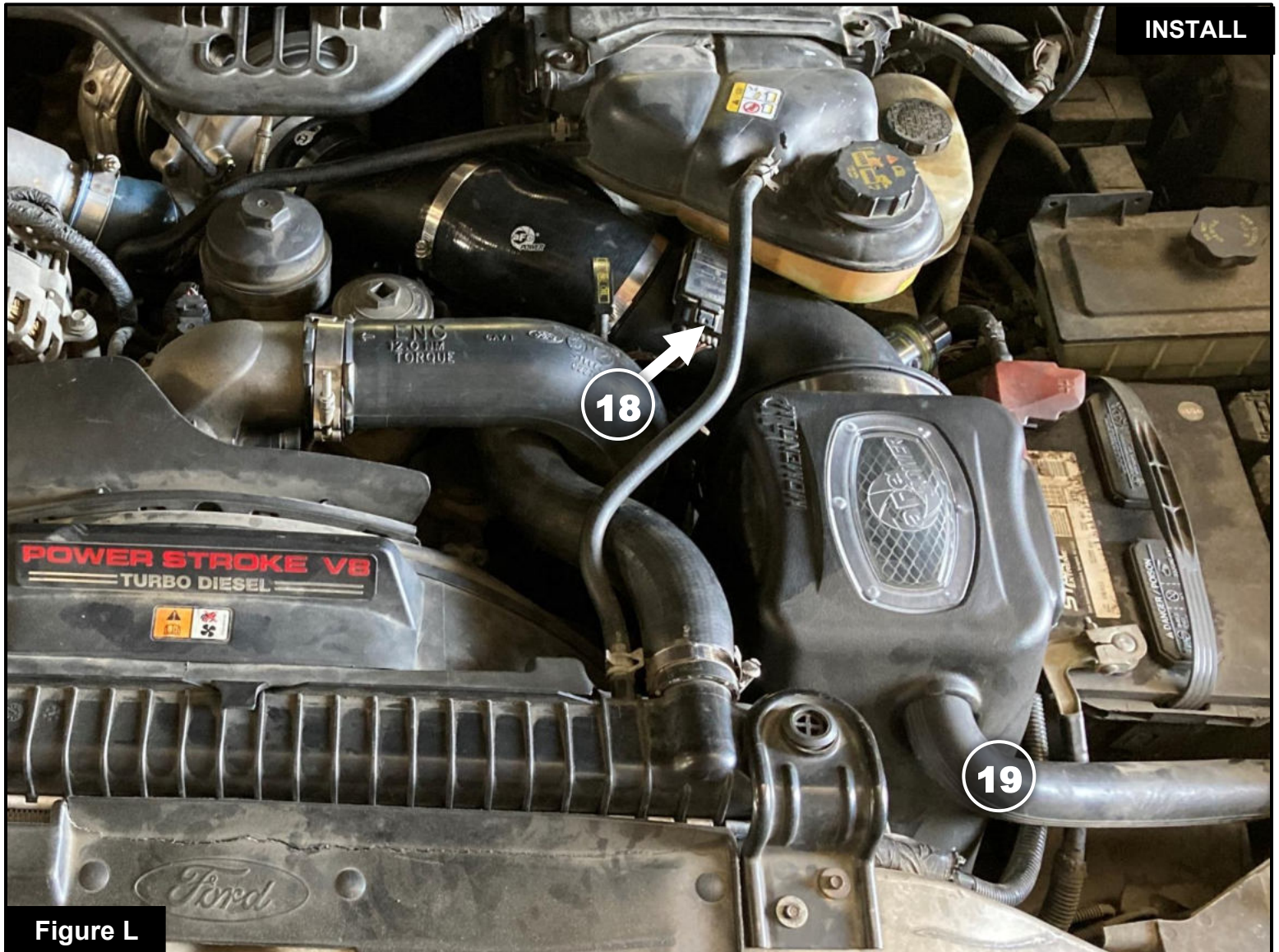

Figure K

Refer to Figure K for Steps 26-28

- Step 26: With all of the clamps still loose, push the aFe intake tube underneath the coolant reservoir so there is room to install the aFe intake housing and air filter assembly.
- Step 27: Install the aFe intake housing into the vehicle by dropping the front through the core support and then aligning the mounting pegs on the bottom of the housing with the mounting grommets on the mounting tray.
- Step 28: Push the aFe intake tube into the aFe filter and position the tube so that it does not touch the coolant reservoir.



INSTALL

Figure L

Refer to Figure L for Steps 29-33

Step 29: Tighten all (6) six clamps at this time.

Step 30: Reconnect the MAF sensor harness to the MAF sensor (18).

Step 31: Reconnect the breather hose to the front of the aFe intake housing as shown (19).

Step 32: (Optional) Install the included airbox plug on the side of the housing to create a sealed air box.

Step 33: Check all the components are tight and secure. Your installation is now complete. Thank you for choosing aFe POWER!

NOTE: Check all screws, clamps, and connectors are secure after 100-200 miles.



advanced FLOW engineering, inc.

252 Granite Street Corona, CA 92879
TEL: 951.493.7100 • TECH: 951.493.7185
E-Mail: Tech@aFepower.com

P/N: 06-80536