

HD
MOMENTUM

advanced FLOW engineering

Cold Air Intake System

Instruction Manual P/N: 50-70098D/50-70098T

Make: TOYOTA Model: LAND CRUISER (J300)* Year: 2022-2023 Engine: V6-3.3L(td)

* Non-US Model



- Please read the entire instruction manual before proceeding.
- Ensure all components listed are present.
- If you are missing any of the components, call customer support at 951-493-7185.
- Ensure you have all necessary tools before proceeding.
- Do not attempt to work on your vehicle when the engine is hot.
- Retain factory parts for future use.

Label	Qty.	Description	Part Number
A	1	Air Filter (Pro 5R) For 50-70098T	20-91208T
A	1	Air Filter (Pro DRY S) For 50-70098D	20-91208D
B	1	Tube	05-5070098B1
C	1	Housing	05-5070098B2
D	1	Gasket, Inlet	05-01711
E	1	Plug, Silicone: 2.25" Dia	05-01482
F	1	Coupling, Silicone	05-01599
G	2	Clamp, 048 (2-9/16" - 3-1/2 ")	03-50007
H	2	Screw, Torx: M4 x 10mm	03-50490
J	2	Ties, Nylon Cable Push Mount: 1/4"OD x 8"L Black	03-50492
K	2	Alcohol Wipes	05-01716

Installation will require the following tools:

8mm, 10mm and 11mm Nut Drivers or Ratchet and Sockets, Flat Head and Phillips Screwdriver, T20 Torx Driver.

Warranty Information available at: <https://afepower.com/contact#warranty>

Emissions Disclaimer: This product does not require a CARB EO# (Vehicle does not exist in U.S.)

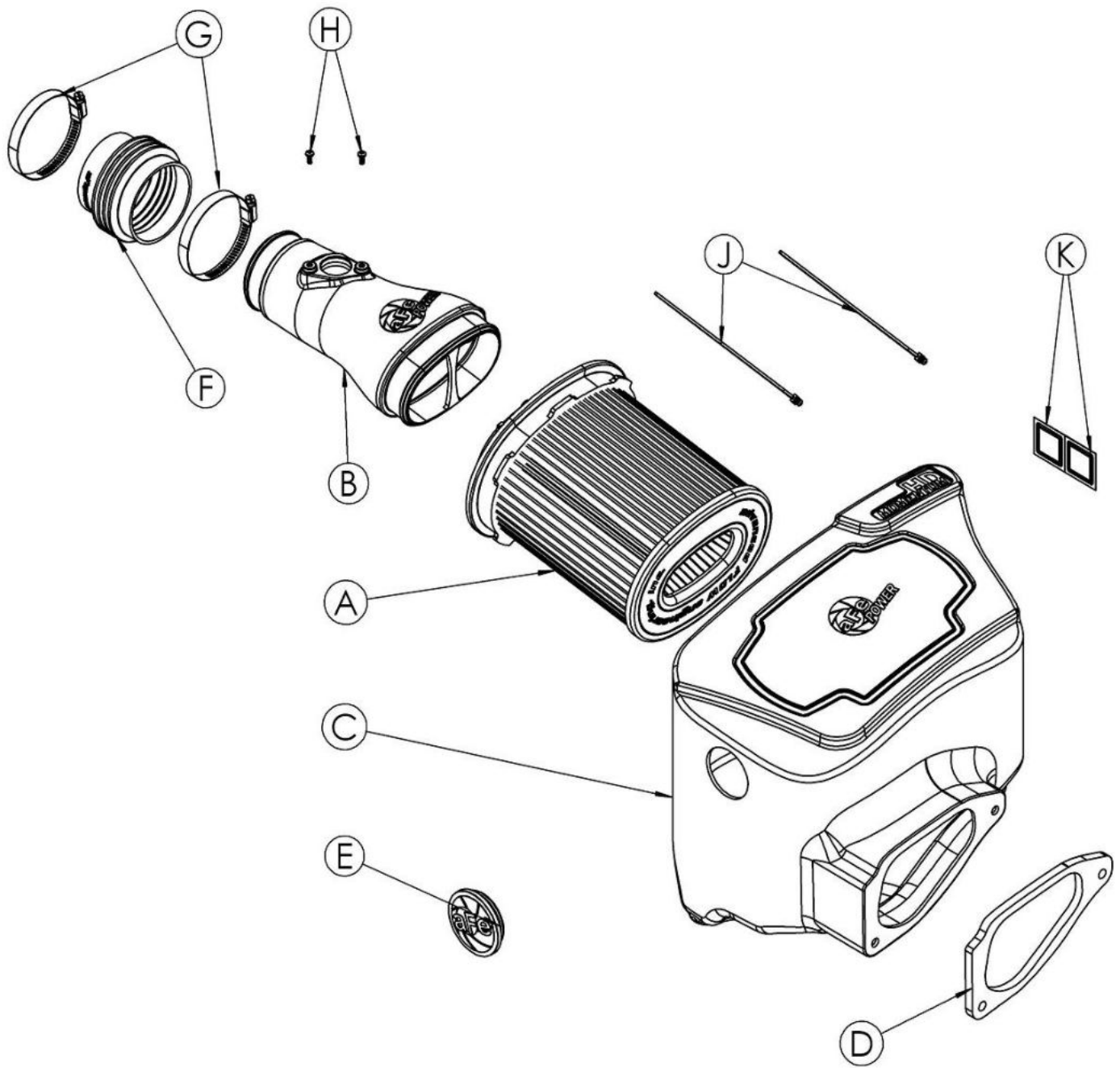

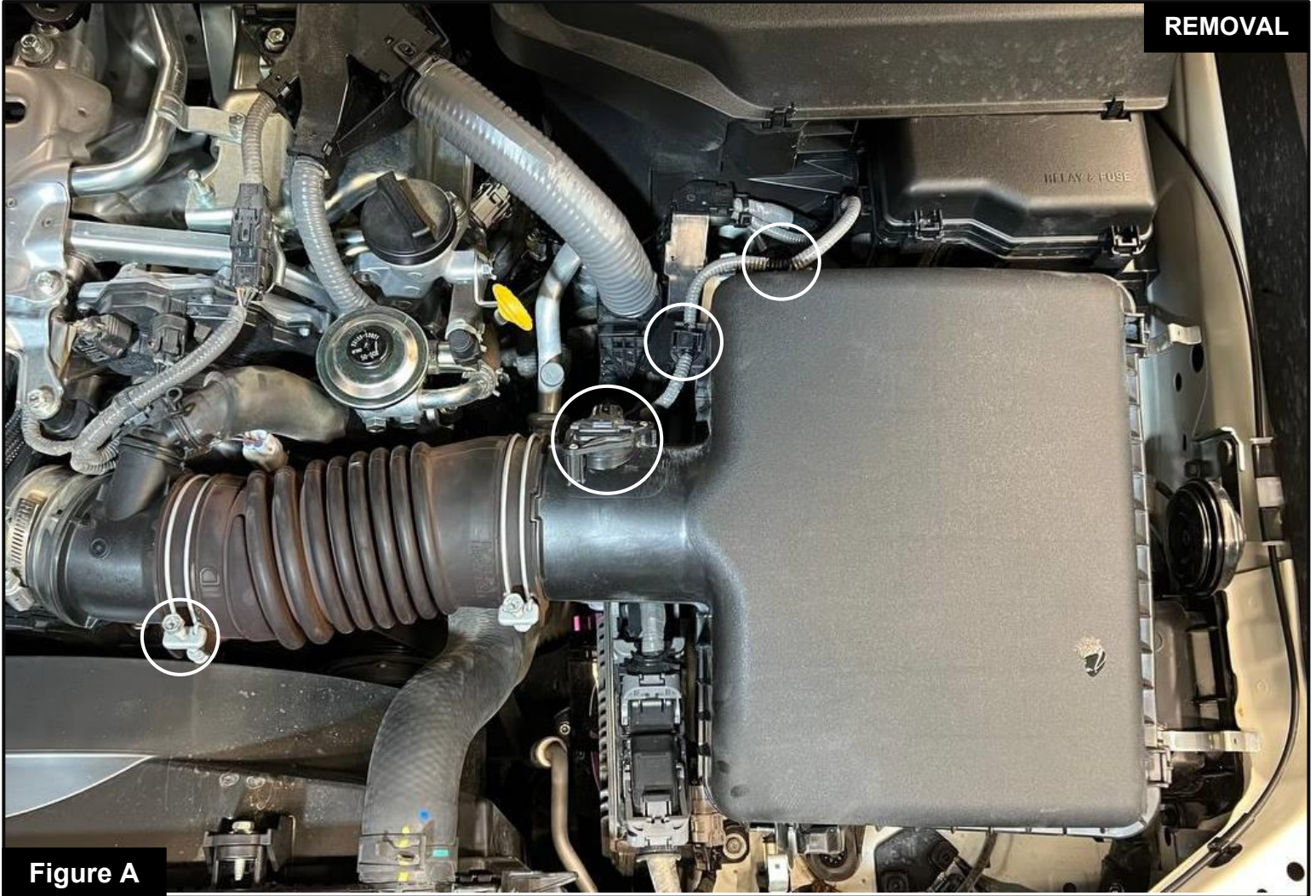
**Figure A****Refer to Figure A for Steps 1-3**

Step 1: Disconnect the Mass Air Flow (MAF) sensor and unclip the harness from the airbox.

Step 2: Using a 10mm socket or nut driver, loosen the clamp securing the intake tube to the turbo inlet.

Step 3: Lift the air intake assembly from the vehicle by firmly pulling the grommets out of the mounts.

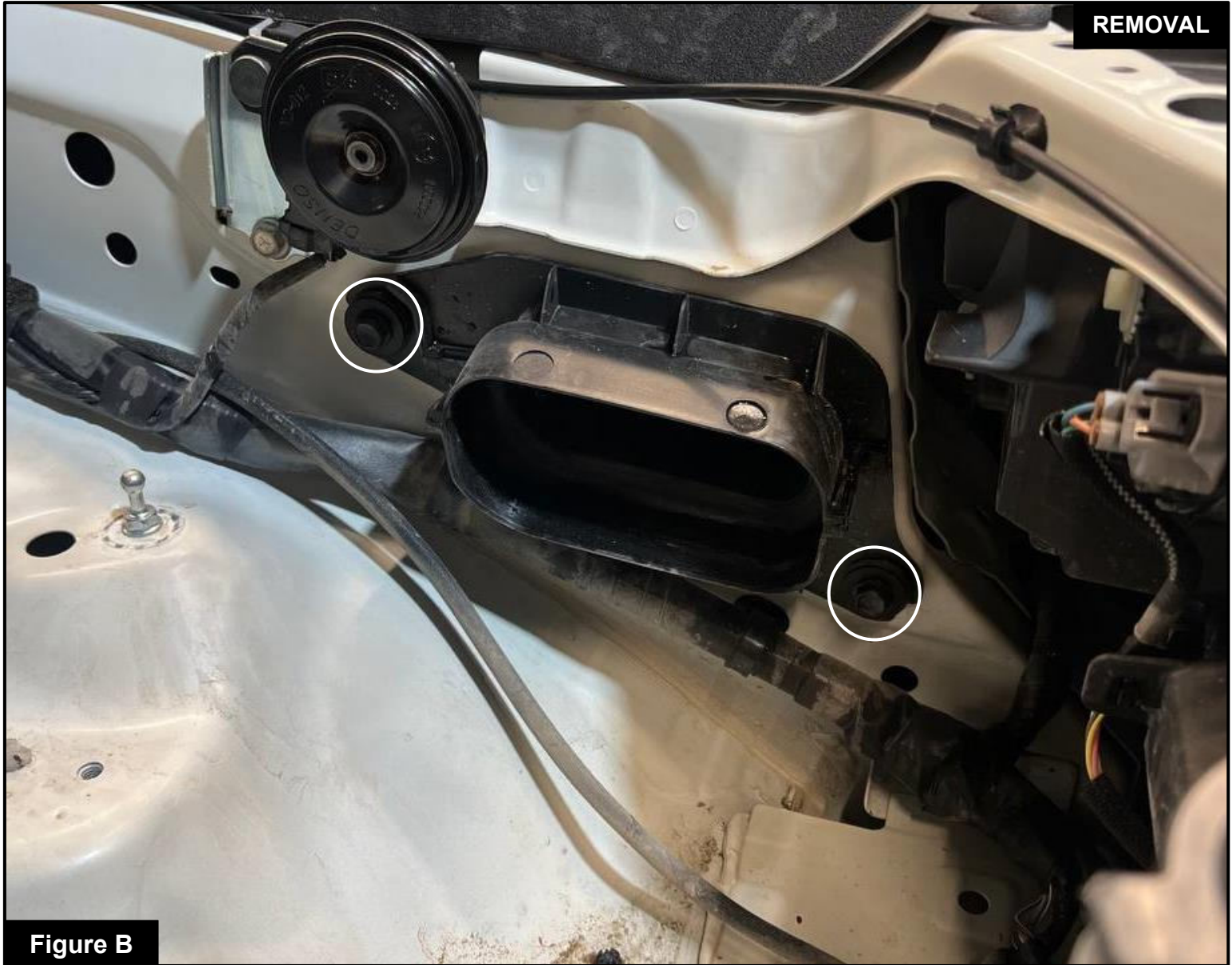

Figure B

Refer to Figure B for Step 4

Step 4: Remove the two 10mm bolts securing the air inlet duct, then remove the duct from the vehicle. Both of these bolts will be reused.



Figure C

Refer to Figure C for Step 5

Step 5: Transfer the grommets from the bottom of the factory air box to the aFe POWER housing.



Figure D

Refer to Figure D for Step 6

Step 6: Wipe the non-textured surface of the air inlet with the provided cleaning wipe to remove any contaminants. Once all alcohol has evaporated, apply the foam gasket onto the surface of the air inlet.

**Figure E****Refer to Figure E for Steps 7-8**

Step 7: Install the aFe POWER air box into the vehicle by pushing the housing onto the three mounting pegs. Then secure it using the screws removed in Step 4. These screws will be installed from the inside of the housing.

Step 8: Install the air filter by firmly pushing it into the housing until the filter tabs lock into place. Install the clamp onto the filter but do not tighten it at this time.



Figure F

Refer to Figure F for Step 9

Step 9: Loosely install the clamps onto the aFe POWER coupling. Then install the coupling onto the turbo inlet. Do not tighten the clamps at this time.

**Figure G****Refer to Figure G for Step 10**

Step 10: Transfer the MAF sensor from the factory intake to the aFe POWER intake tube and secure it with the provided M4 screws using a T20 Torx.

**Figure H****Refer to Figure H for Steps 11-12**

Step 11: Install the aFe POWER intake tube between the coupling and filter. Align the tube and coupling, then tighten all clamps.

Step 12: Connect the MAF sensor harness to the MAF sensor, then secure the MAF harness to the housing and tube using the provided cable ties with push clips.

**Figure Q**

Refer to Figure Q for Step 13

Step 13: The kit includes optional plug to close off the auxiliary air inlet. Install the plug if you wish to close off the auxiliary air inlet to only capture cold air from the fender.

- Without the plug installed, the aFe POWER intakes will capture the maximum amount of air available. More airflow offers more power, yet some of the air picked up from inside the engine compartment could be warmer air. The warmer air will affect the performance of the vehicle.
- The plug installed on the housing will block off any hot engine air entering the housing to make sure that the coolest air available is directed into the engine. Intake noise will also be reduced if using the plug.

**Figure R****Refer to Figure R for Step 14**

Step 14: Make sure all clamps and connections are secured. Your installation is now complete. Thank you for choosing aFe POWER!



PAGE LEFT BLANK INTENTIONALLY



PAGE LEFT BLANK INTENTIONALLY



advanced FLOW engineering, Inc.

252 Granite Street Corona, CA 92879

<https://afepower.com/contact>