

advanced FLOW engineering Momentum Cold Air Intake System

Instruction Manual P/N: 56-70025D / 56-70025R

Make: Nissan Model: Altima Year: 19-20 Engine: I4-2.5L



- Please read the entire instruction manual before proceeding.
- Ensure all components listed are present.
- If you are missing any of the components, call customer support at 951-493-7185.
- Ensure you have all necessary tools before proceeding.
- Do not attempt to work on your vehicle when the engine is hot.
- Retain factory parts for future use.

| Label | Qty. | Description | Part Number |
|-------|------|--|--------------|
| A1 | 1 | Air Filter (Pro 5R) | 24-91103 |
| A2 | 1 | Air Filter (Pro DRY S) | 21-91103 |
| B | 1 | Tube | 05-5670025B1 |
| C | 1 | Housing | 05-5670025B2 |
| D | 1 | Coupling, Silicone Bellow:(3.5"x2.75")ID x 4"L | 05-01538 |
| E | 2 | Clamp, 052 (2-13/16" – 3-3/4") | 03-50008 |
| F | 2 | Screw, Torx: M4 | 05-50491 |
| G | 1 | Torx Bit: T20 | 03-50066 |
| H | 1 | Silicone Plug | 05-01527 |

Installation will require the following tools:

T-20 Torx driver, 8mm nut driver, small flat-head screwdriver, Philips screwdriver, 10mm deep socket, extension and ratchet.

Emissions Disclaimer: This product is not currently CARB exempt and is not available for purchase in California or for use on any vehicle registered with the California Department of Motor Vehicles

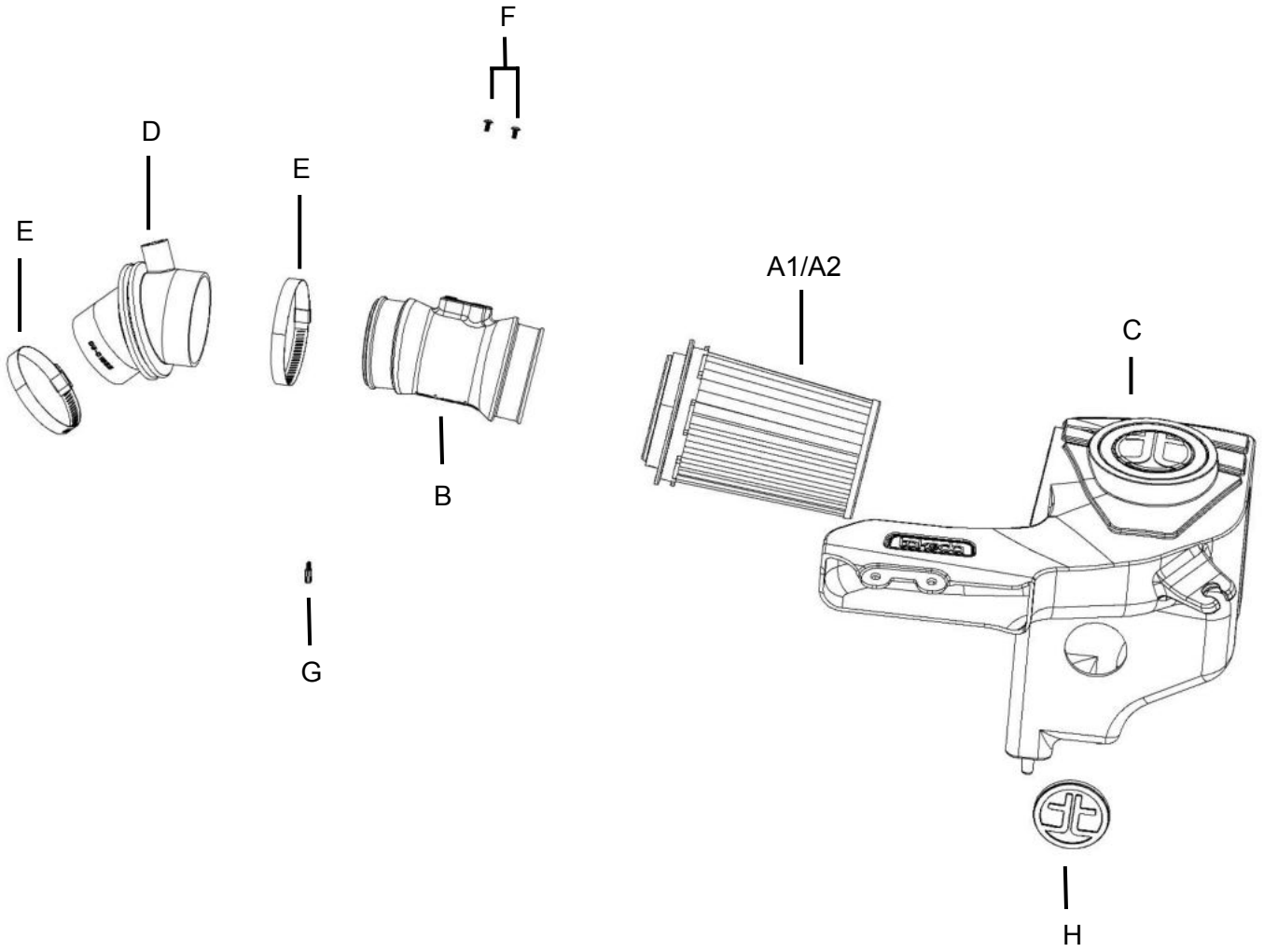

**Figure A****Refer to Figure A for Step 1**

Step 1: With a small flat head screwdriver remove the 12 push clips ①, then pull front cover out of vehicle.

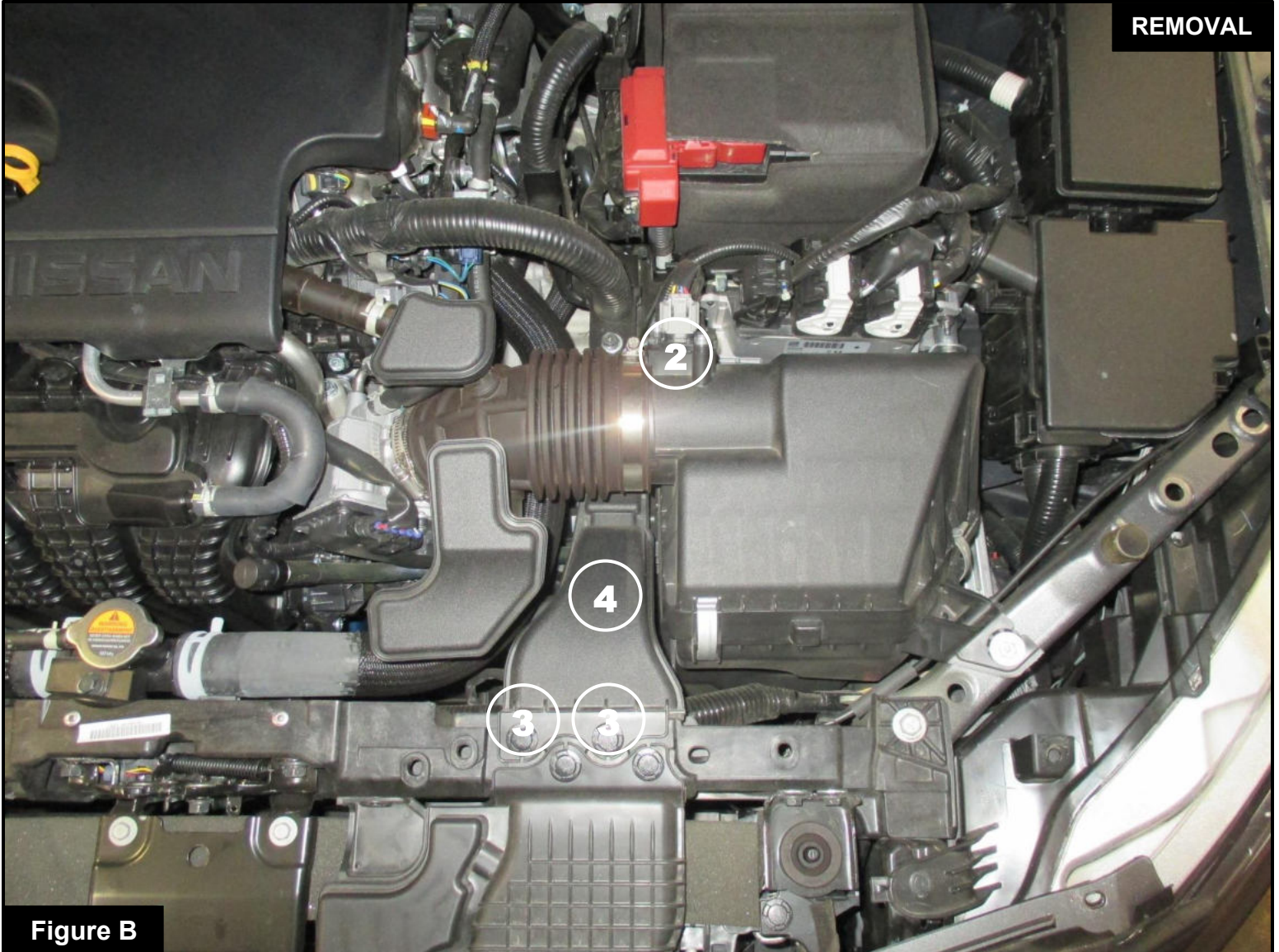
**Figure B****Refer to Figure B for Steps 2-4**

Step 2: Disconnect the Mass Air Flow (MAF) ② harness from the sensor and unclip it from factory air box.

Step 3: Remove the two push clips ③ on the front of the factory air scoop. These clips will be reused for installation of Takeda intake.

Step 4: Remove the factory air scoop out of the vehicle ④.

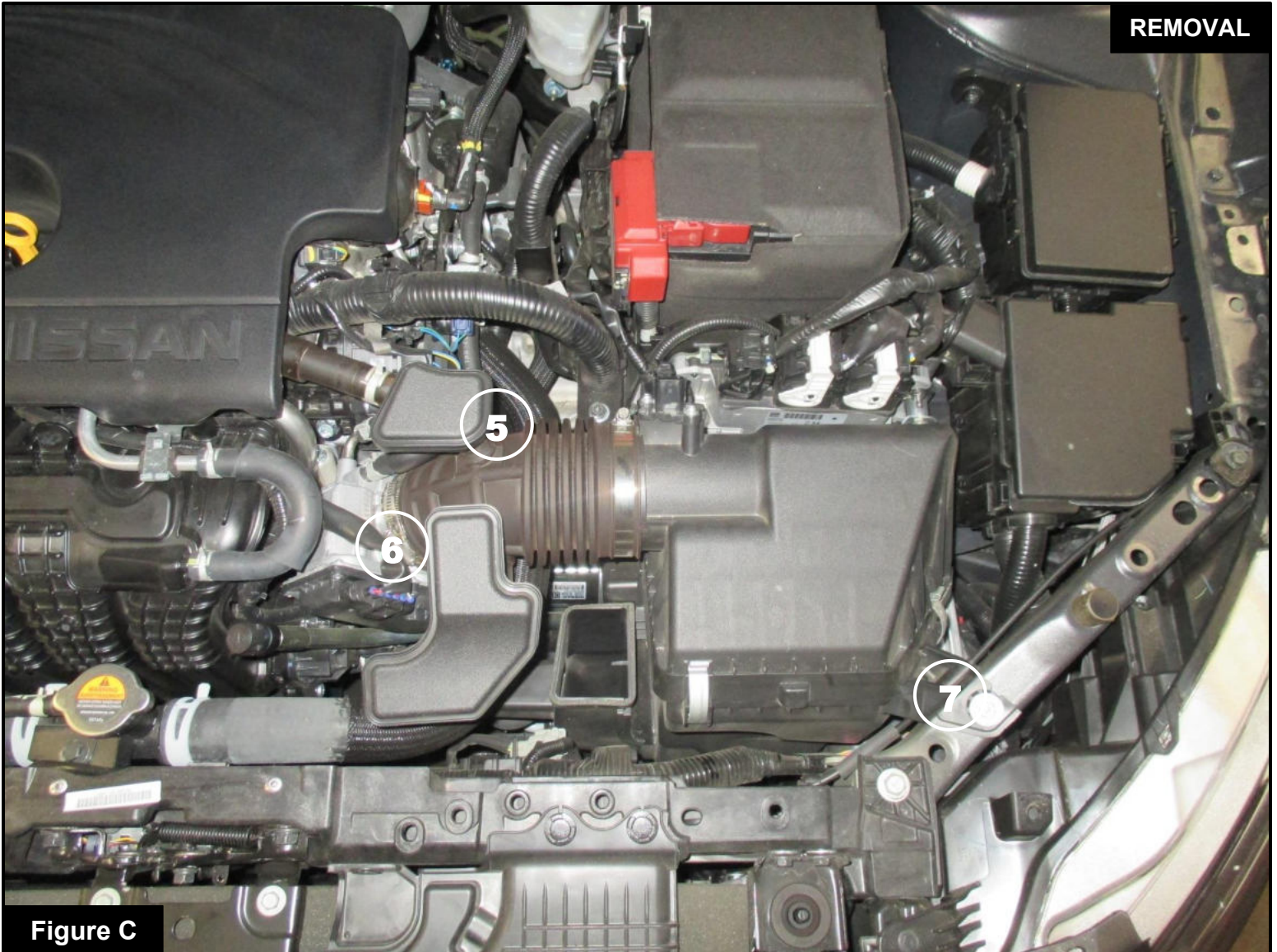
Figure C

Refer to Figure C for Steps 5-8

Step 5: Loosen the clamp on the factory intake tube connecting to the crank case fitting and disconnect the fitting from the intake tube (5).

Step 6: Loosen the clamp on the intake tube connecting to the throttle body (6).

Step 7: Remove the 10mm screw securing the factory housing (7). This screw will be reused to secure Takeda airbox.

Step 8: Remove the factory intake by pulling it out of the factory grommets.

**Figure D****Refer to Figure D for Steps 9-10**

Step 9: Transfer the factory grommets with metal sleeves (8) from the factory airbox onto the Takeda airbox.

Step 10: Slide the Takeda air filter into the airbox, assure the filter tabs are locked on the airbox. Place clamp on the filter but do not tighten at this time (9).

**Figure E****Refer to Figure E for Step 11**

Step 11: The kit includes an optional plug to close off the side auxiliary air inlet. Install the plug if you wish to close off the side auxiliary air inlet and only capture cold air from the front.

- Without the plug installed, the Takeda intake will capture the maximum air available. More airflow offers more power. Yet some of this air is picked up from inside the engine compartment and could be warmer air. Warmer air will affect the performance of the vehicle.
- The plug installed on the housing will block off any hot engine air entering the housing and make sure the coolest air available is directed into the engine. It will also reduce the noise of the intake.

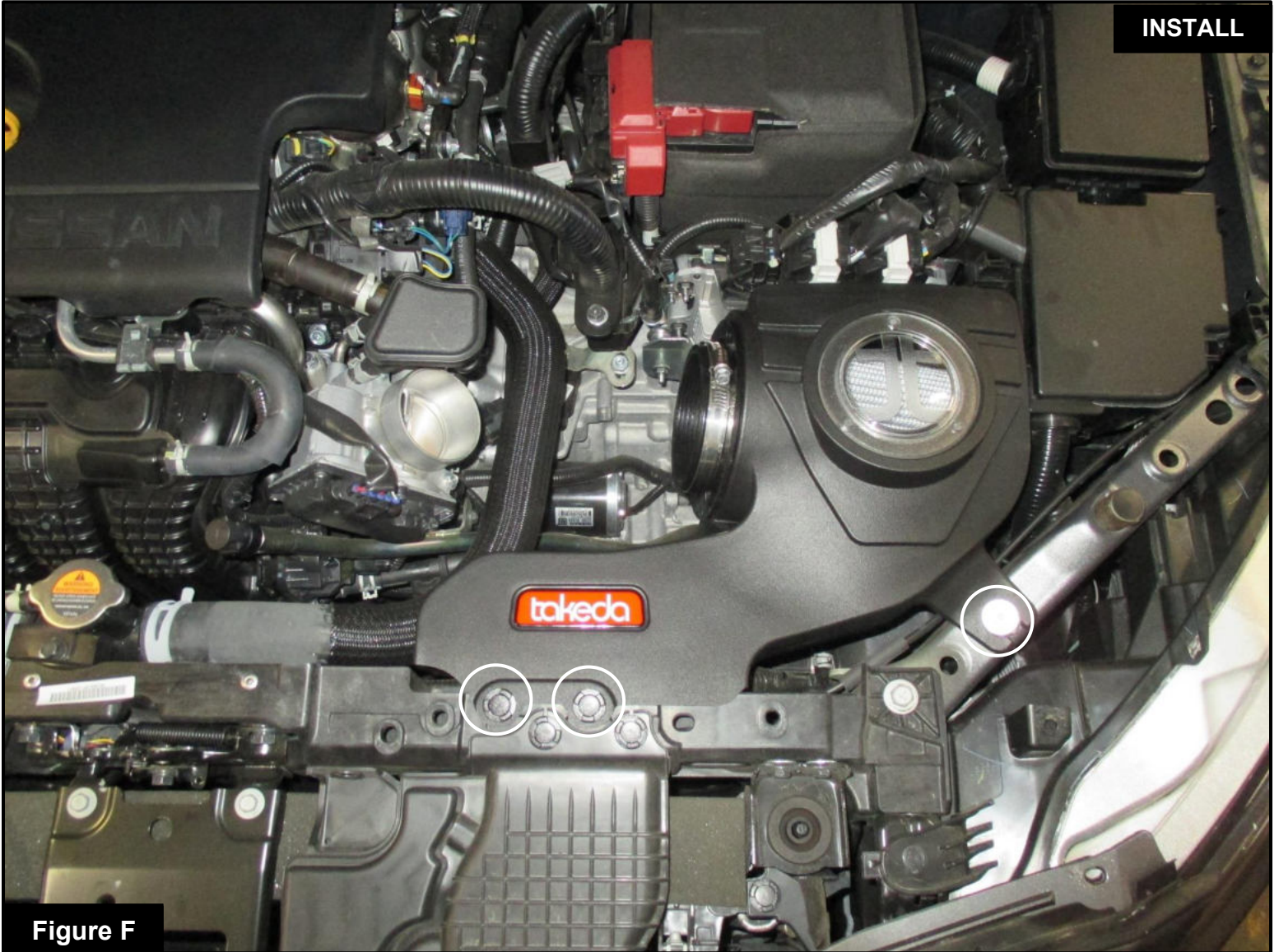
**Figure F****Refer to Figure F for Steps 12-13**

Step 12: Install the Takeda airbox into the vehicle by locating it on the factory grommets already in the vehicle. Secure it with the factory screw removed at step 7.

Step 13: Secure the airbox scoop with the factory push clips removed at step 3.

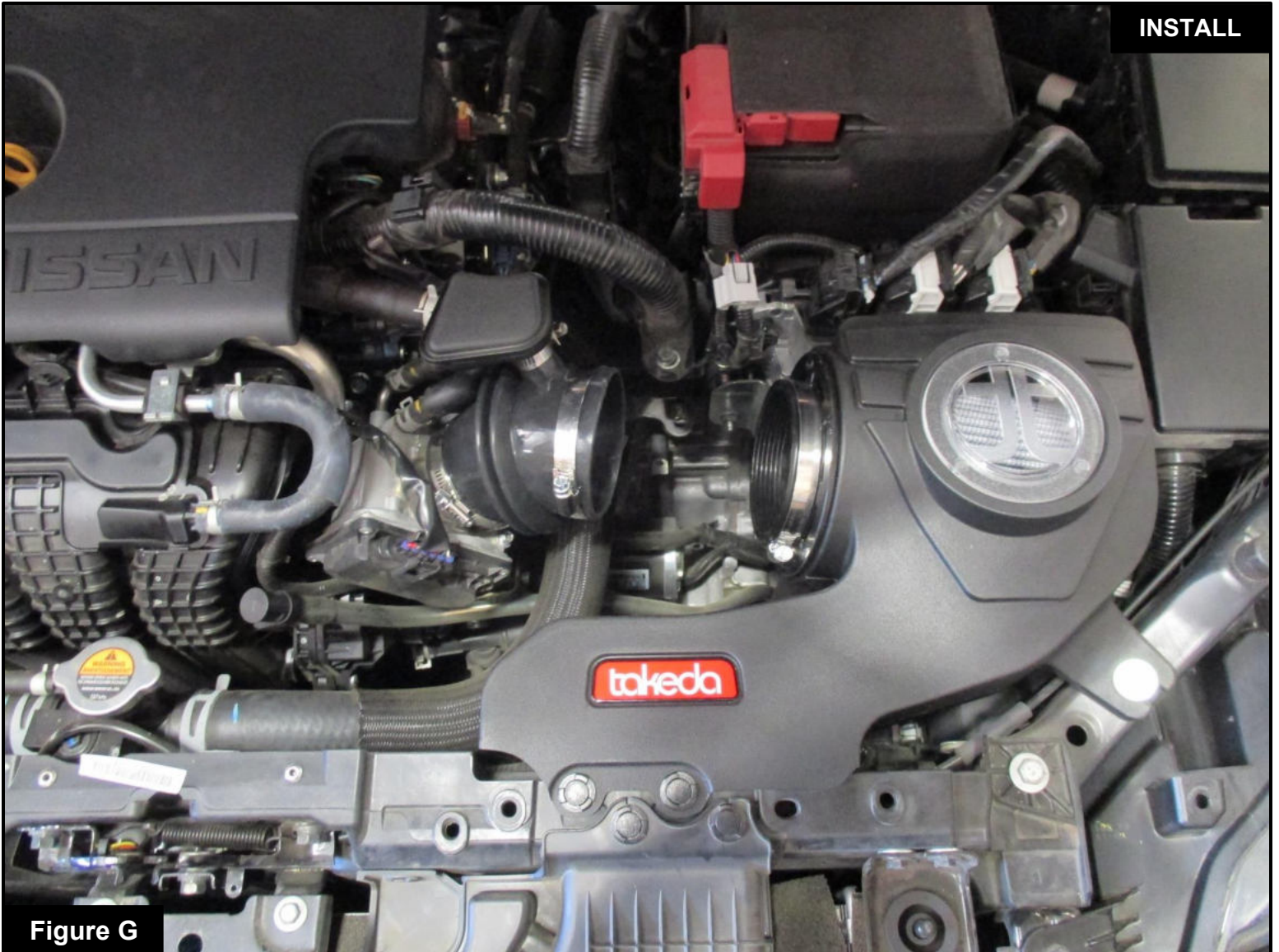
**Figure G****Refer to Figure G for Steps 14-16**

Step 14: Slide the coupling with clamps onto the throttle body. Make sure smaller side is on throttle body. Do not tighten clamps at this time.

Step 15: Transfer the factory mini clamp from factory intake tube to the Takeda coupling port.

Step 16: Insert the crank case fitting into the Takeda coupling and secure it with factory clamp.

**Figure H****Refer to Figure H for Step 17**

Step 17: Transfer the MAF sensor from the factory housing to the Takeda intake tube. Secure it with the M4 screws provided.

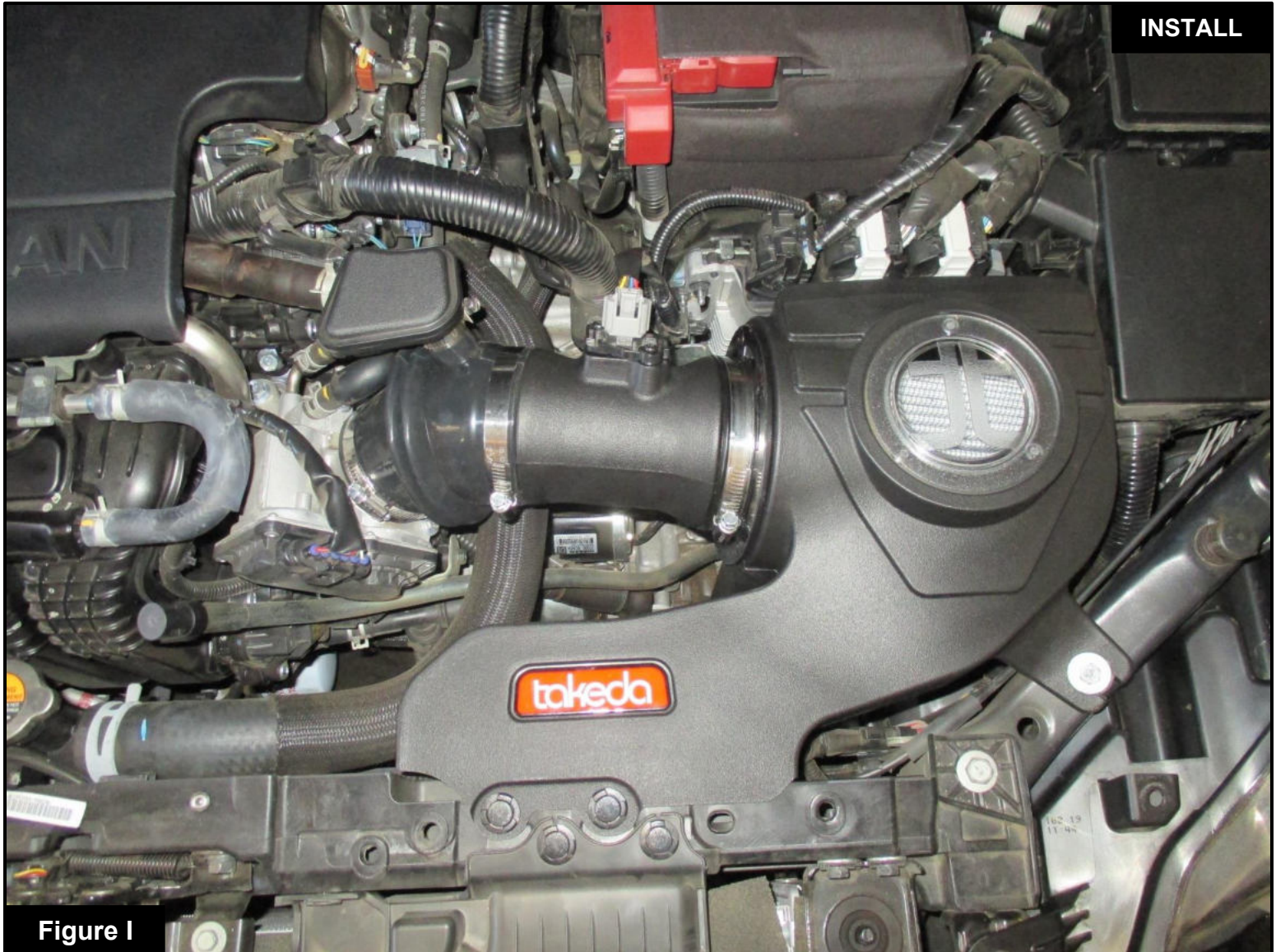

Refer to Figure I for Steps 18-20

Step 18: Slide the intake tube into the air filter then into the coupling. Align coupling, tube and air filter then tighten all clamps.

Step 19: Re-connect MAF sensor harness.

Step 20: Make sure all clamps and connections are secured.

**Figure J****Refer to Figure J for Step 21**

Step 21: Reinstall the front cover and secure it with the factory push clips. Your installation is now completed.

NOTE: Check all bolts, clamps and connectors after 100-200 miles

Pro DRY S Air Filter



P/N: 24-91103

Pro 5R Air Filter



P/N: 24-91103

Pre-Filter



P/N: 28-10083

Blue Squeeze Restore Kit



P/N: 90-50501

Pro DRY S Restore Kit



P/N: 90-59999

To purchase any of the items above, view airflow charts, dyno graphs, photos, and video; please go to aFepower.com.



Warranty

General Terms:

- aFe warrants their products to be free from manufacturer's defects due to workmanship and material.
- This warranty applies only to the original purchaser of the product and is non-transferrable.
- Proof of purchase of the aFe product is required for all warranty claims.
- Warranty is valid provided aFe instructions for installation and/or cleaning were properly followed.
- Proper maintenance with regular inspections of product is required to insure warranty coverage.
- Damage due to improper installation, abuse, unauthorized repair or alteration is not warranted.
- Incidental or consequential damages or cost, including installation and removal of part, incurred due to failure of aFe product is not covered under this warranty.
- All warranty is limited to the repair and/or replacement of the aFe part. To request Return Goods Authorization ("RGA"), email RGA@afepower.com or call (951)493-7100. Upon receipt of the RGA, you must return the product to the address provided in the RGA, freight prepaid and accompanied with a dated proof of purchase and the RGA. Upon receipt of the defective product and upon verification of proof of purchase, aFe will either repair or replace the defective product within a reasonable time, not to exceed thirty days.

| Product Category | P/N Prefix | Warranty duration |
|----------------------------------|--|---------------------|
| Direct OE Replacement Filters | 10, 11, 30, 31, 71, 73 | Life of the vehicle |
| Racing Filters | 18 | 1 year |
| Universal | 20, 21, 23, 24, 72, TF | 2 years |
| Air Intake Systems | 50, 51, 53, 54, 55, 56, 57, 58, 75, TR, TA, TL, TM | 2 years |
| Exhaust Systems | 49 | 2 years |
| Intercoolers & Intercooler Tubes | 46-2 | 2 years |
| Intake Manifolds | 46-1 | 2 years |
| Differential Cover | 46-7 | Life of the vehicle |
| Exhaust Manifolds | 46 | 2 years |
| Throttle Body Spacers | 46-3 | 2 years |
| Turbochargers | 46-6 | 2 years* |
| Fluid Filters | 44 | 90 days |
| Pre-Filters | 28 | 2 years |
| Heavy Duty OE Replacement | 70 | 2 years |
| PowerSports OE Replacement | 81, 87 | 2 years |
| PowerSports Intake Systems | 85 | 2 years |

No other warranty expressed or implied applies nor is any person or advanced FLOW engineering authorized to assume any other warranty. Some States do not allow the exclusion or limitation of incidental or consequential damages or do not allow limitations on how long an implied warranty lasts, so the above limitations or exclusions may not apply to you. This warranty gives you specific legal rights, and you may also have other rights which vary from State to State.

*See turbocharger warranty for more info



advanced FLOW engineering, inc.

252 Granite Street Corona, CA 92879
TEL: 951.493.7100 • TECH: 951.493.7185
E-Mail: Tech@aFepower.com

P/N: 06-81371