

advanced FLOW engineering

Instruction Manual P/N: TM-2013B-D / TM-2013B-R Stage-2 Air Intake

Make: **Scion**

Model: **FR-S**

Year: **2013-2016** Engine: **H4-2.0L**

Make: **Subaru**

Model: **BRZ**

Year: **2013-2020** Engine: **H4-2.0L (includes tS)**

Make: **Toyota**

Model: **86/GT86/FT86**

Year: **2012-2020** Engine: **H4-2.0L**



- Please read the entire instruction manual before proceeding.
- Ensure all components listed are present.
- If you are missing any of the components, call customer support at 951-493-7100.
- Ensure you have all necessary tools before proceeding.
- Do not attempt to work on your vehicle when the engine is hot.
- Disconnect the negative battery terminal before proceeding.
- Retain factory parts for future use.

Label	Qty.	Description	Part Number
A1	1	Air Filter (Pro DRY S)	R21-91089 (Grey Media)
A2	1	Air Filter (Pro 5R)	R24-91089 (Blue Media)
B	1	Tube	05-T2013B1
C	1	Housing	05-T2013B2
D	1	Coupling 3"ID x 2-1/4"L	05-01245
E	2	Clamp, 048	03-50007
F	1	Grommet	03-50033
G	1	Coupling 1-1/2"ID x 2"L	05-01198
H	1	Clamp, 096	03-50003
I	2	Screw, M4 x .7 x 8	03-50034
J	1	Isolation Mount	03-50063
K	1	Washer, Flat	03-50065
L	1	Clamp, T-Bolt	03-50266
M	1	Nut, M8 x 1.25	03-50403

Installation will require the following tools:

Phillips screw driver, 8mm nut driver, ratchet, extension, 10mm/12mm socket & pliers

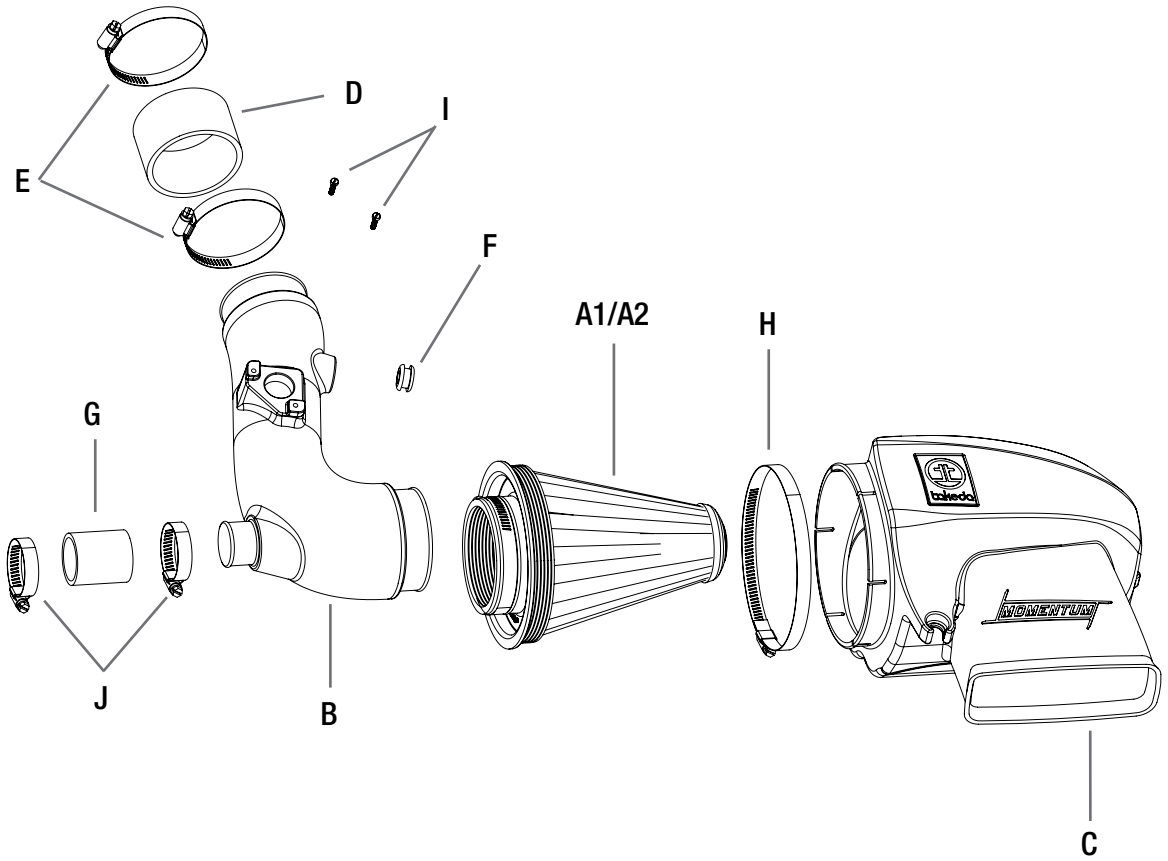



Figure A

Refer to Figure A for steps 1-5

Step 1: Remove the three 10mm bolts on the OE housing (1).

Step 2: Unplug the MAF sensor and unclip the wire harness from the OE intake tube (2).

Step 3: Remove the crank case hose from the OE tube (3).

Step 4: Loosen the clamp off the throttle body and cabin sound chamber tube, then remove the OE intake system out of the vehicle (4).

Step 5: Remove the five 10mm bolts and two push clips on the front bumper rail (5)



Figure B

Refer to Figure B for step 6

Step 6: Remove the three push clips on the driver side inside fender well (6) connecting to the bumper, and also the one by the amber light (7).



Figure C

Refer to Figure C for step 7

Step 7: With a flat head screwdriver push on the bottom side of the amber and pry out. Pop out the bottom side, then remove the rest of the amber light.



Refer to Figure D for steps 8-9

Step 8: Gently pull the right side of the bumper to gain access to the OE scoop.

Step 9: Remove the OE scoop off the vehicle by removing the two 10mm bolts (8) and install bumper back on.

INSTALL



Figure F

Figure E

Refer to Figure E & F for steps 10-13

Step 10: Remove two of the OE grommets off the OE housing that you removed in step one and install them on the Takeda housing (Refer to top right photo).

Step 11: Install the large hose clamp onto the housing and air filter as shown (Refer to top right photo).

Step 12: Install the Takeda Housing into the vehicle using the OE hardware (9) .

Step 13: Place the silicone coupling onto the throttle body with the supplied clamps (10) .

INSTALL

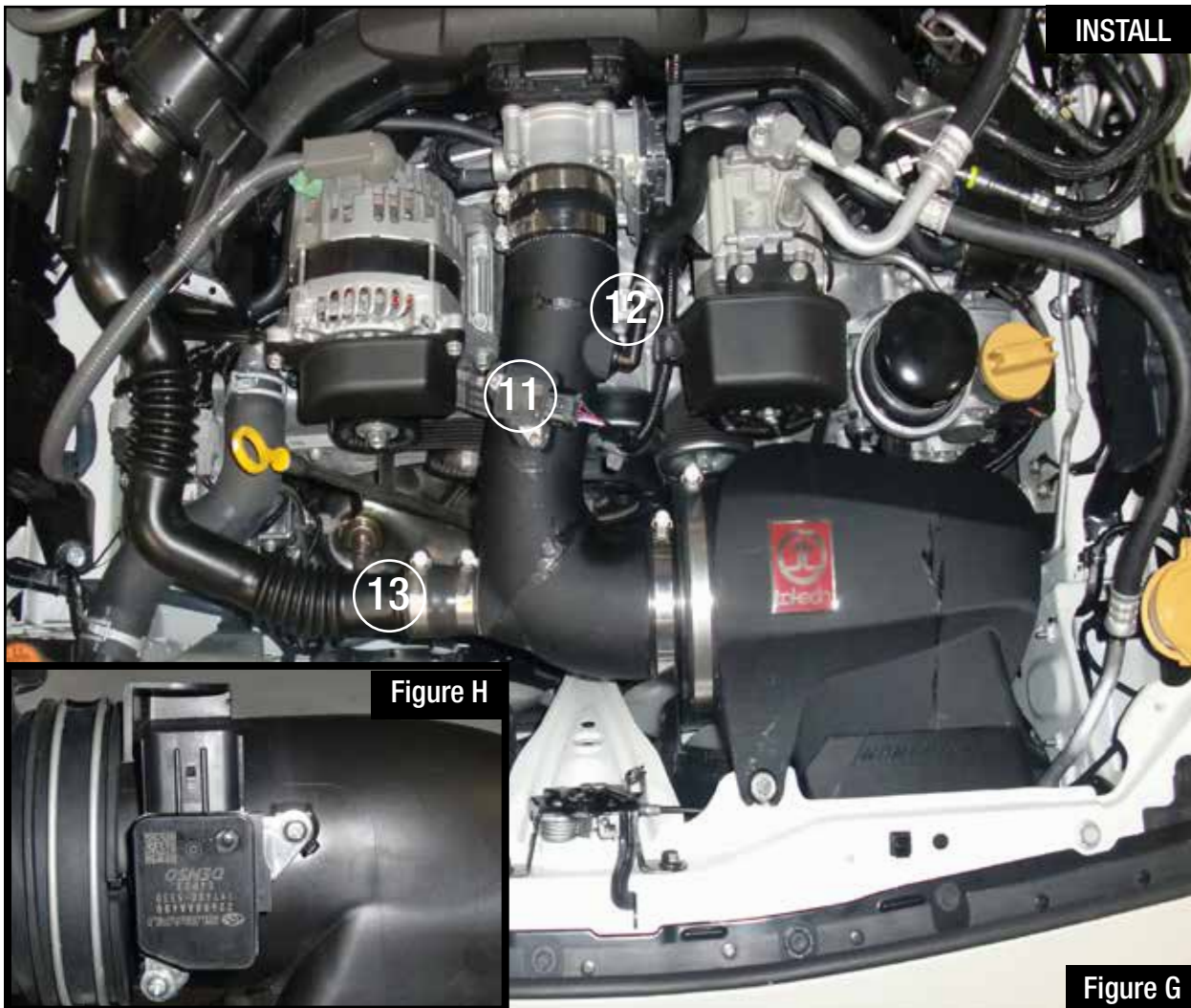

Figure H

Figure G

Refer to Figure G & H for steps 14-18

(If you would like to use the sound chamber, Drill out the intake tube as shown in Figure G)

Step 14: Install your Takeda intake tube into the vehicle.

Step 15: Remove the MAF sensor off the OE air box and install onto the Takeda tube with the supplied hardware (11).

Step 16: Install the supplied rubber grommet onto the intake tube (12) and reinstall your factory crank case vent line.

Step 17: Attach the sound chamber to the intake tube using the supplied coupling and clamps (13).

Step 18: Reconnect battery, your installation is now complete!

NOTE: Place enclosed CARB EO sticker on or near the device on a smooth, clean surface.

EO identification label is required to pass the smog inspection.





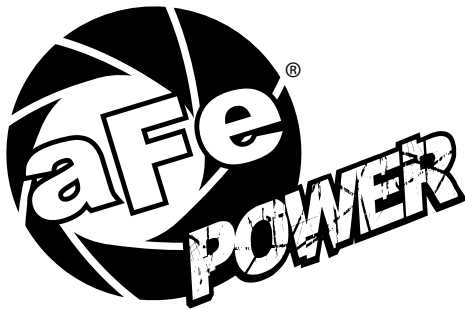

advanced FLOW engineering, inc.
252 Granite Street Corona, CA 92879