

**advanced FLOW engineering** Momentum Cold Air Intake System

**Instruction Manual** P/N: 56-70038D / 56-70038R

Make: KIA

Model: **Stinger**

Year: **2018-22**

Engine: **V6-3.3L(tt)**

Make: **Genesis**

Model: **G70**

Year: **2019-22**

Engine: **V6-3.3L(tt)**



- Please read the entire instruction manual before proceeding.
- Ensure all components listed are present.
- If you are missing any of the components, call customer support at 951-493-7185.
- Ensure you have all necessary tools before proceeding.
- Do not attempt to work on your vehicle when the engine is hot.
- Retain factory parts for future use.

Label	Qty.	Description	Part Number
A1	2	Air Filter (Pro 5R) for 56-70038R	TF-9029R
A2	2	Air Filter (Pro DRY S) for 56-70038D	TF-9029D
B	1	Tube, Driver Side	05-5670038B1
C	1	Tube, Passenger Side	05-5670038B2
D	1	Housing, Driver Side	05-5670038B3
E	1	Housing, Passenger Side	05-5670038B4
F	2	Clamp, #052	03-50008
G	2	Clamp, #032	03-50016
H	1	Fitting, 11mm Barb to 1/8 NPT	03-50615
I	1	Silicone Breather Hose, 1" (8" Length)	05-01724
J	1	Silicone Breather Hose, 1" (6" Length)	05-01724
K	1	Silicone Breather Hose, 3/8" (18" Length)	05-01503
L	1	Coupling, Driver Side	05-01709
M	1	Coupling, Passenger Side	05-01706
N	2	Plug, 2.25"	05-01527
O	4	Clamps, Mini #016	03-50091
P	2	Clamp, Mini #010	03-50078

**Installation will require the following tools:**

8mm nut driver, 1/4" nut driver, small flat-head screwdriver, pliers, 10mm socket, 14mm socket, extension, and socket, 10mm wrench.

Warranty Information available at: <https://afepower.com/contact#warranty>

**Emissions Disclaimer:** This product is not currently CARB exempt and is not available for purchase in California or for use on any vehicle registered with the California Department of Motor Vehicles.

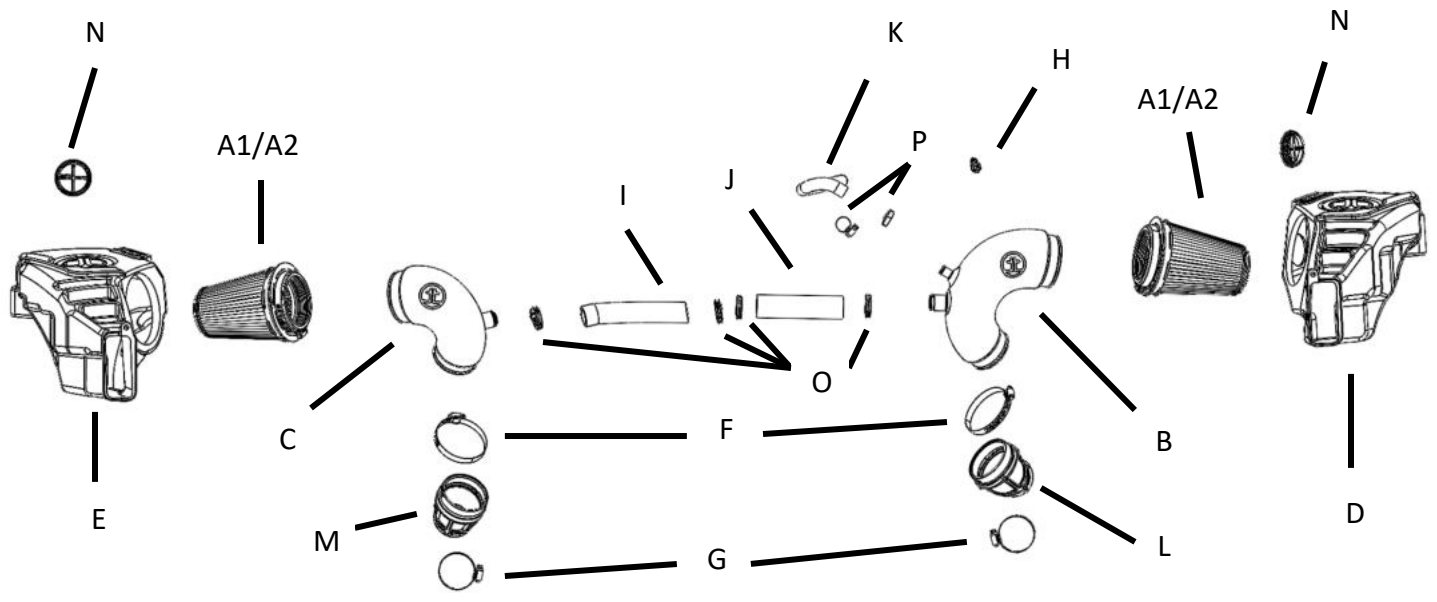



**Refer to Figure A for Step 1**

Step 1: Remove the strut bars using a 14mm wrench or socket.

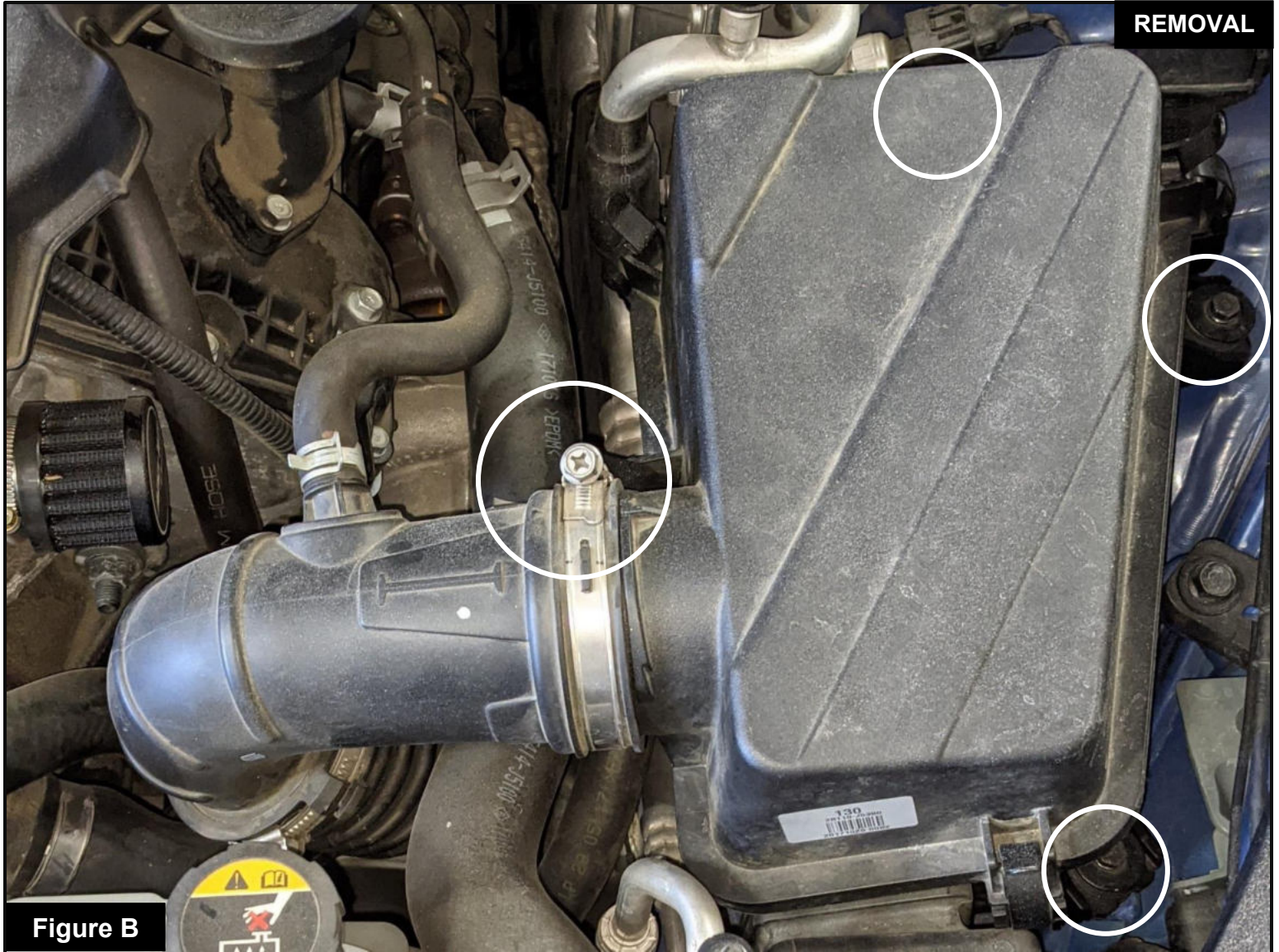

### **Refer to Figure B for Steps 2-6**

Step 2: Loosen the driver-side factory tube from the factory filter housing with a 10mm socket.

Step 3: Disconnect the factory tube from the factory housing

Step 4: Remove the 3 factory airbox mounting screws with a 10mm socket and extension. Put these aside, they will be used later.

Step 5: Remove the driver-side factory filter housing from the vehicle.

Step 6: Repeat Steps 2 through 5 for the passenger-side housing.

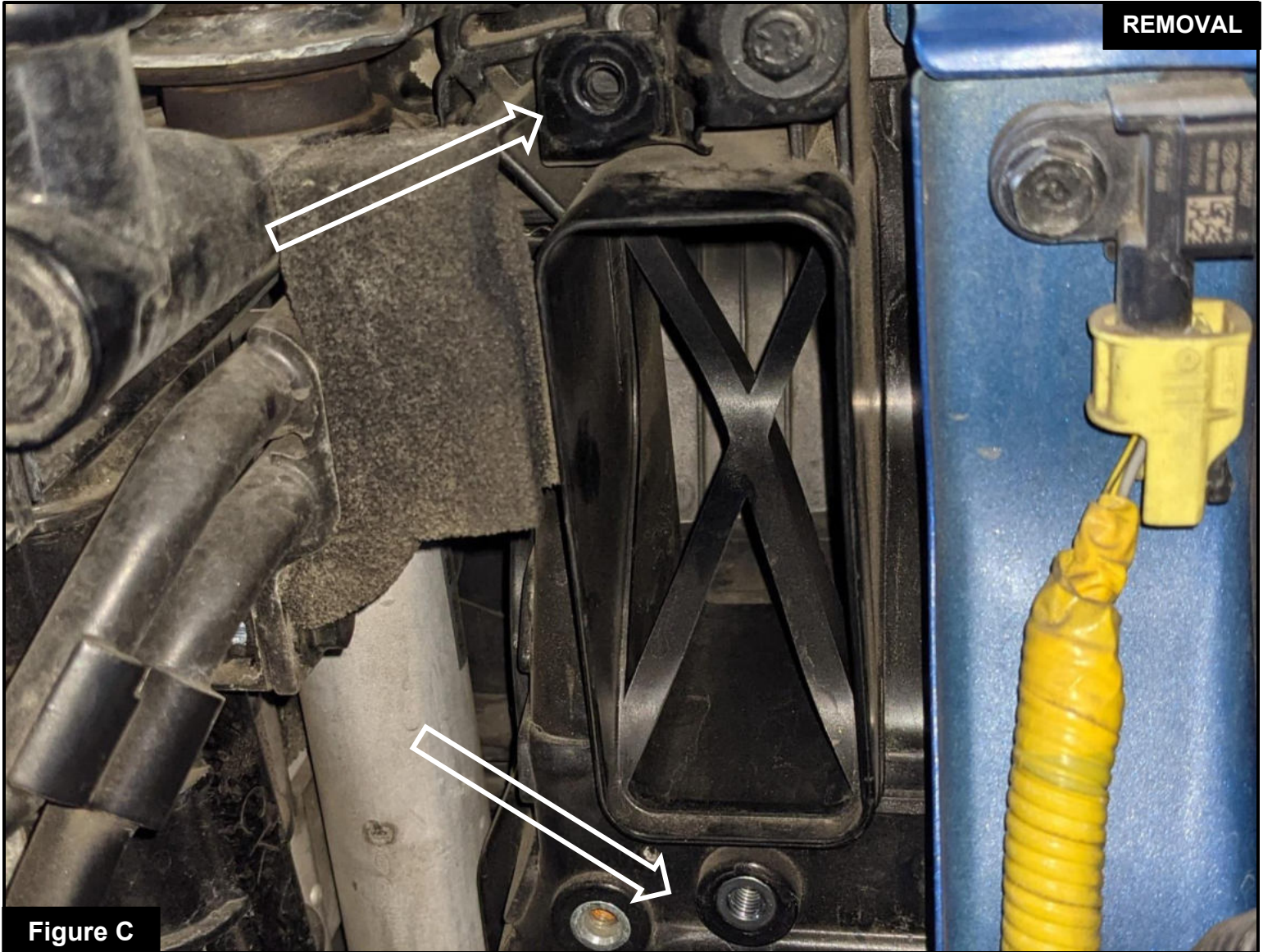

**Figure C**

**Refer to Figure C for Steps 7-8**

Step 7: Remove the driver-side factory air inlet with a 10mm socket and ratchet. There are 2 screws holding it in place.

Step 8: Repeat Step 7 for the passenger-side. Put these screws aside, two of them will be used later.



Figure D

**Refer to Figure D for Step 9**

Step 9: Using pliers on the pinch clamp, disconnect the breather line (indicated) from the factory driver-side intake tube.

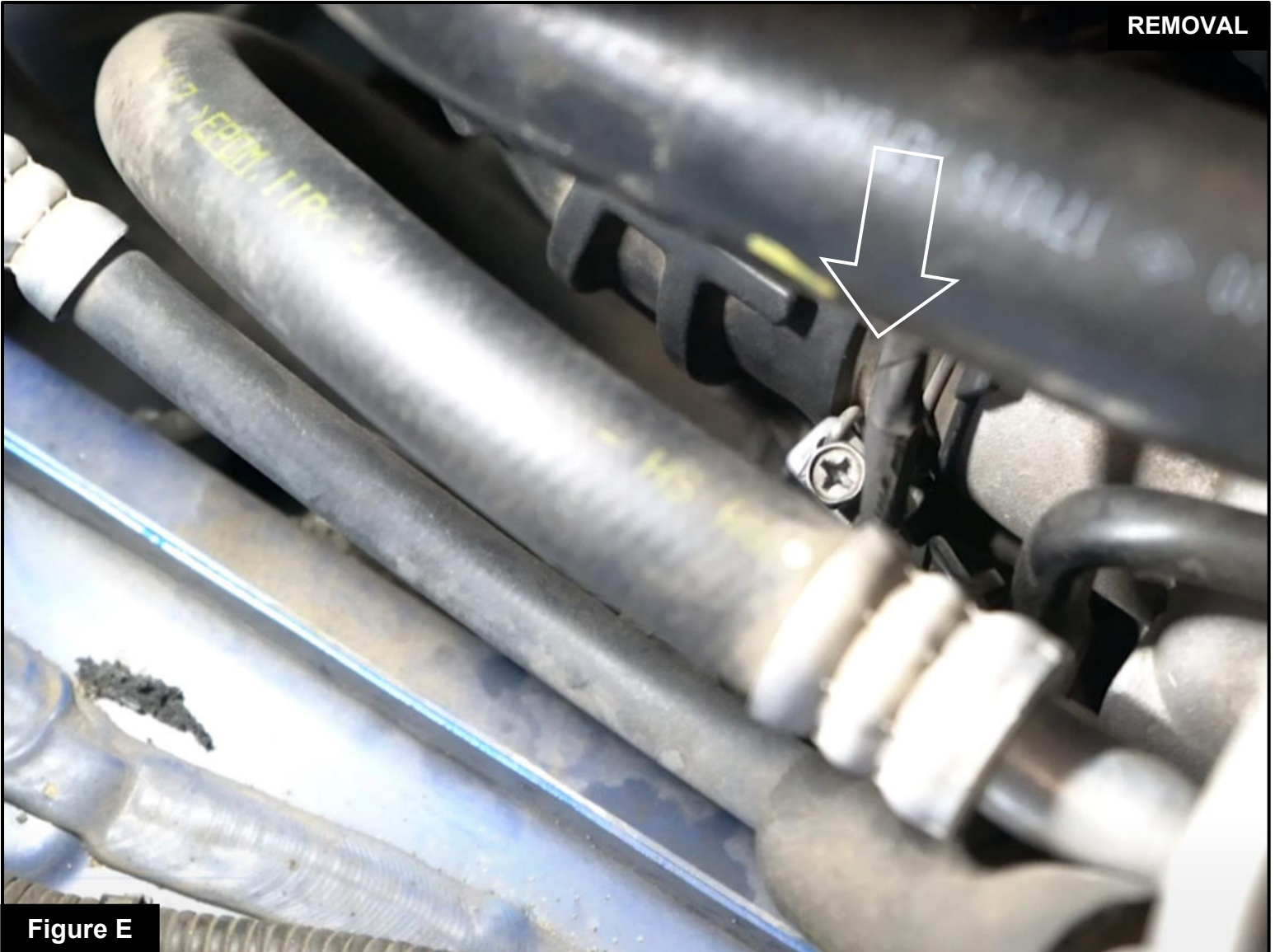
**Figure E****Refer to Figure E for Steps 10-12**

Step 10: Using a 10mm socket, loosen the driver side factory tube from the turbo inlet.

Step 11: Disconnect the tube from the turbo.

Step 12: Repeat Steps 10 and 11 on the passenger-side tube.

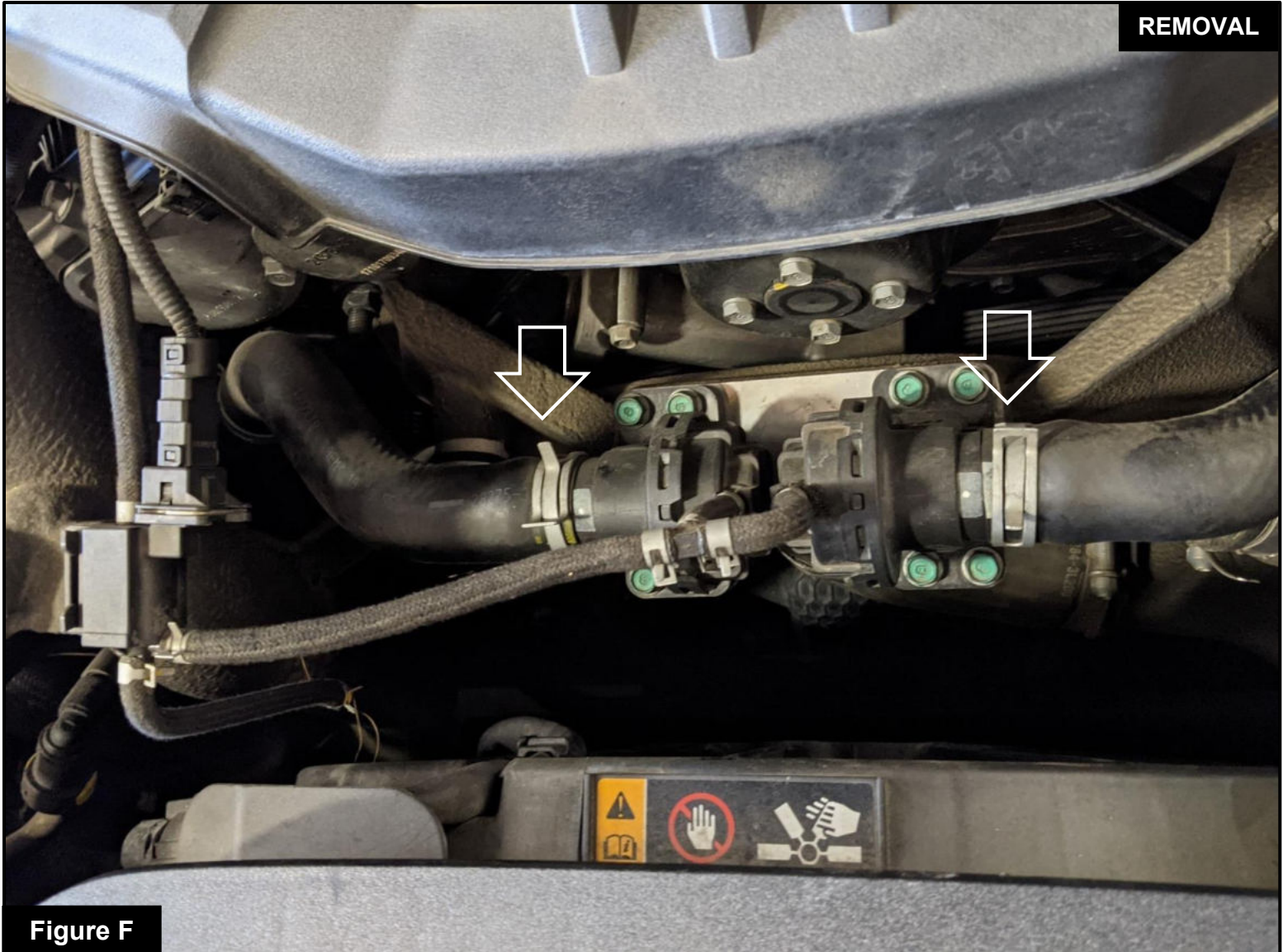

Figure F

**Refer to Figure F for Step 13**

Step 13: Using pliers on the pinch clamps, disconnect the 1" breather tubes from the factory blow-off valves in the center of the engine bay.

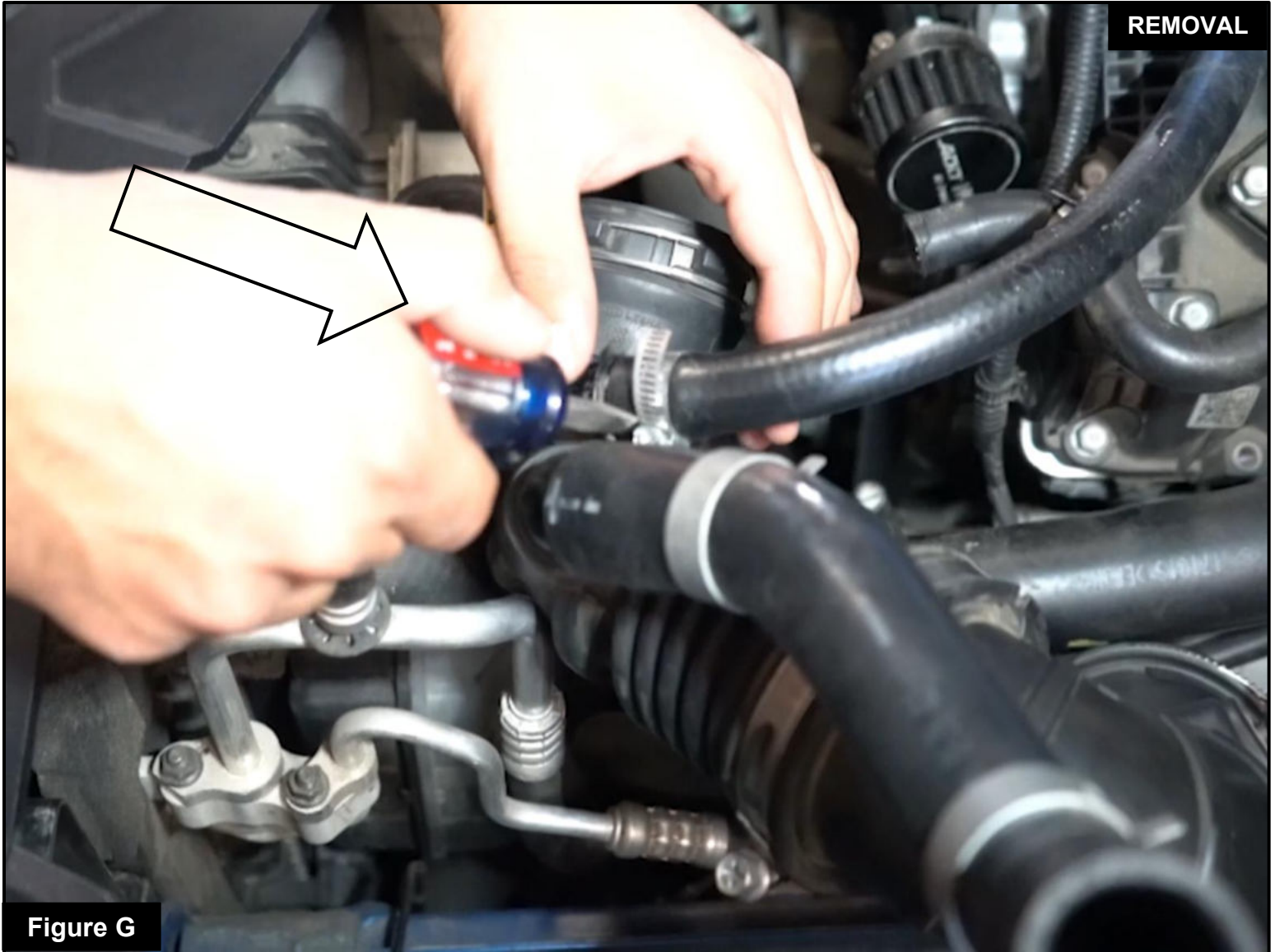

Figure G

**Refer to Figure G for Step 14**

Step 14: With the driver-side tube disconnected, and the blow-off valve disconnected, the valve cover breather line will be easier to work on. Remove the clamp that connects the factory breather line to the factory tube.



Figure H

**Refer to Figure H for Step 15**

Step 15: Remove the engine cover by pulling up on it, gently but firmly.



Figure I

**Refer to Figure I for Step 16**

Step 16: Using pliers, remove the indicated breather line from the valve cover. It will be secured by a pinch clamp.

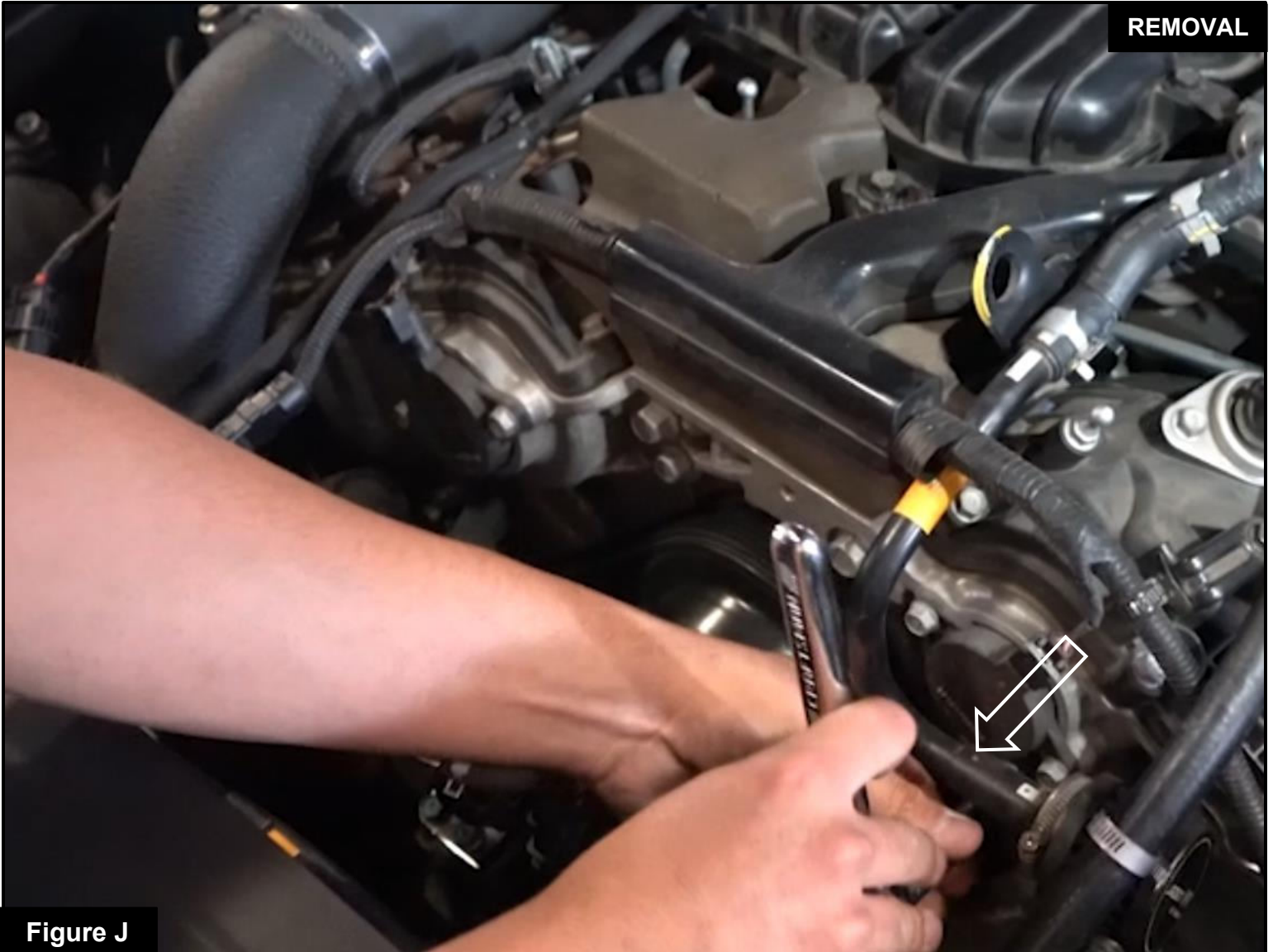
**Figure J****Refer to Figure J for Step 17**

Step 17: Using a 10mm socket, remove the breather line bracket. There will be 2 screws holding it on.

**Figure K****Refer to Figure K for Step 18**

Step 18: Transfer one of the pinch clamps from the breather line removed in Steps 16 and 17, and transfer it to the provided 3/8" silicone breather line. (One of the #010 Miniclamps can also be used instead of the pinch clamp)

**Figure L****Refer to Figure L for Steps 19 and 20**

Step 19: Transfer two of the factory mounting grommets from the driver-side factory housing to the TAKEDA driver-side housing as shown.

Step 20: Repeat Step 19 for the passenger-side.

**Figure M****Refer to Figure M for Steps 21 and 22**

Step 21: Install the driver side TAKEDA housing into the vehicle.

Step 22: Repeat Step 21 for the passenger-side.



**Figure N**

**Refer to Figure N for Steps 23 and 24**

Step 23: Using one of the screws removed in Step 7, line up the TAKEDA mount with the factory inlet mount. Do not fully tighten yet.

Step 24: Repeat Step 23 for the passenger-side.



**Figure O**

**Refer to Figure O for Steps 25-27**

Step 25: Using two of the mounting screws removed in Step 4, mount the TAKEDA housing to the vehicle from the inside of the housing, using a 10mm socket or wrench.

Step 26: Repeat Step 25 on the passenger-side.

Step 27: Tighten down all screws from Steps 23 through 26 on both the driver and passenger-side TAKEDA housings.

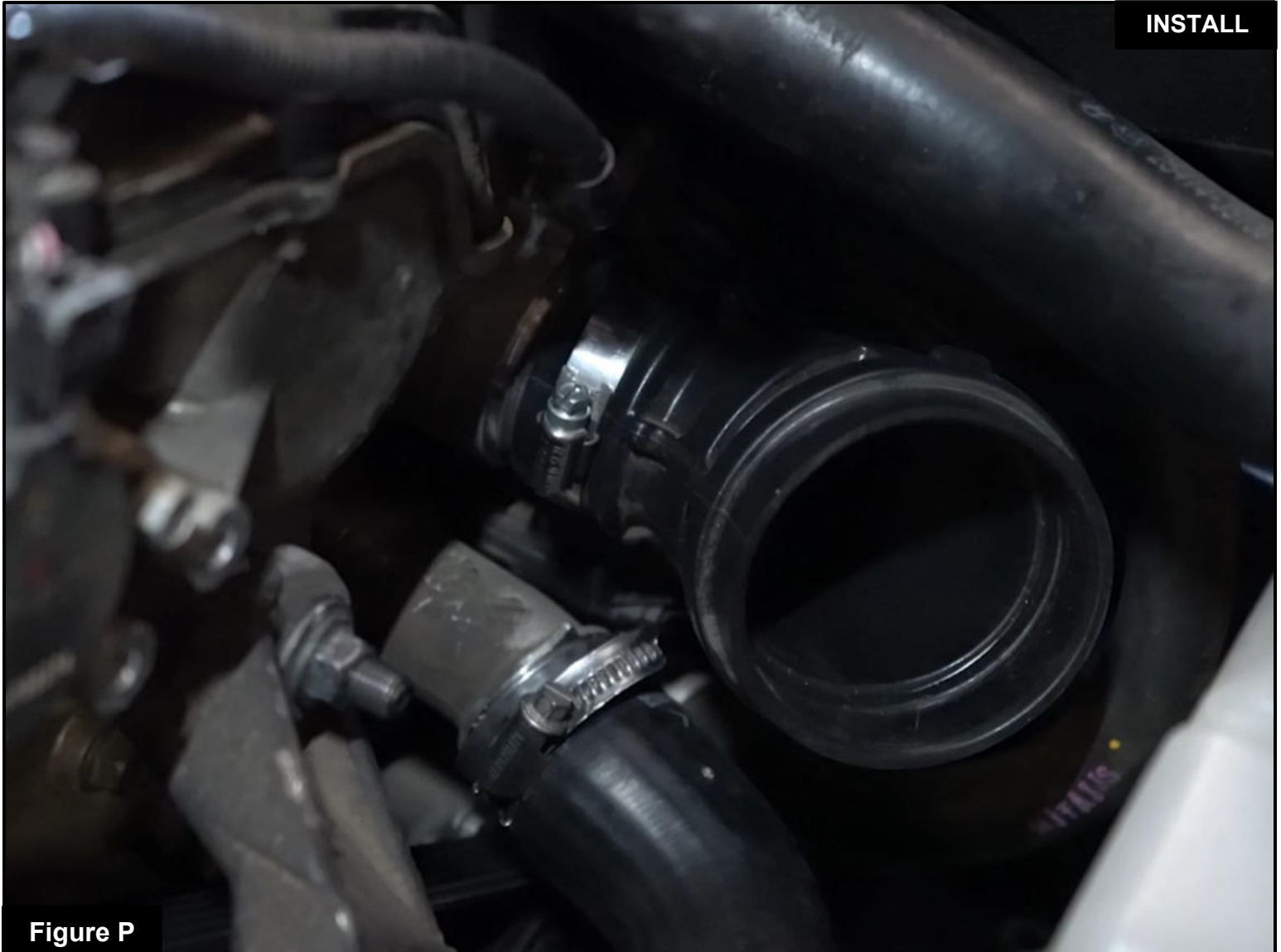

Figure P

**Refer to Figure P for Steps 28-30**

Step 28: Install one of the #032 clamps over the small end of the driver side TAKEDA coupling.

Step 29: Slip the small end of the coupling over the turbo inlet. Orient the coupling and #032 clamp as shown.

Step 30: Repeat Steps 28 and 29 for the passenger-side.

**Figure Q****Refer to Figure Q for Steps 31 and 32**

Step 31: Slip one of the #052 worm clamps over the larger end of the driver side coupling. Orient as shown.

Step 32: Repeat Step 31 for the passenger-side.



**Figure R**

**Refer to Figure R for Step 33**

Step 33: Insert the filters into the TAKEDA housings by firmly pushing it into the housing until the filter tabs lock it into place. Slip the worm clamps over the filter flange, but do not tighten at this time.

**Figure S****Refer to Figure S for Step 34**

Step 34: Install the barb fitting onto the driver-side TAKEDA tube using a 16mm wrench or deep socket. **DO NOT OVER TIGHTEN. THIS IS A NPT FITTING, A SMALL GAP IS NORMAL.**

**Figure T****Refer to Figure T for Steps 35-37**

Step 35: Install the TAKEDA driver-side tube. Make sure the TAKEDA tube, filter and coupling all line up with each other.

Step 36: Tighten the turbo inlet clamp, followed by the clamp over the other end of the coupling. Lastly, tighten the filter clamp.

Step 37: Repeat Step 35 and 36 for the passenger-side.

**Figure U****Refer to Figure U for Steps 38-40**

Step 38: Install the shorter length of 1" silicone breather hose between the driver-side blow-off valve and TAKEDA tube.

Step 39: Using 2 of the #016 Mini Clamps, clamp down the 1" silicone breather hose securely.

Step 40: Repeat Steps 38 and 39 for the passenger-side, using the other section of 1" silicone breather hose.

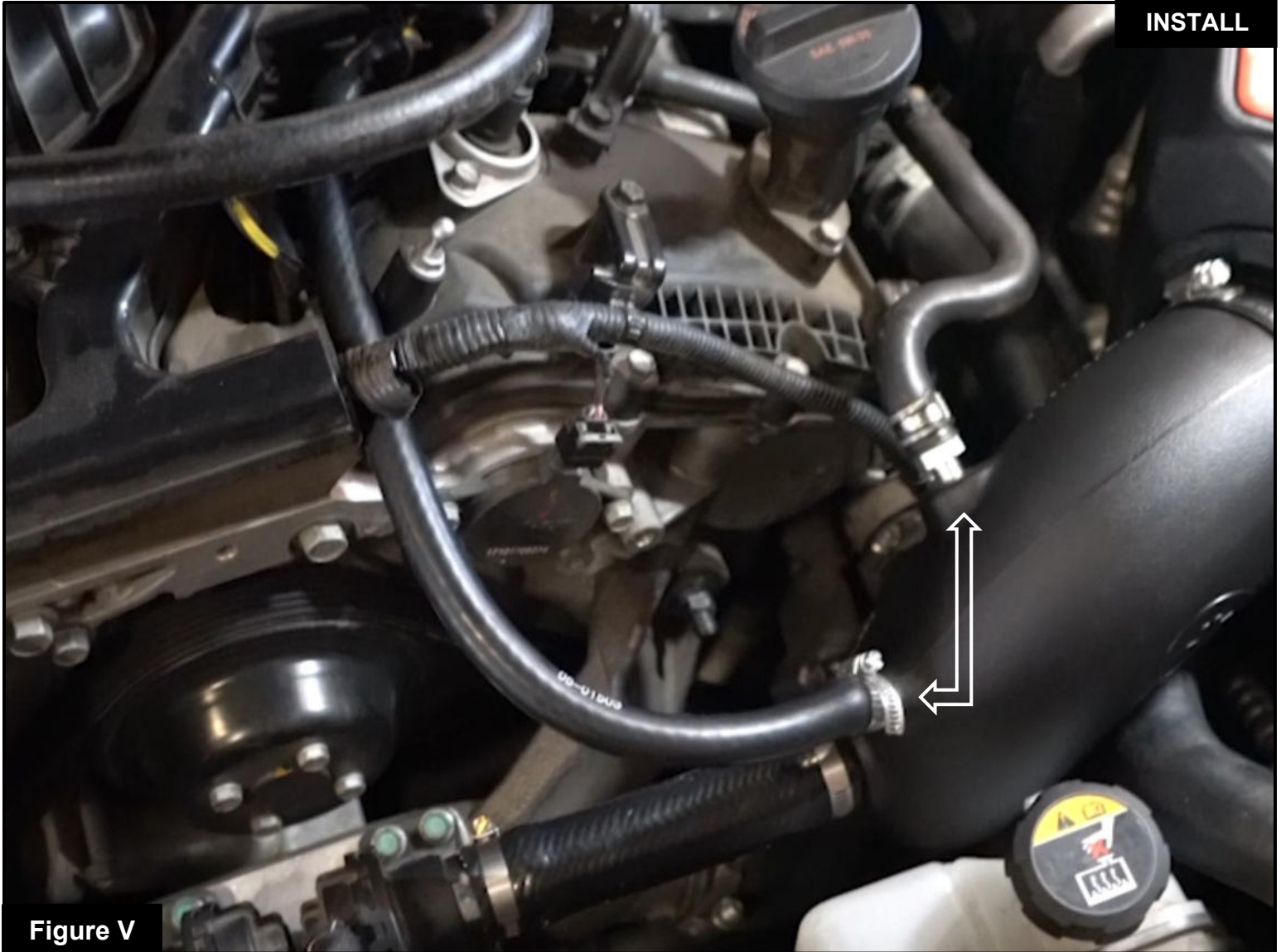
**Figure V****Refer to Figure V for Steps 41 and 42**

Step 41: Using the 3/8" silicone breather line, slip it over the barb on the tube next to the 1" silicone breather line on the TAKEDA tube. Secure with a #010 Mini clamp.

Step 42: Connect the last breather line to the aluminum fitting on the TAKEDA tube. Secure with the factory pinch clamp.

**Figure W****Refer to Figure W for Step 43**

Step 43: Slip the other end of the 3/8" silicone hose over the valve cover barb connection that was disconnected in Step 16. Secure with the factory pinch clamp or mini clamp from Step 18.

**Figure X**

### **Refer to Figure X for Step 44**

Step 44: The kit includes optional plugs (one for each TAKEDA housing) to close off the auxillary air inlets.

Install the plugs if you wish to close off the auxillary air inlets and only capture cold air from the front.

- Without the plugs installed, the TAKEDA intake will capture the maximum air available. More airflow offers more power. Yet some of this air is picked up from inside the engine compartment and could be warmer air. Warmer air will affect the performance of the vehicle.
- The plug installed on the housing will block off any hot engine air entering the housing and make sure the coolest air available is directed into the engine. It will also reduce the noise of the intake.



**Figure Y**

**Refer to Figure Y for Steps 45 and 46**

Step 45: Reinstall the engine cover.

Step 46: Reinstall the strut bars.

**Your installation is complete! Thank you for choosing Takeda!**

**NOTE: Check all screws, clamps, and connectors are secure after 100-200 miles.**



**Page left blank intentionally**



**Page left blank intentionally**



**Page left blank intentionally.**



***advanced FLOW engineering, inc.***

252 Granite Street Corona, CA 92879

<https://afepower.com/contact>